

KRIPSOL® 2018



EQUIPMENT FOR
RESIDENTIAL POOLS

PUMPS | FILTERS | WHITE GOODS
POOL SURROUNDING EQUIPMENT | CLEANERS | HEATING
SANITIZATION | PVC ACCESSORIES

PRESENTATION

On behalf of the Hayward® Ibérica team, we have the honour of presenting the Kripsol® 2018 catalogue of equipment for residential swimming pools, originating from the fusion of three market leaders.

Following the integration of Kripsol® Group and Sugar Valley® into the Hayward® Group organisation, our range of products is now more comprehensive, more up-to-date, and much more high-tech.

The process has taken almost two years to complete, during which time we have identified the best aspects of each company, and spent time thinking about how to make improvements and better meet the needs of our customers. Innovation has been one of our guiding principles throughout this process.

As a result, this catalogue contains products manufactured by us, which are designed to provide a reactive response to the increasingly discerning requirements of our customers. In particular, those requirements pertaining to residential pools.

This season we would like to highlight the release of the KLX Control System range onto the market, which allows pH, Redox, filtering and lighting to be controlled automatically. And adjusted using a mobile phone.

As well as the variable speed pumps KSX Pro and KS Evo 150 VS, that continue to hold pride of place amongst our high-flyers for this year. And in addition to our wide range of domestic pool filters. All these products have been improved and are manufactured in Europe, guaranteeing good quality and great service, close to our clients.

But Kripsol, as a major brand within the Hayward group®, is not content to stop at this, and would like to continue advancing in all areas that will shape the pools of the future. A pool with a highly efficient system in terms of energy and water consumption, but also integrating home automation to a greater extent. And we are going to continue working on this aspect.

Allow me to take this opportunity to thank you for your loyalty over the last 30 years and to remind you that we look forward to seeing you all at the Piscine Global Europe trade fair in Lyon in November this year.

TOGETHER we will continue to develop...

Jon López

General Manager of Hayward® Europe

PUMPS 06-23

FILTERS 24-37

WHITE GOODS 38-51

**POOL SURROUNDING
EQUIPMENT** 52-67

CLEANERS 68-71

HEATING 72-77

WATER TREATMENT 78-85

PVC ACCESSORIES 86-91

**GENERAL
CONDITIONS OF SALE** 92

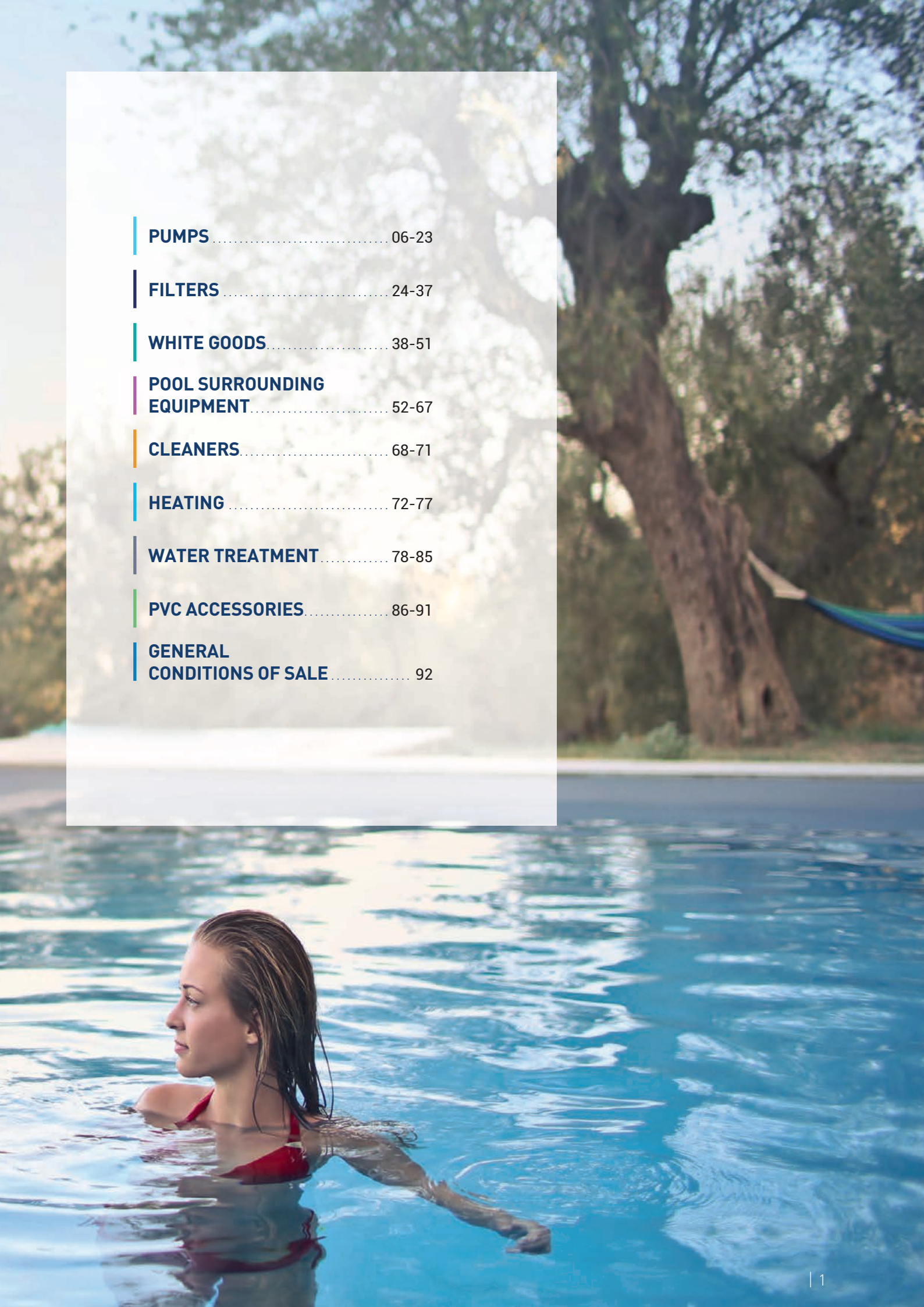

KRIPSOL, PART OF HAYWARD, A GLOBAL GROUP

ALWAYS CLOSER TO YOU IN EUROPE

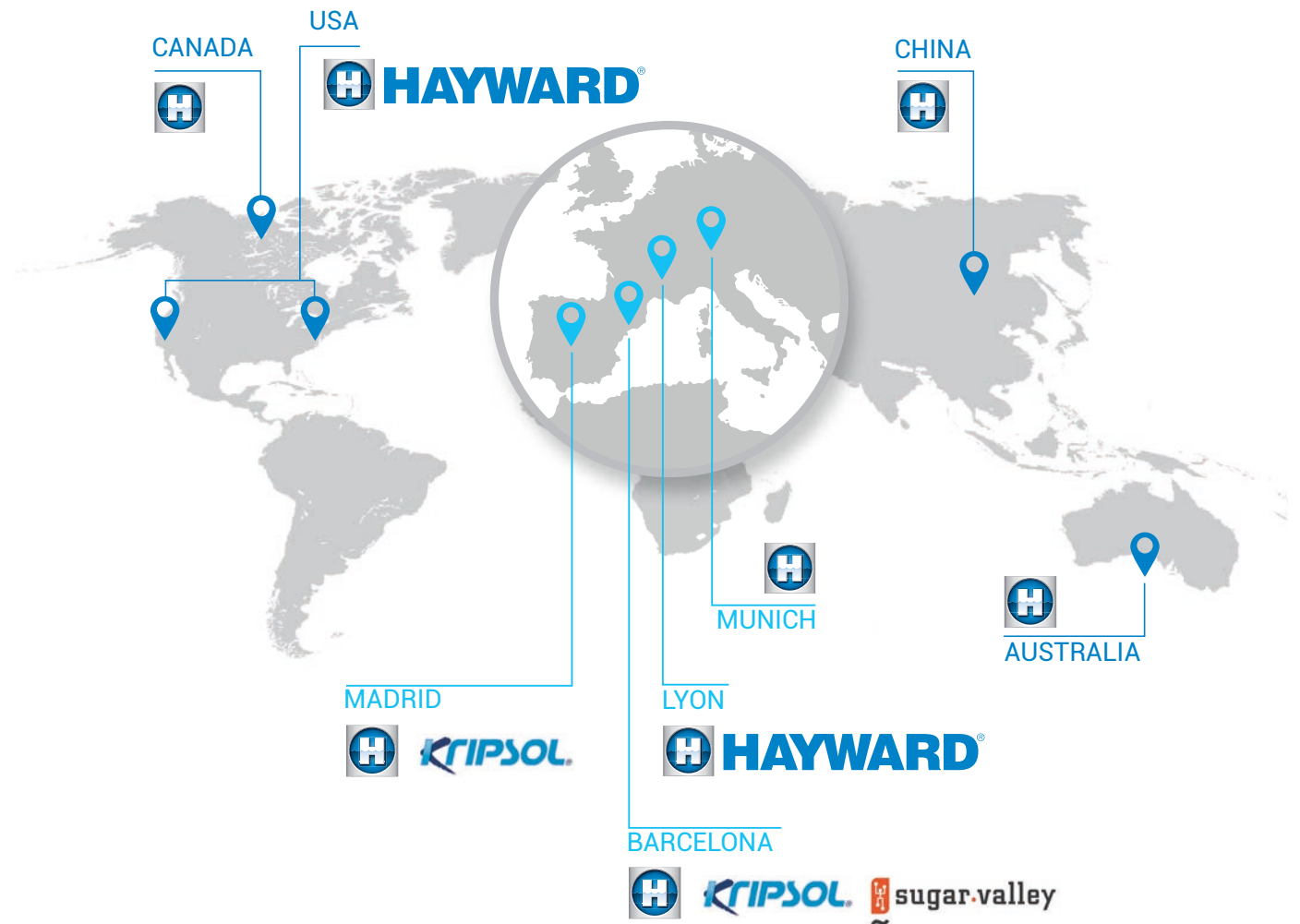

KRIPSOL , THE RESIDENTIAL POOL SPECIALIST IS A BRAND OF HAYWARD®

A GLOBAL OFFER

We provide all the equipment you need for your pool: filtering system, white goods, sanitization, cleaning systems and equipment for your comfort to give you the best swimming experience possible.

MANUFACTURED IN EUROPE

Robust and efficient design, for a simple and reliable user experience and a problem-free lifespan.

SERVICE CLOSE TO OUR CLIENTS

A representative from our distribution network or from the after-sales service will always be available to provide advice and assistance.

PRO
LINE

PRO LINE

Product range for professionals. Take your pool to the next level



PUMPS



FILTERS



CLEANERS



HEATING

CLASSIC
LINE

CLASSIC LINE

More than 30 years of experience with proven product performance and reliability. The best possible value for money for your pool equipment.



PUMPS



FILTERS



NEW KRIPSOL PRODUCTS®

KLX

Kripsol KLX Control System: water treatment and pool management accessible to all.

Not just a water treatment system, the KLX can control pool operations such as filters or lighting, thanks to its peripheral connections.



- Models with chlorine production from 8 g to 50 g
- Compact management unit, graphics display with clear information
- IP65, suitable for underground technical equipment boxes
- Flexible configuration thanks to the optional kits:
 - pH with dosing pump
 - Rx
 - WiFi + smartphone App
 - Temperature
 - Speed control for KSX Pro VS/ KS Evo VS pumps
 - 3-year warranty and 5000 hours for the cell



KSX Pro 150 VS - KS Evo VS

New generation of variable speed pumps now available. High levels of efficiency in each application, optimised consumption Super-silent operation



- 3 pre-set speeds, 5 daily programmes
- Connectivity: remote management using the KLX chlorinator

The perfect partner for the KLX chlorinator: manage the speed of the filter pump from your smartphone.



- Management module with capacity for up to 5 daily programmes
- Automatic skimming function for cleaning the surface every 1, 2 or 3 hours
- Timer.

Artik Evo Series

THE PROFESSIONAL SOLUTION FOR RESIDENTIAL POOLS

Laminated filter reinforced with fibreglass for residential pools up to 189 m³



- Twist-lock cover, rapid access (no tools required)
- Pro line glycerine-filled pressure gauge
- Optimal distribution of water over the bed, thanks to the Dual-Side diffuser
- Wide double drain (water/sand), easy maintenance no tools required for opening
- 5-year warranty for the tank



Komfort by Kripsol

IMPROVE YOUR SWIMMING EXPERIENCE WITH KOMFORT BY KRIPSOL



- Robust and efficient
- Reversible (heating/cooling)
- Operates at temperatures down to -2 °C
- Winter cover included
- WiFi module included for all products in the range



Range with remote management thanks to the Smart Temp® Wifi module



PUMPS

THE BEST PRODUCTS FOR SILENT POOL OPERATIONS

It is entirely true to say that today, the KS pump continues to be the pump with the best performance and least noise impact. We propose two classic models of these pumps, Evo and Pro, each one with their own advantages. All our pumps have been designed to function in combination with Kripsol filters in optimal operation.

Our range also includes variable speed KS pumps, which provide you with total connectivity via the KLX Control System, and then the Ninfa and Ondina series for smaller pools.

This section also includes blowers, electronic and electrical control panels, and accessories.

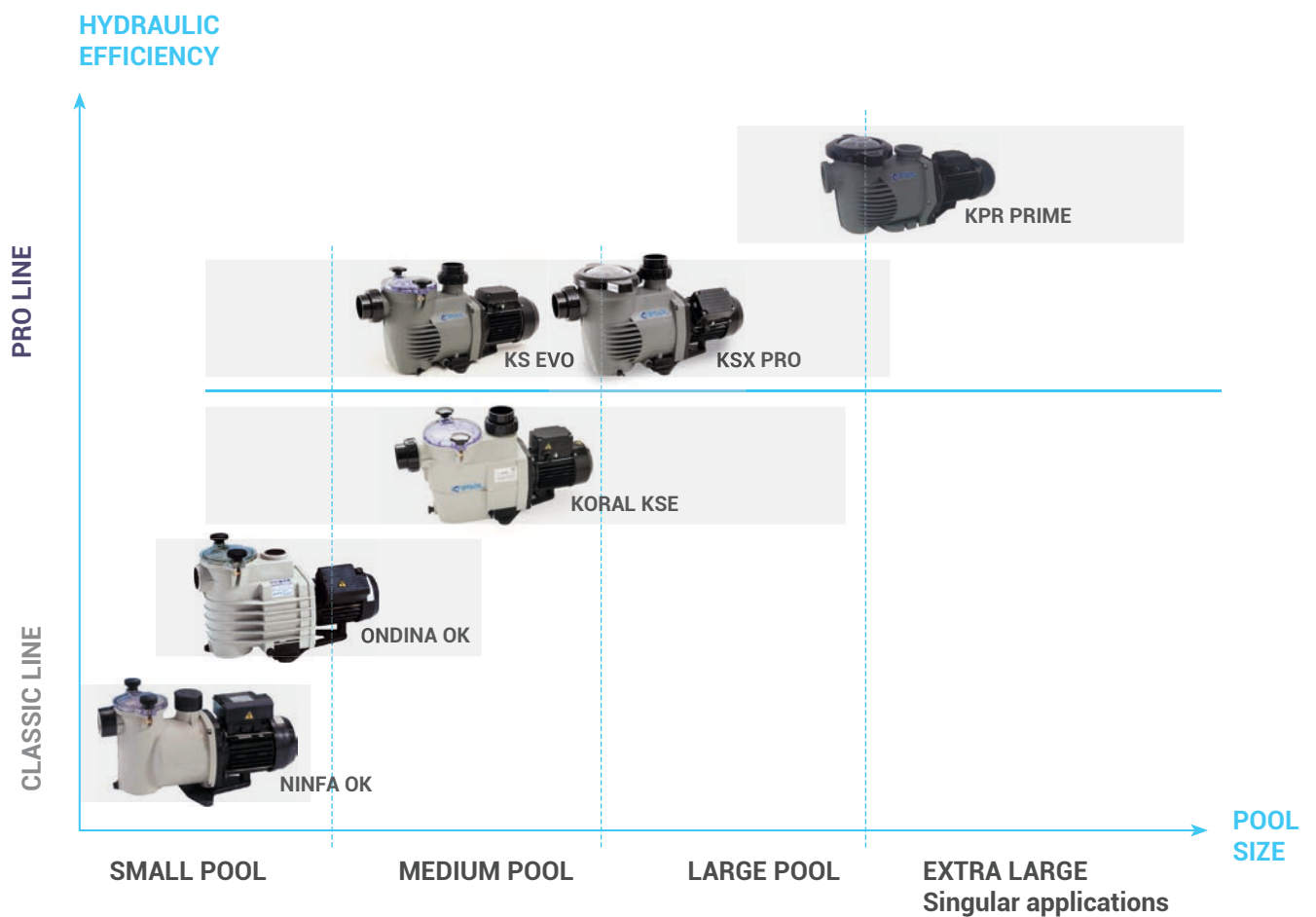

PUMPS

PRIME-KPR	p.08
KSX PRO.....	p.10
KSX PRO VS	p.11
KS EVO	p.12
KS EVO VS	p.13
KORAL-KSE.....	p.15
ONDINA-OK.....	p.16
NINFA-NK	p.17
NIGER-KNG.....	p.18
KARPA -KA.....	p.19
BLOWERS	p.20
CONTROL PANELS.....	p.21

PRIME-KPR

PRO LINE

YEAR OF GUARANTEES 2

POWERFUL AND VERSATILE

- » Large residential pools or small public pools, aqua therapy jets, water features
- » The transparent cover with a rapid twist-lock cover provides a view into the interior of the prefilter and provides easy access
- » Robust, corrosion-resistant design. Suitable for use in salt water thanks to the AISI 316 mechanical seal
- » Includes slip union fittings \varnothing 75 mm
- » Up to 26 mWC
- » **Usage: for residential pools up to 270 m³**



Code	Ref.	P2 hp	P1 kW	A (mm)	Flow rate (m ³ /h)	Weight (kg)	Pack. (mm)	qty/pallet	C.S.U.
011021320510	KPR250 M	2.50	2.4	669	30	24	285 x 285 x 720	20	1
011021350510	KPR250 T1	2.50	2.4	669	30	24	285 x 285 x 720	20	1
011031420510	KPR300 M	3.00	2.8	669	36	26	285 x 285 x 720	20	1
011021450510	KPR300 T1	3.00	2.8	669	36	24	285 x 285 x 720	20	1
011031550510	KPR350 T1	3.50	3.8	710	45	27	285 x 285 x 720	20	1
011031359510	KPR250 T1 IE3	2.50	-	669	30	28.5	285 x 285 x 720	20	1
011031459510	KPR300 T1 IE3	3.00	-	669	36	28.5	285 x 285 x 720	20	1
011041029510	KPR350 T1 IE3	3.50	-	710	45	31.5	285 x 285 x 720	20	1

P1: Input Power

P2: Nominal Power

* 10 m water column pressure

60 Hz on request, ask for conditions; ANSI or JIS on request

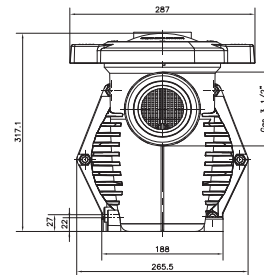
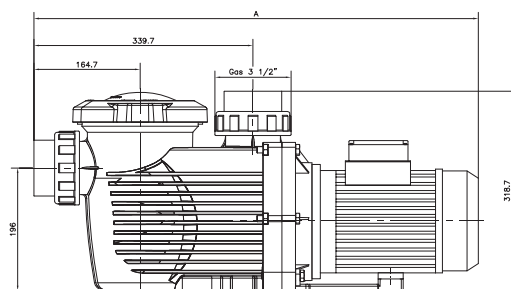

Technical Specifications

Max. water temp. / Max. pressure	50 °C/ 2.5 bar
Connection (DIN slip included, for others please ask)	\varnothing 75 - 2 1/2"
Mechanical seal	AISI 316, suitable for salt water
Motor specifications	Class F, IP55, 50 Hz, 2850 rpm
Housing/impeller/strainer/lid	PP with F.G., Noryl, PP, SAN

Water column pressure (m)

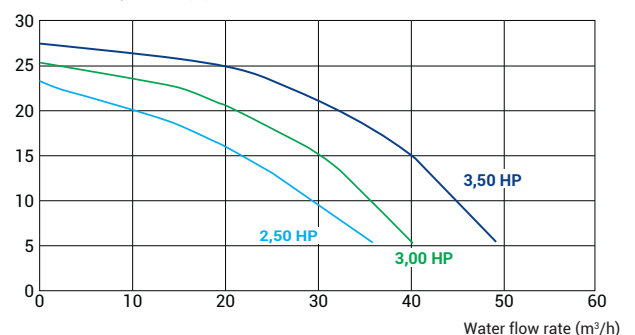



KSX PRO

PRO LINE

YEAR OF GUARANTEES 2+1@



THE PROFESSIONAL SOLUTION FOR RESIDENTIAL POOLS

- » High-performance optimised hydraulic system with silent operation
- » Twist-lock cover, rapid access (no tools required)
- » Double drain with easy opening (no tools required)
- » Simple installation, direct substitutes for KS pumps, supplied with 50/63 mm unions
- » Impeller and diffuser made of Noryl, very hard-wearing and corrosion-resistant
- » Suitable for use in salt water, AISI 316 mechanical seal
- » **Usage: for residential pools up to 198 m³**



IE3 ✓

Code	Ref.	P2 hp	P1 kW	A (mm)	Flow rate (m ³ /h)	Weight (kg)	Pack. (mm)	qty/pallet	C.S.U.
012601225010	KSX Pro 33 M	0.33	0.45	543	4.8	11.2	330 x 255 x 650	25	1
012611320510	KSX Pro 50 M	0.50	0.58	590	7.5	12.5	330 x 255 x 650	25	1
012611350510	KSX Pro 50 T1	0.50	0.58	590	7.5	12.5	330 x 255 x 650	25	1
012611420510	KSX Pro 75 M	0.75	0.75	590	11.5	13.5	330 x 255 x 650	25	1
012611450510	KSX Pro 75 T1	0.75	0.75	590	11.5	13.5	330 x 255 x 650	25	1
012611520510	KSX Pro 100 M	1.00	1	590	15.4	14	330 x 255 x 650	25	1
012671050510	KSX Pro 100 T1 IE3	1.00	1	620	15.4	16.5	330 x 255 x 650	25	1
012621120520	KSX Pro 150 M	1.50	1.6	620	21.9	16.5	330 x 255 x 650	25	1
012671150510	KSX Pro 150 T1 IE3	1.50	1.6	620	21.9	19	330 x 255 x 650	25	1
012621220520	KSX Pro 200 M	2.00	1.92	620	25.7	22.5	330 x 255 x 650	25	1
012681250510	KSX Pro 200 T1 IE3	2.00	1.92	620	25.7	25	330 x 255 x 650	25	1
012681350520	KSX Pro 300 M	3.00	2.6	620	33	25	330 x 255 x 650	25	1
	KSX Pro 300 T1 IE3	3.00	2.6	620	33	27	330 x 255 x 650	25	1

IE3 ✓

IE3 ✓

IE3 ✓

IE3 ✓

P1: Input Power P2: Nominal Power * 10 m water column pressure 60 Hz on request, ask for conditions; ANSI or JIS on request

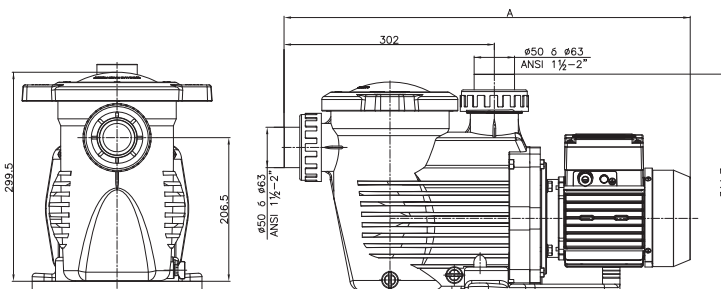

Technical Specifications

Max. water temp. / Max. pressure	50 °C / 2.5 bar
Connection	50 mm (0.33 - 1.00 hp) 63 mm (1.5 - 3 hp)
Mechanical seal	AISI 316, suitable for salt water
Motor specifications	Class F, IP55, 50 Hz, 2850 rpm
Housing/impeller/strainer/lid	PP + FG/Noryl® with FG/PP/SAN®

Water column pressure (m) KS Evo / KSX Pro Q (m³/h)-H (m)

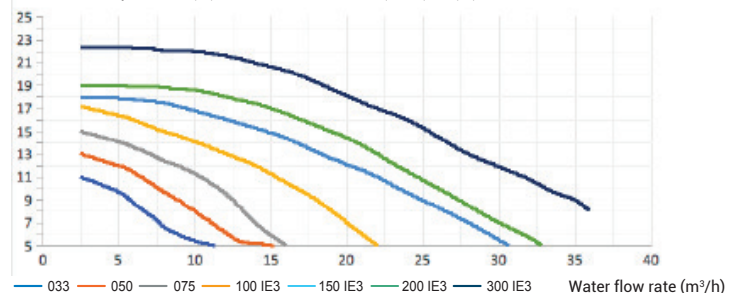

KSX PRO VS



THE PERFECT SPEED FOR EACH APPLICATION

- » Variable speed: high level of efficiency for each application, optimised consumption
- » 5 programmes, 3 preselected speeds
- » Super-silent operation
- » Twist-lock cover, rapid access (no tools required)
- » Double drain, easy opening (no tools required)
- » Simple installation, direct substitute for KS pumps, supplied with 50/63 mm unions
- » Impeller and diffuser made of Noryl, very hard-wearing and corrosion-resistant
- » Suitable for use in salt water, AISI 316 mechanical seal
- » Management module allowing up to five daily programmes
- » Automatic skimming function for cleaning the surface every 1, 2 or 3 hours
- » Timer
- » **Usage: for residential pools up to 126 m³**



Code	Ref.	P2 hp	P1 kW	A (mm)	Flow rate (m ³ /h)	Weight (kg)	Pack. (mm)	qty/pallet	C.S.U.
010926101520	KSX Pro VS	1.50	1.1	543	21	15	330 x 255 x 650	25	1

P1: Input Power P2: Nominal Power * 10 m water column pressure

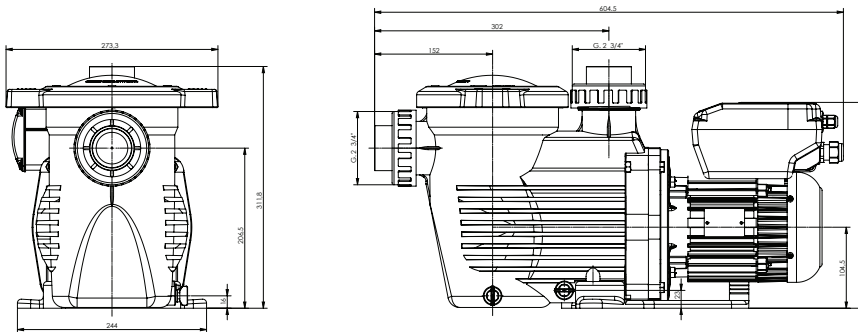

Technical Specifications

Max. water temp. / Max. pressure	50 °C / 2.5 bar
Connection (DIN slip included, for others please ask)	63 mm
Mechanical seal	AISI 316, suitable for salt water
Motor-drive specifications	Class F, IP55, 50 Hz, single phase
Housing/impeller/strainer/lid	PP/Noryl® with F.G./PP/SAN®

Water column pressure (m)

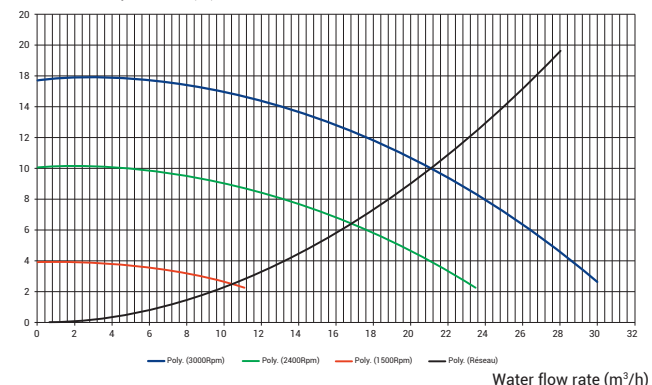

KS EVO

PRO LINE

YEAR OF GUARANTEES 2+1[@]

ROBUST, SILENT AND EFFICIENT

- » Easy maintenance: rapid access to the prefilter (no tools required)
- » Impeller and diffuser made of Noryl, very hard-wearing and corrosion-resistant.
- » Evolution of the KS: silent and efficient operation
- » Simple installation, direct substitute for KS pumps, supplied with 50/63 mm unions
- » Double drain, easy opening (no tools required)
- » Suitable for use in salt water. AISI316 Mechanical seal
- » **Usage: for residential pools up to 198 m³**



IE3 ✓

Code	Ref.	P2 hp	P1 kW	A (mm)	Flow rate (m ³ /h)	Weight (kg)	Pack. (mm)	qty/pallet	C.S.U.
012501225010	KS Evo 033DM	0.33	0.45	543	4.8	11.2	330 x 255 x 650	25	1
012511320510	KS Evo 050DM	0.50	0.58	590	7.5	12.5	330 x 255 x 650	25	1
012511350510	KS Evo 050DT1	0.50	0.58	590	7.5	12.5	330 x 255 x 650	25	1
012511420510	KS Evo 075DM	0.75	0.75	590	11.5	13.5	330 x 255 x 650	25	1
012511450510	KS Evo 075DT1	0.75	0.75	590	11.5	13.5	330 x 255 x 650	25	1
012511520510	KS Evo 100DM	1.00	1	590	15.4	14	330 x 255 x 650	25	1
012521120520	KS Evo 150DM	1.50	1.6	620	21.9	16.5	330 x 255 x 650	25	1
012521220520	KS Evo 200DM	2.00	1.92	620	25.7	22.5	330 x 255 x 650	25	1
012571050510	KS Evo 100DT1 IE3	1.00	1	620	15.4	16.5	330 x 255 x 650	25	1
012571150510	KS Evo 150DT1 IE3	1.50	1.6	620	21.9	19	330 x 255 x 650	25	1
012581250510	KS Evo 200DT1 IE3	2.00	1.92	620	25.7	25	330 x 255 x 650	25	1
012521420120	KS Evo 300 M	3.00	2.60	620	33	25	330 x 255 x 650	25	1
012581350520	KS Evo 300 T1 IE3	3.00	2.60	620	33	27	330 x 255 x 650	25	1

IE3 ✓

IE3 ✓

IE3 ✓

IE3 ✓

P1: Input Power

P2: Nominal Power

* 10 m water column pressure

60 Hz on request, ask for conditions; ANSI or JIS on request

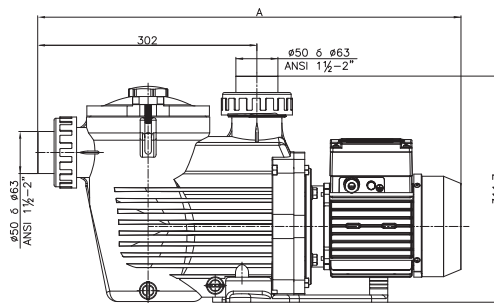
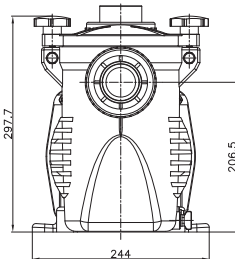

Technical Specifications

Max. water temp. / Max. pressure	50 °C/ 2.5 bar
Connection (DIN slip included, for others please ask)	Ø 50 mm (0.33 - 1 hp) Ø 63 mm (3 - hp)
Mechanical seal	AISI 316, suitable for sea water
Motor-drive specifications	Class F, IP55, 50 Hz, 2850 rpm
Housing/impeller/strainer/lid	PP/Noryl with F.V./PP/SAN

Water column height (m) KS Evo / KSX Pro Q (m³/h)-H (m)

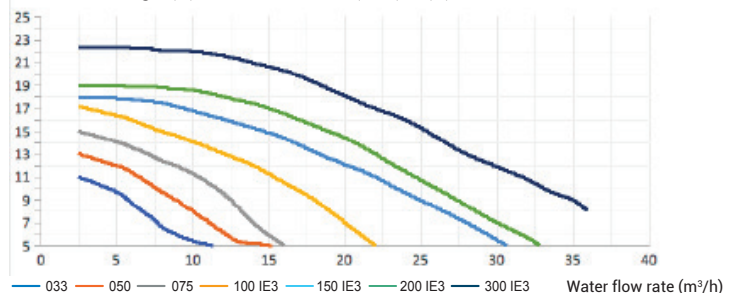

KS EVO VS

PRO LINE

YEAR OF GUARANTEES 2+1^{ans}



ENERGY SAVINGS AND VERSATILITY, WITH SILENT OPERATION

- » Variable speed: high efficiency for each application, optimised consumption
- » 5 programmes, 3 preselected speeds
- » Super-silent operation
- » Wing-nut closing system, rapid access (no tools required)
- » Double drain, easy opening (no tools required)
- » Simple installation, direct substitute for KS pumps, supplied with 50/63 mm unions
- » Impeller and diffuser made of Noryl, very hard-wearing and corrosion-resistant
- » Suitable for use in salt water. Mechanical seal in AISI 316
- » **Usage: for residential pools up to 126 m³**



Code	Ref.	P2 hp	P1 kW	A (mm)	Flow rate (m ³ /h)	Weight (kg)	Pack. (mm)	qty/pallet	C.S.U.
010925101520	KS Evo VS	1.50	1,1	543	21	15	330 x 255 x 650	25	1

P1: Input Power

P2: Nominal Power

* 10 m water column pressure

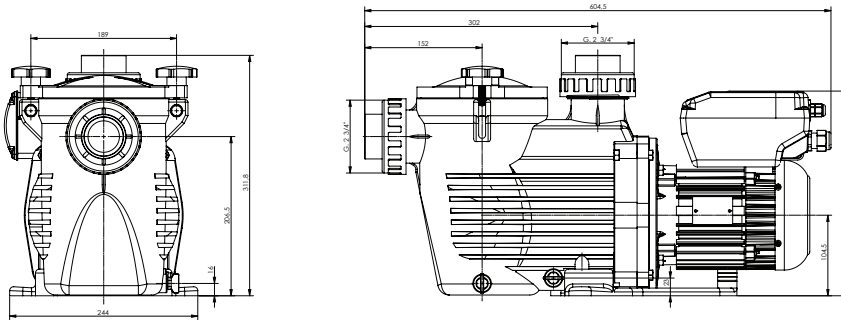

Technical Specifications

Max. water temp. / Max. pressure	50 °C/ 2.5 bar
Connection (DIN slip included, for others please ask)	63 mm
Mechanical seal	AISI 316, suitable for salt water
Motor-drive specifications	Class F, IP55, 50 Hz, single phase
Housing/impeller/strainer/lid	PP + FG/Noryl® with FG/PP/SAN®

Water column pressure (m)

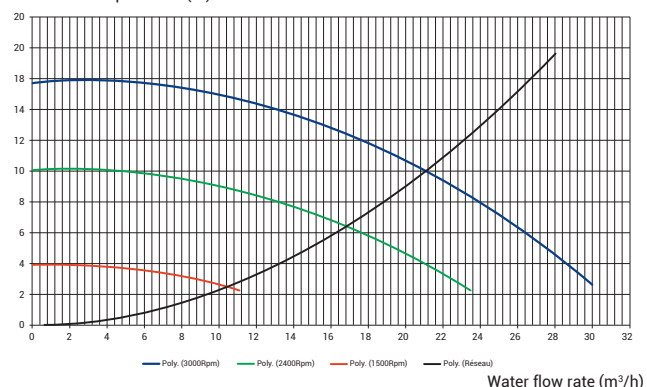



KORAL-KSE

CLASSIC LINE

YEAR OF GUARANTEES 2

THE ORIGINAL

- » Optimised and super-silent hydraulic system
- » Interior of the prefilter visible, easy and rapid access
- » Impeller in corrosion-resistant and hard-wearing Noryl
- » Double drain, easy opening (no tools required)
- » Connections: includes slip unions for Ø 50 or Ø 63 mm. ANSI 1½-2"
- » Suitable for use in salt water
- » **Usage: for residential pools up to 177 m³**



Code	Ref.	P2 hp	P1 kW	A (mm)	Flow rate (m ³ /h)	Weight (kg)	Pack. (mm)	qty/pallet	C.S.U.
010401221010	KSE 33 M	0.33	0.45	503	4.8	11.2	330 x 255 x 650	25	1
010411320110	KSE 50 M	0.50	0.58	550	7.5	12.5	330 x 255 x 650	25	1
010411350110	KSE 50 T1	0.50	0.58	550	7.5	12	330 x 255 x 650	25	1
010411420110	KSE 75 M	0.75	0.75	550	11.5	13.5	330 x 255 x 650	25	1
010411450110	KSE 75 T1	0.75	0.75	550	11.5	13	330 x 255 x 650	25	1
010411520110	KSE 100 M	1.00	1	550	15.4	14	330 x 255 x 650	25	1
010411550110	KSE 100 T1	1.00	1	550	15.4	13.5	330 x 255 x 650	25	1
010421120120	KSE 150 M	1.50	1.6	580	21.9	16.5	330 x 255 x 650	25	1
010421150120	KSE 150 T1	1.50	1.6	580	21.9	16	330 x 255 x 650	25	1
010421220120	KSE 200 M	2.00	1.92	580	25.7	17.5	330 x 255 x 650	25	1
010421250120	KSE 200 T1	2.00	1.92	580	25.7	17	330 x 255 x 650	25	1
010421420120	KSE 300 M	3.00	2.6	620	29.5	22.5	330 x 255 x 650	25	1
010421450120	KSE 300 T1	3.00	2.06	620	29.5	22	330 x 255 x 650	25	1

P1: Input Power

P2: Nominal Power

* 10 m water column pressure

60 Hz on request, ask for conditions ANSI or JIS on request

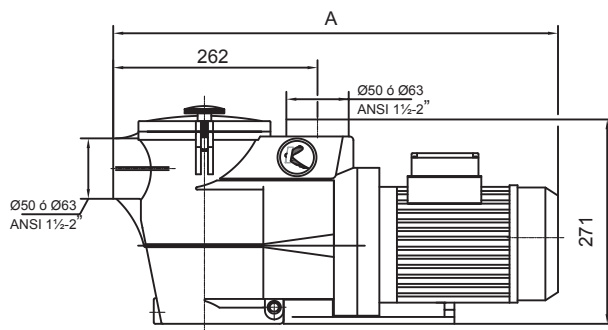

Technical Specifications

Max. water temp. / Max. pressure	50 °C/ 2.5 bar
Connection (DIN slip included, for others please ask)	Ø 50 (0.33 - 1 hp) Ø 63 (1.5 - 3.00 hp)
Mechanical seal	AISI 316, suitable for salt water
Motor specifications	Class F, IP55, 50 Hz, 2850 rpm
Housing/impeller/strainer/lid	Lid seal with wing-nuts, Noryl, PP, SAN

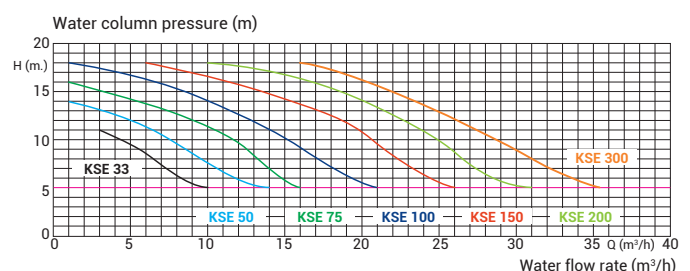

ONDINA-OK

CLASSIC LINE | YEAR OF GUARANTEES 2

HIGH EFFICIENCY AND LOW NOISE

- » Optimised for medium and small pools
- » Compact and silent, suitable for small technical rooms and underground technical equipment boxes
- » Quick-seal with wing nuts
- » Protection IP55, 50 HZ, 2850 rpm.
- » Can be used in salt water
- » **Usage: for residential pools up to 75 m³**



Code	Ref.	P2 hp	P1 kW	A (mm)	Flow rate (m ³ /h)	Weight (kg)	Pack. (mm)	qty/pallet	C.S.U.
010201121000	OK 33M	0.33	0.45	475	7	8	310 x 250 x 510	30	1
010201221000	OK 51M	0.5	0.58	475	8.5	8.5	310 X 250 X 510	30	1
010201250100	OK 51T1	0.5	0.58	475	8.5	8	310 X 250 X 510	30	1
010201321000	OK 71M	0.75	0.75	475	11.9	9	310 X 250 X 510	30	1
010201350100	OK 71T1	0.75	0.75	475	11.9	8.5	310 X 250 X 510	30	1
010211420100	OK 100M	1.00	1	505	17.2	9.5	310 X 250 X 510	30	1
010211450100	OK 100T1	1.00	1	505	17.2	9	310 X 250 X 510	30	1

P1: Input Power P2: Nominal Power * 8 m water column pressure

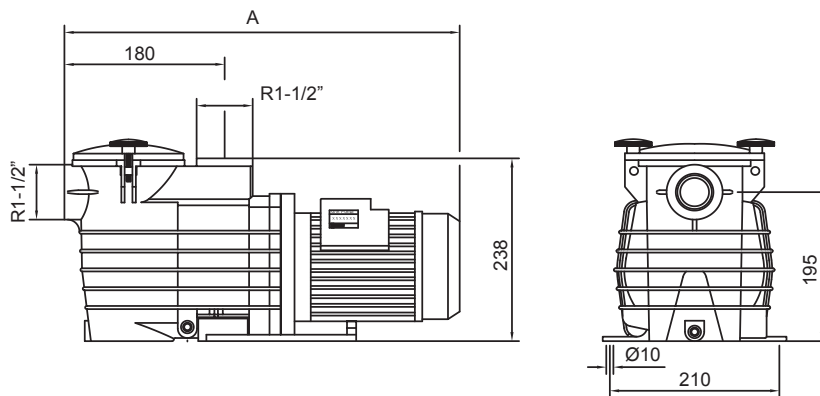

Technical Specifications

Max. water temp. / Max. pressure	50 °C/ 2.5 bar
Connection (DIN slip included, for others please ask)	OK Ø 1 1/2"
Mechanical seal	AISI 316, suitable for salt water
Motor-drive specifications	Class F, IP55, 50 Hz, 2850 rpm
Housing/impeller/strainer/lid	PP/ Noryl / PP / SAN

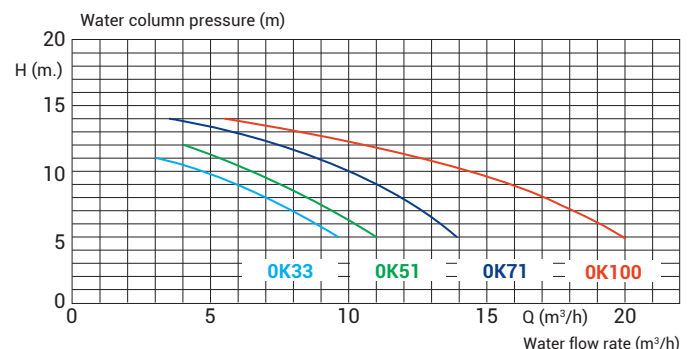

NINFA-NK

CLASSIC LINE

YEAR OF GUARANTEES 2

COMPACT AND SILENT

- » The solution for above-ground pools or small size traditional pools
- » Easy-open transparent lid (no tools required)
- » Connection thread 2" external and 1 1/4" internal
- » Can be used in salt water
- » **Usage: for residential pools up to 35 m³**



Code	Ref.	P2 hp	P1 kW	A (mm)	Flow rate (m ³ /h)	Weight (kg)	Pack. (mm)	qty/pallet	C.S.U.
010101021000	NK 25M	0.25	0.27	422	4	5.6	245 x 220 x 440	42	1
010101121000	NK 33M	0.33	0.36	422	6.4	6	245 x 220 x 440	42	1
010101221000	NK 51M	0.50	0.53	422	7.5	6.3	245 x 220 x 440	42	1

P1: Input Power P2: Nominal Power * 8 m water column pressure

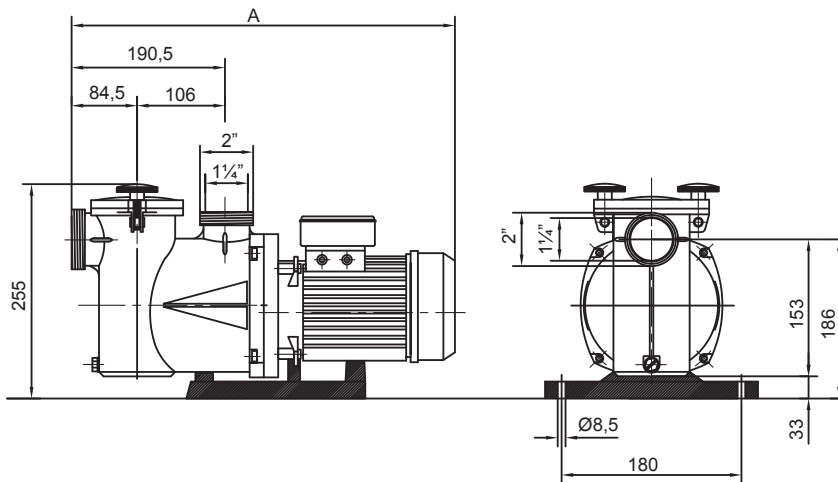

Technical Specifications

Max. water temp. / Max. pressure	50 °C/ 2.5 bar
Connection	2" external and 1 1/4" internal
Mechanical seal	AISI 316, suitable for sea water
Motor-drive specifications	Class F, IP55, 50 Hz (60 Hz, ask), 2850 rpm
Housing/impeller/basket/lid	PP / Noryl / PP / PC

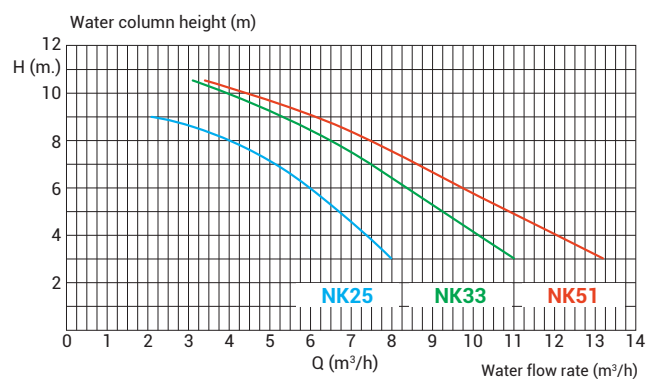

NIGER-KNG

CLASSIC LINE

YEAR OF GUARANTEES 2

NO PREFILTER

- » Water features, hydro massage, spas and general re-circulation
- » Impeller in Noryl and mechanical seal in AISI 316
- » Enclosed motor, protection class IP55, class F
- » Slip included: Ø 50 or Ø 63 mm.
- » Silent operation
- » This pump can be used in salt water
- » **Usage: water features, hydro massage, spas and general re-circulation**



IE3 ✓

Code	Ref.	P2 hp	P1 kW	A (mm)	Flow rate (m³/h)	Weight (kg)	Vol. (m³)	qty/pallet	C.S.U.
010711420110	KNG 075DM	0.75	0.75	412	12	11.5	0.028	30	1
010711450110	KNG 075DT1	0.75	0.75	412	12	11.5	0.028	25	1
010711520110	KNG 100DM	1.00	1	412	15.98	12	0.028	25	1
010711550110	KNG 100DT1	1.00	1	412	15.9	12	0.028	25	1
010721120120	KNG 150DM	1.50	1.6	442	22.4	14.5	0.028	25	1
010721150120	KNG 150DT1	1.50	1.6	442	22.4	14.5	0.028	25	1
010721220120	KNG 200DM	2.00	1.92	442	26.2	15.5	0.028	25	1
010721250120	KNG 200DT1	2.00	1.92	442	26.2	15	0.028	25	1
010771150120	KNG 150DT1 IE3	1.50	1.6	442	22.4	14.5	0.028	25	1
010771250120	KNG 200DT1 IE3	2.00	1.92	442	26.2	15	0.028	25	1

IE3 ✓

IE3 ✓

P1: Input Power P2: Nominal Power * 10 m water column pressure

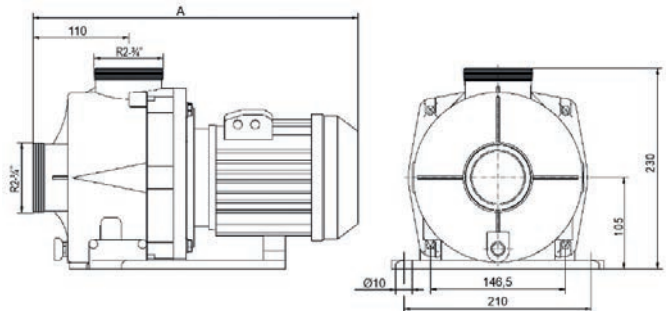
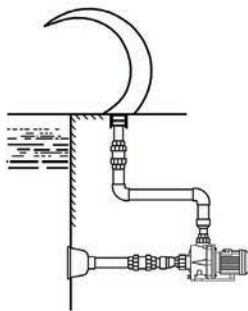

Technical Specifications

Max. water temp. / Max. pressure	50 °C/ 2.5 bar
Connection (DIN slip included, for others please ask)	Ø 50 or 63 mm
Mechanical seal	AISI 316, suitable for salt water
Motor-drive specifications	Class F, IP55, 50 Hz, 2850 rpm
Housing/impeller	PP+FG / Noryl Impeller

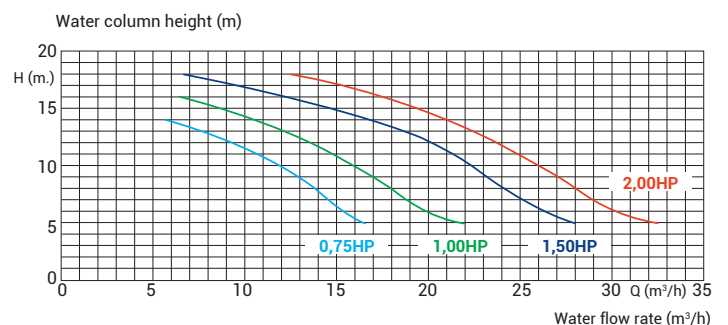

KARPA-KA

CLASSIC LINE

YEAR OF GUARANTEES 2

PUMPS FOR COUNTER-CURRENT SWIMMING EQUIPMENT

- » Recommended for counter-currents, hydro massage, spas, etc.
- » Pump housing in thermoset plastic
- » Usage: water features, counter-current jets



Code	Ref.	P2 hp	P1 kW	A (mm)	Flow rate (m3/h)	Weight (kg)	Vol. (m³)	qty/pallet	C.S.U.
011121120110	KA250M	2.5	2.3	581	44	20.8	0.083	18	1
011121150110	KA250T1	2.5	2.3	581	44	20.8	0.083	18	1
011131220110	KA300M	3	2.76	581	48	21.5	0.083	18	1
011121250110	KA300T1	3	2.76	581	48	21.5	0.083	18	1
011131350110	KA350T1	3.5	3.7	581	63	24.8	0.083	18	1
011131450110	KA450T1	4.5	4.3	581	67	26.8	0.083	18	1
011131359110	KA250T1IE3	2.5	-	581	44	-	0.083	18	1
011131459110	KA300T1IE3	3	-	581	48	-	0.083	18	1
011141029110	KA350T1IE3	3.5	-	581	63	-	0.083	18	1
011141129110	KA450T1IE3	4.5	-	581	67	-	0.083	18	1

- IE3 ✓
- IE3 ✓
- IE3 ✓
- IE3 ✓

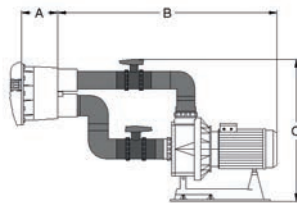
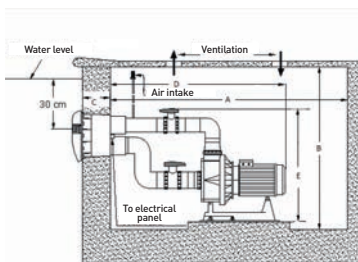

Technical Specifications

Max. water temp. / Max. pressure	50 °C/ 2.5 bar
Connection (DIN slip included, for others please ask)	Ø 50 or 63 mm
Mechanical seal	AISI 316, suitable for sea water
Motor-drive specifications	Class F, IP55, 50 Hz (60 Hz, ask), 2850 rpm
Housing/impeller/strainer/lid	Impeller in Noryl

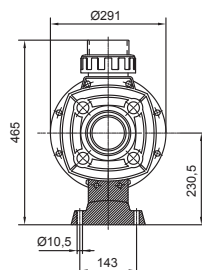
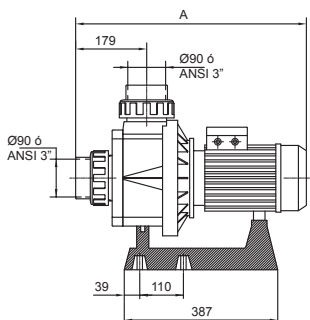

Pressure (mbar)

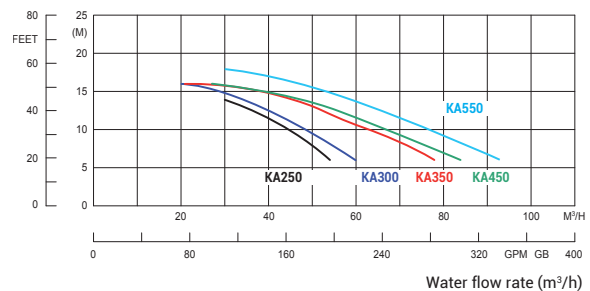

BLOWERS

BLOWERS FOR CONSTANT USE

- » Highly robust and easy to use.
- » Operates as intake or exhaust, suitable for use in conditions up to 40 °C.
- » Simple and rapid maintenance.
- » Asynchronous, single-phase or three-phase motors, insulation class F, 50 Hz, IP55, 1500 rpm.



Code	Ref.	Power	Voltage	Connection	Flow rate (m³/h)	Weight (kg)	Vol. (m³)	C.S.U.
146110008001	SKS80M	0.4	230	1 1/4"G	84	11.5	0.0156	1
146110008003	SKS80T1	0.4	230/400	1 1/4"G	84	11.5	0.0156	1
146110014003	SKS140T1	0.75	230/400	1 1/2"G	144	14.5	-	1
146110014401	SKH144M	0.75	230	1 1/4"G	144	16.5	-	1
146110025001	SKH250M	1.1	230	2"G	216	26	-	1
146110025003	SKH250T1	1.3	230/400	2"G	216	22	0.0251	1
146110025101	SKH251M	1.5	230	2"G	216	26.5	0.0389	1
146110025103	SKH251T1	1.75	230/400	2"G	216	23	-	1
146110030003	SKH300T1	2.2	230/400	2"G	312	32	0.0553	1
146110030103	SKH301T1	3.4	230/400	2"G	312	35	-	1
146110047503	SKS475T1	5.5	230/400	2 1/2"G	552	78	0.0997	1
146110055003	SKS550T1	7.5	230/400	2 1/2"G	552	82	-	1
146110100003	SKS1000T1	13.00	230/400	4"G	1134	112	-	1
146120080201	SKS802VM	0.75	230	1 1/4"G	90	17.5	0.0242	1
146120080203	SKS802VT1	0.75	230/400	1 1/4"G	90	17	0.0242	1
146120156203	SKS1562VT1	1.75	230/400	1 1/2"G	156	25	-	1
146120157203	SKS1572VT1	2.20	230/400	1 1/2"G	156	28	-	1
146120222203	SKS2222VT1	3.40	230/400	2"G	222	43	-	1
146120400203	SKS4002VT1	4.00	230/400	2"G	312	55	-	1
146120475203	SKS4752VT1	5.50	230/400	2"G	312	72	-	1
146120570203	SKS5702VT1	11.00	230/400	2 1/2"G	576	142	-	1

Technical Specifications

Max. water temp.	40 °C/ 2.5 bar
Connection (DIN slip included, for others please ask)	1 1/4"G - 4" G
Mechanical seal	Single/two-stage impellers
Motor-drive specifications	Asynchronous motor, insulation class F, 50 Hz, IP55, 1500 rpm

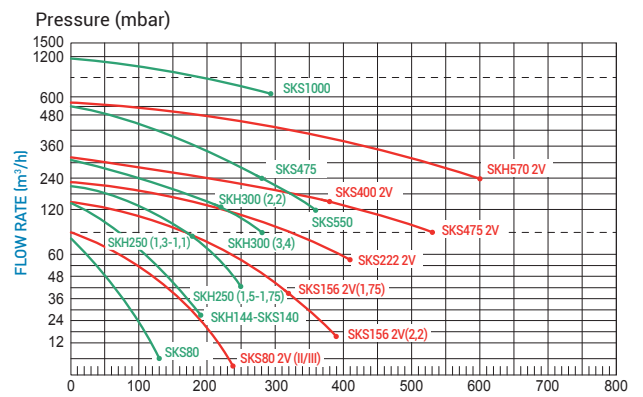
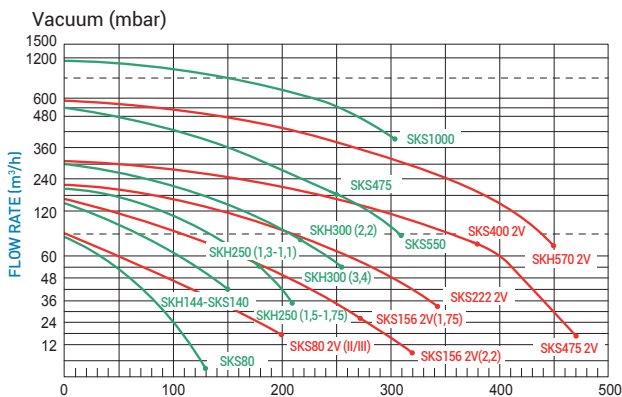

» **BLOWER CALCULATION FOR No. OF NOZZLES**

Type	No. nozzles
SKS 80 M / SKH 80 T1	6 / 7
SKS 140 T1 / SKH 144 M	10 / 12
SKH 250 T1 / SKH 250 M	12 / 16
SKH 251 M / SKH 251 T1	18 / 20
SKH 300 T1	28 / 30
SKH 301 T1	28 / 30
SKH 475 T1	50

Calculation for maximum 1 mWC

» **ADDITIONAL DOUBLE-ENDED SILENCER**

Code	Type	Dimensions (mm)					Weight (kg)
		A	B	C	D	E (Gas)	
B8070523.7	SSD	240	140	50	70	1 1/4"	0.5
146500150000	SSD1	230	170	30	80	1 1/2"	0.6
146500200000	SSD2	260	200	30	90	2"	0.7
B8070522.7	SSD3	260	200	30	90	2 1/2"	0.7

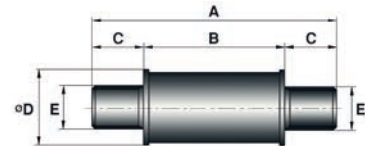

ELECTRICAL PANEL

WIDE RANGE OF ELECTRICAL PANELS

» **MOUNTED IN AN IP54 THERMOPLASTIC BOX**

» **ELECTRONIC PANEL FOR FILTERS**

For single-phase or three-phase pumps - With programmable timer - Automatic reset

Type	Code	HP. Maximum power		Adjust. Range	Weight (kg)	Vol. (m³)	qty/ pack
		230 V II	400 V III				
CRM	081001100001	4.00	5.50	0 - 16	1.7	0.010	1

Auxiliary outlet: please ask



» **ELECTRONIC PANEL FOR FILTERS AND LIGHTING**

Includes self-protected transformer - Outlet connection for 20, 30, 40 m lengths

Type	Code	For Lights No. x W	Adjust. Range	Weight (kg)	Vol. (m³)	qty/ pack
CRM 300	081003003001	1 x 300	0 - 16	7.9	0.020	1
CRM 600	081003006001	2 x 300	0 - 16	11.0	0.022	1

Auxiliary outlet available for CRM600: please ask



» **ELECTRONIC PANEL FOR COUNTER-CURRENT EQUIPMENT**

Available for management of 1 or 2 pumps - For single-phase or three-phase pumps

Type	Code	HP. Maximum power		Adjust. Range	Weight (kg)	Vol. (m³)	qty/ pack
		230 V II	400 V III				
CRCC 1	081006100000	3	5.5	0 - 16	1.7	0.010	1
CRCC 2	081006200000	3	5.5	0 - 16	1.7	0.010	1



ELECTRICAL PANEL

» ELECTRONIC PANEL FOR LIGHTING ONLY

Includes transformer - Outlet connection for 20, 30, 40m lengths

Type	Code	For Lights No. x W	Weight (kg)	Vol. (m ³)	qty/ pack
CRI 100	081002113001	1 x 100	5.00	0.010	1
CRI 300	081002130001	1 x 300	6.00	0.010	1
CRI 600	081002230001	2 x 300	10.8	0.010	1

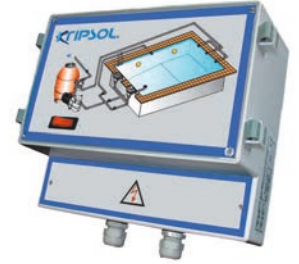

» ELECTRONIC PANEL FOR BUFFER TANK LEVEL

Includes 5 cordless level probes - For 24 V or 230 V solenoid valves

Type	Code	Solenoid Valve Output V	Pump Output V	Weight (kg)	Vol. (m ³)	qty/ pack
CRVC 24	081004024000	24	230	3.0	0.010	1
CRVC 230	081004220000	230	230	1.6	0.010	1



» CONTROL PANEL

Includes: adjustable thermal-magnetic circuit breaker, programmable clock, control fuse and manual/automatic switch - For three-phase models please enquire

Type	Code	HP. Maximum power	Adjust. Range	Weight (kg)	Vol. (m ³)	qty/ pack
230 V II						
AM 25	080101102500	0.33	1.6 - 2.5	0.80	0.004	1
AM 40	080101104000	0.75	2.5 - 4.0	0.80	0.004	1
AM 63	080101106300	1.00	4.0 - 6.3	0.80	0.004	1
AM 100	080101110000	2.00	6.3 - 10.0	0.80	0.004	1

Models with built-in differential available



» **CONTROL PANEL FOR FILTERS AND LIGHTING 1 SPOTLIGHT**

Includes: adjustable thermal-magnetic circuit breaker, programmable clock, control fuse, manual/automatic switch and 300 W transformer - For three-phase models please enquire

Type	Code	HP. Maximum power	Adjust. Range	Weight (kg)	Vol. (m ³)	qty/ pack
230 V II						
NF1MD - 25	080104102503	0.33	1.6 - 2.5	7.0	0.012	1
NF1MD - 40	080104104003	0.75	2.5 - 4.0	7.0	0.012	1
NF1MD - 63	080104106003	1.00	4.0 - 6.3	7.0	0.012	1
NF1MD - 100	080104110003	2.00	6.3 - 10.0	7.0	0.012	1



» **LIGHTING PANEL**

Made up of: on / off switch, protective fuses, 230 V / 12 V transformers and input terminals. The entire assembly is mounted in a transparent box with a modular design.

Type	Code	No. Lights	Transformers	Weight (kg)	Vol. (m ³)	qty/ pack
AF1 - 300	080105000003	1	300 W	6.5	0.020	1
AF2 - 600	080105000004	2	300 W + 300 W	12.0	0.025	1
AF3 - 900	080105000005	3	300 W + 600 W	17.0	0.025	1
AF4 - 1200	080104110006	4	600 W + 600 W	21.0	0.020	1



ACCESSORIES

» **TRANSFORMERS**

Isolation transformers to operate in wet and corrosive environments. Encased in epoxy resin. With three outlets for lengths of 20, 30 and 40 metres. Manufactured to comply with standard UNE -EN 60742.

Type	Code	Power W	Voltage V		Frequency Hz	Weight (kg)	Vol. (m ³)	qty/ pack
			Prim.	Sec.				
T050	084010050000	50	230	12	50	1.2	0.001	1
T100	084010100000	100	230	12	50	2.0	0.001	1
T300	084010300000	300	230	12	50	5.0	0.004	1
T600	084010600000	600	230	12	50	7.0	0.006	1



FILTERS

THE PERFECT PARTNER FOR OUR PUMPS

We have been designing and manufacturing filters for over 30 years, always in synchronisation with our pumps. Starting with the first Balear filter, we have designed a KS pump consistent with its hydraulic system and which, as always, takes care of the detail. No metal parts in contact with the water, easy maintenance avoiding the use of tools as much as possible, exceptionally hard-wearing and, of course, a hydraulic system that is optimised to obtain the best filtration quality.

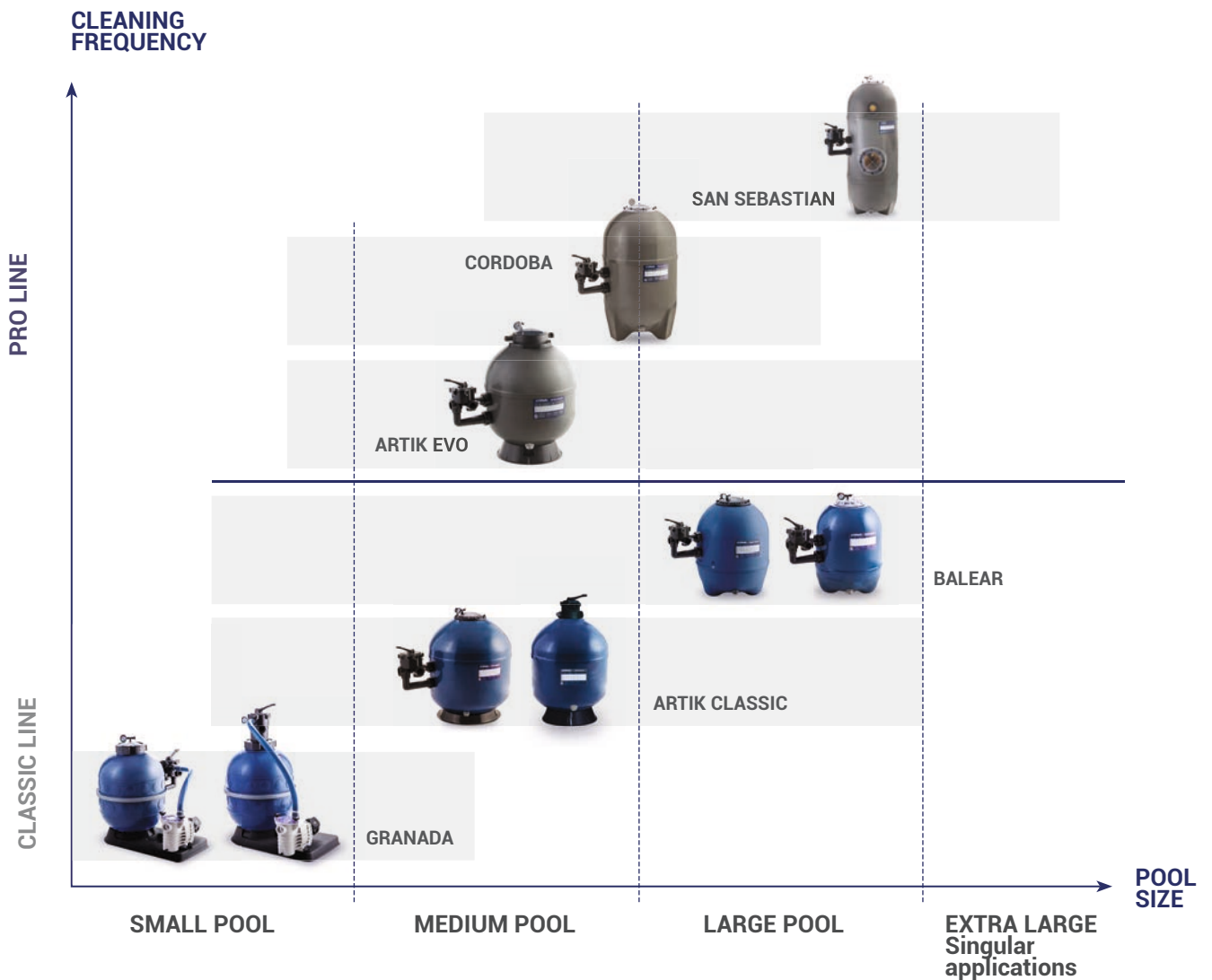

FILTERS

SAN SEBASTIAN	p.26
CORDOBA	p.27
ARTIK EVO	p.28
BALEAR CLASSIC	p.30
ARTIK CLASSIC	p.31
GRANADA	p.32
COMPLETE FILTER UNITS	p.33
MULTIPORT VALVES	p.34
VITRAFIL	p.35
UNDERGROUND FILTRATION BOXES EQUIPPED WITH FILTER SETS	p.36
PUMPS RECOMMENDED FOR FILTERS	p.37

SAN SEBASTIAN

PRO LINE

YEAR OF GUARANTEES 2

HIGH PERFORMANCE LAMINATED FILTER

- » Very high filtration efficiency thanks to the height of the filtration bed
- » Includes a sight glass, transparent side opening and Pro Line pressure gauge
- » Transparent covers on top opening and side opening
- » **Versions:** Collector arms and nozzle plate
- » **Filter bed options:** 1.00 or 1.20 m
- » **For residential pools and spas**
- » Union kit RRFI006.01R for valves, and the valve VKN6 63 are supplied separately



Code	Ref.	Connection	Filtration area (m ²)	Flow rate (m ³ /h) @ v(m ³ /h/m ²)	Sand (kg)	Weight (kg)	Vol. (m ³)	
				40				
041111060122	SSB 640	2"	0.32	12	500	52	0.745	Collector arm
041111070122	SSB 760	2"	0.45	18	675	64	1.02	Collector arm
041111090122	SSB 900	2"	0.63	25	950	75	1.395	Collector arm
041116060122	SSP 640	2"	0.32	12	500	60	0.745	Nozzle plate
041116070122	SSP 760	2"	0.45	18	675	74	1.02	Nozzle plate
041116090122	SSP 900	2"	0.63	25	950	86	1.395	Nozzle plate
041112060122	SBL 640	2"	0.32	12	600	68	0.82	Collector arm
041112070122	SBL 760	2"	0.45	18	825	83	1.125	Collector arm
041112090122	SBL 900	2"	0.63	25	1150	98	1.62	Collector arm
041117060122	SPL 640	2"	0.32	12	575	76	0.82	Nozzle plate
041117070122	SPL 760	2"	0.45	18	825	93	1.125	Nozzle plate
041117090122	SPL 900	2"	0.63	25	1150	110	1.62	Nozzle plate

Technical Specifications

Max. water temp.	40 °C
Operating pressure	0.5 - 1.6 bar
Maximum pressure	2.5 bar

Connection	Ø 2"
Tank / Arms / Unions / Cover	Polyester with F.G./PP/PVC/PC
Granulometry of filter material	0.4 - 0.8 mm

Dimensions (mm)

Ref.	A	B	C	D	G
SSB 640	1620	755	140	640	1000
SSB 760	1620	755	140	760	1000
SSB 900	1620	755	140	900	1000
SSP 640	1620	755	140	640	1000
SSP 760	1620	755	140	760	1000
SSP 900	1620	755	140	900	1000
SBL 640	1820	755	140	640	1200
SBL 760	1820	755	140	760	1200
SBL 900	1820	755	140	900	1200
SPL 640	1820	755	140	640	1200
SPL 760	1820	755	140	760	1200
SPL 900	1820	755	140	900	1200

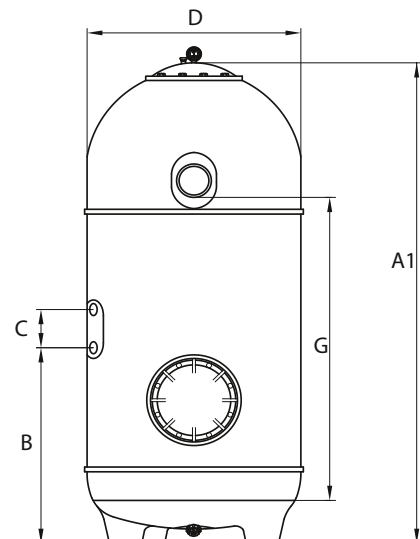

CORDOBA

PRO
LINE

YEAR OF
GUARANTEES | 2

FILTRATION QUALITY TO THE VERY HIGHEST STANDARDS



- » Crystal clear water, filter bed up to 20% higher than sand filters
- » **Premium equipment:** transparent cover, 6-way valve and Pro Line pressure gauge included
- » Elegant grey finish, resistant to wear and tear
- » **Usage: for residential pools and small spas**



Code	Ref.	Connection	Filtration area (m ²)	Flow rate (m ³ /h) @ v(m ³ /h/m ²)			Sand (kg)	Weight (kg)	Vol. (m ³)
				30	40	50			
025152147522	BC 520	1.5"	0.21	6	8	10	140	20	0.307
025164147522	BC 640	1.5"	0.32	9	12	15	250	28	0.5
025180247522	BC 800	2"	0.5	15	20	25	445	38	0.875

Technical Specifications

Max. water temp.	50 °C
Operating pressure	0.5 - 1.3 bar
Maximum pressure	2.5 bar
Connection	1.5" (ø 520 mm - ø 640 mm) 2" (ø 800 mm)
Tank / Arms / Unions / Cover	Polyester with F.G./PP/PVC/PC
Granulometry of filter material	0.4 - 0.8 mm

Dimensions (mm)

Ref.	A	B	C	D	F
BC 520	980	400	525	580	520
BC 640	1070	450	575	650	640
BC 800	1200	500	640	790	800

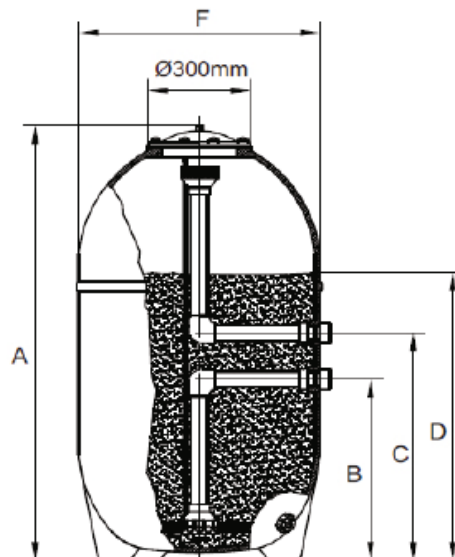

ARTIK EVO

PRO LINE

YEAR OF GUARANTEES 5 | 2
TANK EQUIPMENT

THE PROFESSIONAL SOLUTION FOR RESIDENTIAL POOLS

- » Optimised hydraulic system for **high quality filtration**
- » Twist-lock cover, **rapid access (no tools required)**
- » Wide opening for **easy maintenance**
- » 6-way valve included
- » Pro Line pressure gauge and air release
- » **Optimal distribution of water** over the bed, thanks to the Dual-Side diffuser
- » Quick-connect collector arms, **easy to replace**
- » Internal monoblock element, **without slip fittings**
- » Wide drain, no tools required for opening, **easy maintenance**
- » **Usage: for residential pools up to 189 m³**



Internal automatic air release



Quick-connect arm collectors



Glycerine-filled pressure gauge + release kit



Twist lock



Dual-side diffuser



Wide double draining, water/sand



Internal monoblock element

Code	Ref.	Connection	Filtration area (m ²)	Flow rate (m ³ /h) @ v(m ³ /h/m ²)			Sand (kg)	Vitrafil (kg)	Pools up to (m ³)	Dimensions (mm)						Weight (kg)	Vol. (m ³)	
				30	40	50				A	A1	B	C	D	E			F
022852148522	AK Evo 520	1.5"	0.21	6.3	8.4	10.5	100	90	63	715	875	305	125	520	140	458	17	0.242
022864148522	AK Evo 640	1.5"	0.32	9.6	12.8	16	150	135	96	800	960	315	125	640	125	458	23	0.366
022876248522	AK Evo 760	2"	0.45	13.5	18	22.5	225	200	135	840	1000	365	140	760	100	605	34	0.608
022890248522	AK Evo 900	2"	0.63	18.9	25.2	31.5	325	290	189	840	1000	365	140	900	150	605	45	0.902

Technical Specifications

Operating pressure	0.5 - 1.3 bar
Maximum pressure	2.5 bar
Max. water temp.	50 °C
Connection	1.5" (ø 520 mm - ø 640 mm) 2" (ø 760 mm - ø 900 mm)
Tank / Arms / Unions / Cover	Polyester with F.G./PP/PP/ Noryl® and SAN®
Granulometry of filter material	0.4 - 0.8 mm

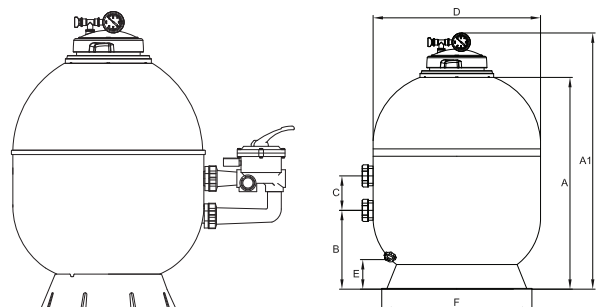



BALEAR CLASSIC

CLASSIC LINE

YEAR OF GUARANTEES 2

EFFICIENT AND HARD-WEARING

- » Optimised hydraulic system for **high quality filtration**
- » Wide opening for **easy maintenance**
- » 6-way valve, pressure gauge and air release included
- » Perfectly stable thanks to its three-point support
- » **Optimal distribution of water** over the bed, thanks to the Dual-Side diffuser
- » Quick-connect collector arms, **easy to replace**
- » Internal monoblock element, **without slip fittings**
- » Wide drain, no tools required for opening, **easy maintenance**
- » **Usage: for residential pools up to 189 m³**



BR



BL



Dual-side diffuser



Wide double draining, water/sand



Internal monoblock element

BL-transparent screw-on lid, with a view into the interior

Code	Ref.	Connection	Filtration area (m ²)	Flow rate (m ³ /h) @ v(m ³ /h/m ²)			Sand (kg)	Vitrafil (kg)	Pools up to (m ³)	Dimensions (mm)					Weight (kg)
				30	40	50				A	B	C	D	E	
021040143523	BR 400	1.5"	0.13	3.9	5.2	6.5	50	40	39	255	380	565	400	300	11.5
021045143523	BR 450	1.5"	0.16	4.8	6.4	8	75	65		315	440	700	450	300	14
021052143523	BR 520	1.5"	0.21	6.3	8.4	10.5	100	90	63	355	480	790	520	300	17
021064143523	BR 640	1.5"	0.32	9.6	12.8	16	150	135	96	405	530	860	640	300	23
021068243523	BR 680	2"	0.36	10.8	14.4	19	175	150	114	425	550	905	680	300	26
021076243523	BR 760	2"	0.45	13.5	18	22.5	225	200	135	460	600	1020	760	300	34
021090243523	BR 900	2"	0.63	18.9	25.2	31.5	325	290	189	470	610	1035	900	300	45
021240147523	BL 400	1.5"	0.13	3.9	5.2	6.5	50	40	39	255	380	555	400	220	11.5
021245147523	BL 450	1.5"	0.16	4.8	6.4	8	75	65		315	440	690	450	220	14
021252147523	BL 520	1.5"	0.21	6.3	8.4	10.5	100	90	63	355	480	780	520	220	17
021264147523	BL 640	1.5"	0.32	9.6	12.8	16	150	135	96	405	530	850	640	220	23
021268247523	BL 680	2"	0.36	10.8	14.4	19	175	150	114	425	550	895	680	220	26
021276247523	BL 760	2"	0.45	13.5	18	22.5	225	200	135	460	600	1010	760	220	34
021290247523	BL 900	2"	0.63	18.9	25.2	31.5	325	290	189	470	610	1025	900	220	45

Technical Specifications

Max. water temp.	50 °C
Operating pressure	0.5 - 1.3 bar
Maximum pressure	1.6 bar
Connection	1.5" (ø 520 mm - ø 640 mm) 2" (ø 760 mm - ø 900 mm)
Tank / Arms / Unions / Cover	Polyester with F.G./PP/ABS or PC
Granulometry of filter material	0.4 - 0.8 mm

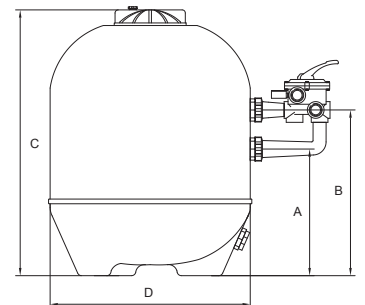
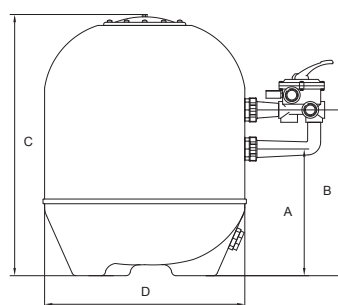

ARTIK CLASSIC

CLASSIC LINE

YEAR OF GUARANTEES | 2

ROBUST AND RELIABLE, PROBLEM-FREE FILTERING



- » A quality solution available in Side and Top versions
- » 6-way valve included
- » **Optimal distribution of water** over the bed, thanks to the Dual-Side diffuser
- » Quick-connect collector arms, **easy to replace**
- » Internal monoblock element, **without slip fittings**
- » Wide drain, no tools required for opening, **easy maintenance**
- » **Usage: for residential pools up to 189 m³**



AK Side

AK Top



Wide double draining, water/sand

Internal monoblock element

Code	Ref.	Connection	Filtration area (m ²)	Flow rate (m ³ /h) @ v(m ³ /h/m ²)			Sand (kg)	Vitrafil (kg)	Pools up to (m ³)	Dimensions (mm)					Weight (kg)	Vol. (m ³)
				30	40	50				A	B	C	D	E		
022140103656	AK 400	1.5"	0.13	3.9	5.2	6.5	50	40	39	225	350	665	458	300	11	0.127
022152103656	AK 520	1.5"	0.21	6.3	8.4	10.5	100	90	63	305	430	775	458	300	15.5	0.242
022164103656	AK 640	1.5"	0.32	9.6	12.8	16	150	135	96	315	440	860	458	300	21	0.366
022168203656	AK 680	2"	0.36	10.8	14.4	19	175	150	114	320	455	900	605	300	25	0.406
022176203656	AK 760	2"	0.45	13.5	18	22.5	225	200	135	365	455	900	605	300	31	0.608
022190203656	AK 900	2"	0.63	18.9	25.2	31.5	325	290	189	365	505	900	605	300	40	0.902
022240310056	AKT 400	1.5"	0.13	3.9	5.2	6.5	50	40	39	660	920	-	458	-	10.5	0.123
022252310056	AKT 520	1.5"	0.21	6.3	8.4	10.5	100	90	63	735	995	-	458	-	15.5	0.242
022264310056	AKT 640	1.5"	0.32	9.6	12.8	16	150	135	96	800	1060	-	458	-	21	0.366

Technical Specifications

Max. water temp.	50 °C
Operating pressure	0.5 - 1.3 bar
Maximum pressure	1.6 bar
Connection	1.5" (ø 520 mm - ø 640 mm) 2" (ø 760 mm - ø 900 mm)
Tank / Arms / Unions / Cover	Polyester with F.G./PP/ABS/PP
Granulometry of filter material	0.4 - 0.8 mm

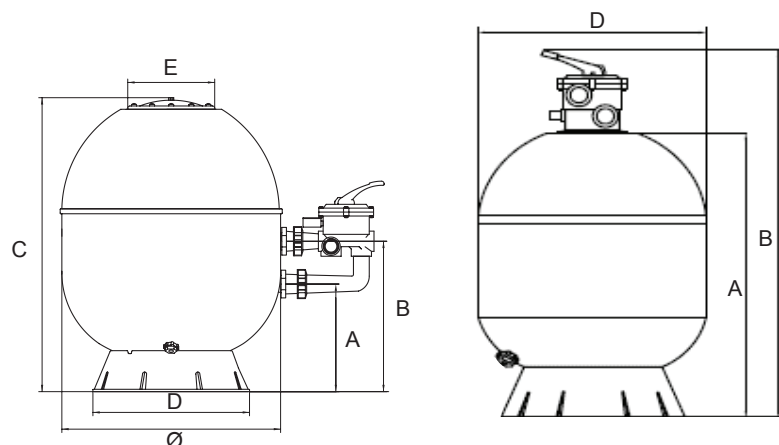

GRANADA

CLASSIC LINE

YEAR OF GUARANTEES 2

OPTIMAL SOLUTION FOR MEDIUM AND SMALL POOLS



- » Injected filters, unaffected by pool chemicals
- » Complete range: side and top models
- » Includes: 6-way valve, unions and pressure gauge
- » For pools up to 65 m³
- » Wide opening for easy maintenance



6-way valve

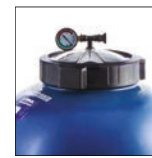

Threaded opening \varnothing 180 mm, to facilitate maintenance operations



Circular base, for perfect stability of the filter

Code	Ref.	Connection	Filtration area (m ²)	Flow rate		Sand (kg)	Weight (kg)	Vol. (m ³)
				(m ³ /h)	@ v(m ³ /h/m ²)			
				40	50			
020140142123	GL 400	1.5"	0.13	4.8	6	50	10.5	0.17
020150142123	GL 500	1.5"	0.19	7.6	9.5	100	12.5	0.25
020160142123	GL 600	1.5"	0.28	11.2	14	125	15.5	0.35
020240362123	GT 400	1.5"	0.13	4.8	6	50	10	0.17
020250362123	GT 500	1.5"	0.19	7.6	9.5	100	12	0.25
020260362123	GT 600	1.5"	0.28	11.2	14	125	15	0.35

Technical Specifications

Operating pressure	0.5 - 1.3 bar
Maximum pressure	2.0 bar
Max. water temp.	50 °C
Connection	1.5"
Tank / Arms / Unions / Cover	Polyester with F.G./PP/PP/Noryl® and SAN®
Granulometry of filter material	0.4 - 0.8 mm

Dimensions (mm)

Ref.	A	B	C	D	F
GL 400	266	391	651	503	453
GL 500	345	470	808	503	553
GL 600	391	516	891	503	653
GT 400	720	780	922	503	453
GT 500	877	937	1079	503	553
GT 600	960	1020	1161	503	653

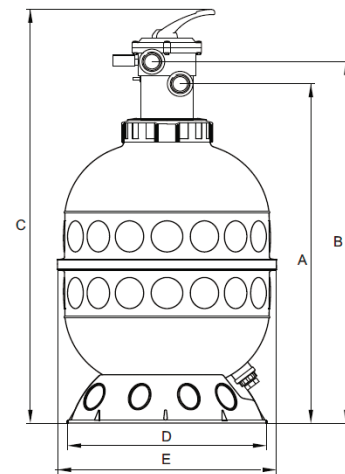
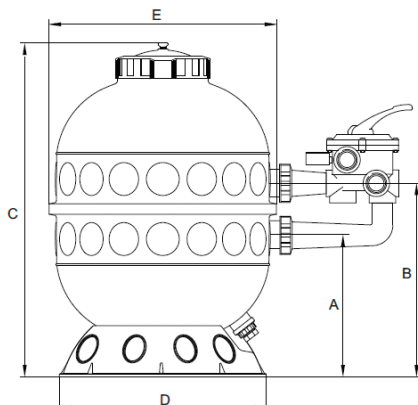

COMPLETE FILTER UNITS

CLASSIC LINE

YEAR OF GUARANTEES | 2

ALL-IN-ONE

- » Granada series filter
- » Side or top options
- » 6-way valve and unions
- » Pressure gauge
- » Pump, options Ninfa or Ondina
- » Connection between pump and filter
- » **For above ground residential pools or traditional medium-sized or small pools**



FILTERS

Code	Ref.	Filter ø	Connection	Pump	Flow rate		Sand (kg)	Weight (kg)	Vol. (m³)
					(m³/h)	@ v(m³/h/m²)			
					40	50			
020540103323	GLN 400-33	400	1.5"	NK 33	9.5	8.4	50	18.8	0.242
020550207123	GLO 500-71	500	1.5"	OK 71	12	11	100	25.5	0.349
020560210023	GLO 600-100	600	1.5"	OK 100	11.9	10.3	125	28.5	0.488
020640102523	GTN 400-33	400	1.5"	NK 33	9.5	8.4	50	17.8	0.242
020650207123	GTO 500-71	500	1.5"	OK 71	12	11	100	25.5	0.349
020660210023	GTO 600-100	600	1.5"	OK 100	11.9	10.3	125	28.5	0.488

Technical Specifications

Max. water temp. / Max. pressure	50 °C / 1.6 bar
Operating pressure	0.5 - 1.3 bar
Test pressure	2.5 bar
Connection	1.5"
Tank / Arms / Unions / Cover	Polyester with F.G./PP/PP/PP
Granulometry of filter material	0.4 - 0.8 mm

Dimensions (mm)

Ref.	A	B	C	D	E
GLN 400-33	251	376	636	824	453
GLO 500-71	331	456	795	824	553
GLO 600-100	376	501	875	824	653
GTN 400-33	706	766	907	824	453
GTO 500-71	864	924	1065	824	553
GTO 600-100	944	1004	1146	824	653

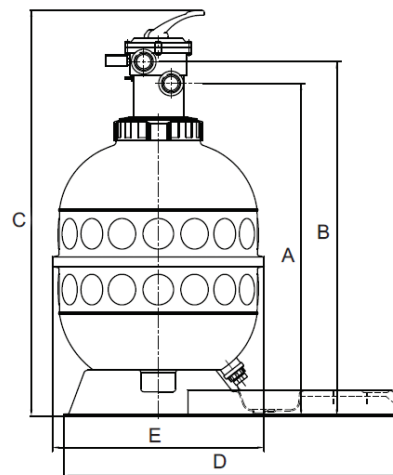
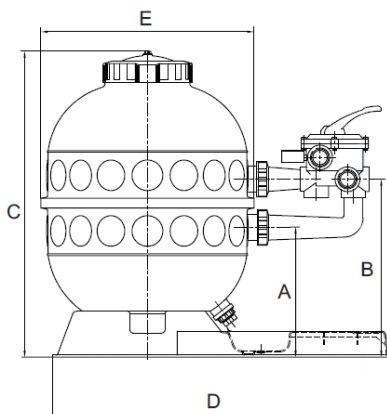

MULTIPORT VALVES

MULTIPORT VALVES FOR FILTERS

FILTERS



Side valve



Top valve

Images are not contractual

Code	Ref.	Colour	Connection	Unions Included	For Filters	Weight (kg)	Vol. (m³)
250112010000	VK643	White	1.5"	NO	GL406-GL606; AK520-AK640 BL/BR400-BL/BR640; BC520-BC640	1.75	0.009
250112011200	VKN643	Black	1.5"	NO	GL406-GL606; AK520-AK640 Evo BL/BR400-BL/BR640; BC520-BC640	1.75	0.009
250120010000	VK663	White	2"	NO	AK680-AK900; BL/BR680-BL/BR900 BC800; SSB/SSL; SSP/SPL	3	0.016
250120011200	VKN663	Black	2"	NO	AK680-AK900 Evo; BL/BR680-BL/BR900; BC800; SSB/SSL; SSP/SPL	3	0.016
250112510000	VK6T41	White	1.5"	NO	AKT520-AKT640	2	0.17
250112511000	VK6T41N	Black	1.5"	NO	AKT520-AKT640	2	0.17
250112520000	VK6T43	White	1.5"	NO	GT406-GT606	3	0.25
250112521200	VK6T43N	Black	1.5"	NO	GT406-GT606	3	0.25

Dimensions (mm)

Ref.	A	B	C	D
400	125	176	167	84.5
520	125	176	167	84.5
640	125	176	167	84.5
680	125	230	210	84.5
760	140	230	210	84.5
900	140	230	210	84.5
400 TOP	-	173	225	84.5
520 TOP	-	173	225	84.5
640 TOP	-	173	225	84.5

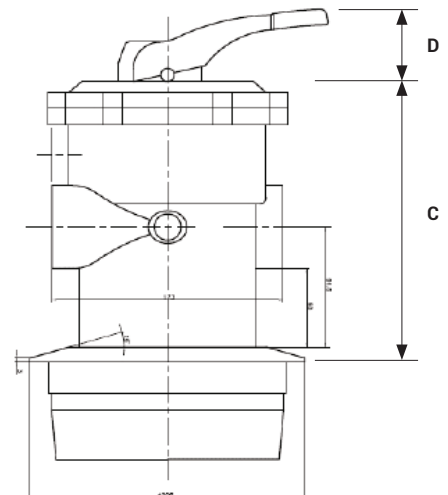
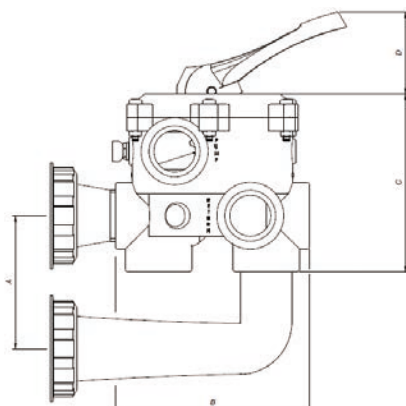

VITRAFIL

GLASS ACTIVE FILTER MEDIUM

- » Does not generate biofilm, no agglomeration, avoids forming preferential paths
- » **Extremely hard-wearing.**
100-year lifetime
- » **Reduces consumption of chemicals**
by up to 50% and the time taken for backwashing, saving water
- » **Certified by Bureau Veritas**, 100% free of impurities, clean right from the start



Code	Ref.	Packaging	Quantity	Granulometry Ø (mm)	Weight (kg)	Vol. (m ³)
260400002000	VAF	Bag	20	0.6	20.1	0.024
260400100000	VAF2	Pallet	1 000	0.6	1000	1



YEAR OF GUARANTEES | 2

UNDERGROUND TECHNICAL BOXES

A COMPREHENSIVE SOLUTION

- » **Injected plastic containers** made of polyester and fibreglass
- » Reinforced cover
- » **Includes:** filter, pump, multiport valve, pressure gauge, 5 ball valves
- » Unions can be taken apart for easy maintenance, no cutting or gluing required



CM / CS Model



CJ Model

Code	Ref.	Container	Filter	Pump	Chlorinator	Weight (kg)	Vol. (m³)
028012205000	CMG0506-71	Mini CM1	GL506	OK 71M	-	51.5	0.864
028043205000	CMG0526-71	Mini CM1	AK520	OK 71M	-	54	0.864
028144207000	CSA0646-100	Standard CS1	AK640	OK 100M	-	76.5	1.365
028245413000	CJA76-20	Jumbo CJ1	AK760	KSE200M	-	154.5	2.85
028012205200	CMG0502C71	Mini CM1	GL506	OK 71M	KLX 22	51.5	0.864
028043205200	CMA0522C71	Mini CM1	AK520	OK 71M	KLX 22	54	0.864
028144207200	CSA0642C100	Standard CS1	AK640	OK100M	KLX 22	76.5	1.365
028246413300	CJA763C-20	Jumbo CJ1	AK760	KSE200M	KLX 33	154.4	2.85

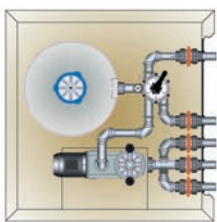

TO SEWER SYSTEM
 BACK TO POOL
 FROM THE CLEANER
 FROM THE SKIMMERS
 FROM THE MAIN DRAIN

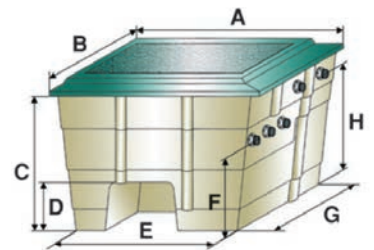
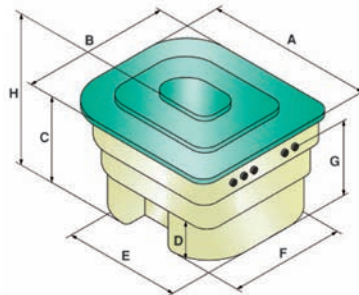

Model

	CM	CS	CJ
A	1150	1270	1750
B	1030	1170	1550
C	800	850	1050
D	175	295	450
E	900	1000	1480
F	350	495	1150
G	800	890	850
H	665	675	1150

Technical Specifications

Test pressure	1.5 bar
CM1 Model	for filters Ø 400 - 520 mm
CS1 Model	for filters Ø 400 - 640 mm
CJ1 Model	for filters Ø 680 - 900 mm

PUMPS RECOMMENDED FOR FILTERS

ARTIK CLASSIC

Code	Ref.	Recommended Pumps		
022140103656	AK 400	OK 51	KS Evo 33	KSE 33
022152103656	AK 520	OK 71	KS Evo 50	KSE 50
022164103656	AK 640	KSX Pro 100	KS Evo 100	KSE 100
022168203656	AK 680	KSX Pro 150	KS Evo 150	KSE 150
022176203656	AK 760	KSX Pro 150	KS Evo 150	KSE 150
022190203656	AK 900	KPR 250	KPR 250	KSE 300
022240310056	AKT 400	OK 51	KS Evo 33	KSE 33
022252310056	AKT 520	OK 71	KS Evo 50	KSE 50
022264310056	AKT 640	KSX Pro 100	KS Evo 100	KSE 100

BALEAR CLASSIC

Code	Ref.	Recommended Pumps		
021040143523	BR 400	OK 51	KS Evo 33	KSE 33
021052143523	BR 520	OK 71	KS Evo 50	KSE 50
021064143523	BR 640	KSX Pro 100	KS Evo 100	KSE 100
021068243523	BR 680	KSX Pro 150	KS Evo 150	KSE 150
021076243523	BR 760	KSX Pro 150	KS Evo 150	KSE 150
021090243523	BR 900	KPR 250	KPR 250	KSE 300
021240147523	BL 400	OK 51	KS Evo 33	KSE 33
021252147523	BL 520	OK 71	KS Evo 50	KSE 50
021264147523	BL 640	KSX Pro 100	KS Evo 100	KSE 100
021268247523	BL 680	KSX Pro 150	KS Evo 150	KSE 150
021276247523	BL 760	KSX Pro 150	KS Evo 150	KSE 150
021290247523	BL 900	KSX Pro 300	KS Evo 300	KSE 300

AK EVO

Code	Ref.	Recommended Pumps		
022852148522	AK Evo 520	OK 71	KS Evo 50	KSE 50
022864148522	AK Evo 640	KSX Pro 100	KS Evo 100	KSE 100
022876248522	AK Evo 760	KSX Pro 150	KS Evo 150	KSE 150
022890248522	AK Evo 900	KSX Pro 300	KS Evo 300	KSE 300

WHITE GOODS

WHY IS IT IMPORTANT TO CHOOSE WHITE GOODS CAREFULLY?

White goods are an essential part of water circulation and lighting functions. It is very important to choose them with care as they are integrated into the pool and therefore contribute to its durability. Amongst our various ranges of skimmers, lights, main drains, etc., you will therefore find the components that are best suited to your pool, regardless of the construction material used (Liner, Concrete, Fibreglass or Panels).

POSITION OF WHITE GOODS

Description	Pool dimensions - Measurements and Quantities									
	8	9	10	10	11	12	12	13	15	
A - Length	4	4	4	5	5	5	6	6	7	
B - Width	50	60	65	75	85	90	105	120	160	
VOL m ³ ~	1	2	2	2	2	3	3	3	4	
SK: skimmer	2	3	3	3	3	4	4	4	6	
R: return fittings	1	1	1	1	1	1	1	1	1 or 2	
BF: main drain	1	1	1	1	1	1	1	1	1	
PB: vacuum fitting, or for automatic cleaning	1	2	2	2	2	2	2	3	4	
P: light										

THE BASICS

Skimmers	Very wide range. Modern, robust design.
Metal inserts	Assembly in under 10 minutes. No maintenance required.
Turbo Jet	Hydro therapy accessories Can be installed in all types of pools.

An underwater photograph of a swimmer in a pool, viewed from above. The water is clear and blue, with sunlight filtering through, creating shimmering patterns on the swimmer's body and the pool floor. The swimmer is in a streamlined position, with arms extended forward and legs back. A white rectangular box is overlaid on the right side of the image, containing the title 'WHITE GOODS' and a table of contents.

WHITE GOODS

SKIMMERS.....	p.40
INLET, FITTINGS AND MAIN DRAINS..	p.41
GRATINGS FOR INFINITY POOLS	p.44
COUNTER-CURRENT EQUIPMENT ..	p.46
COUNTER-CURRENT NOZZLES KIT .	p.47
LIGHTS.....	p.48
FLAT LIGHTS.....	p.49
MICRO LIGHTS	p.50
LIGHT BULBS	p.50
LIGHTING ACCESSORIES.....	p.51
RADIO CONTROL BOXES FOR LEDS..	p.51

SKIMMERS

- » Available for liner, fibreglass and concrete
- » Made of white injected ABS.
- » Inlet connection 1.5" or 63 mm (5 m³/h or 7.5 m³/h)
- » Overflow connection ø 32 mm

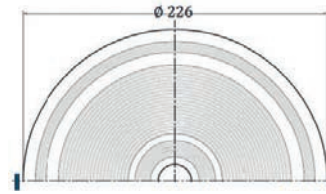

Lid common to all models

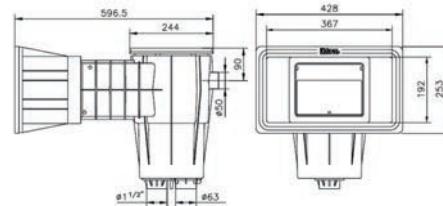
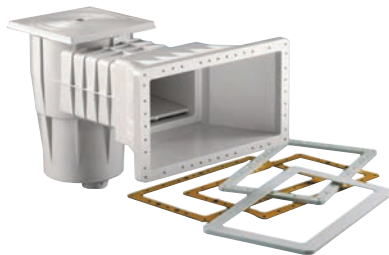
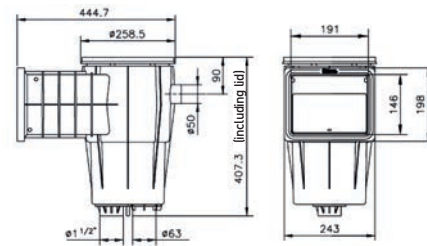

Code	Ref.	Frame	Type of pool	Type of mouth	Connection	Stainless steel insert	Weight (kg)	Vol. (m ³)	C.S.U.
06011010000	SKS	Square	Concrete	Standard	1 1/2" - 63 mm	--	3.3	0.046	1
06011110000	SKA	Square	Concrete	Wide	1 1/2" - 63 mm	--	3.8	0.105	1
06011020000	SKSL	Square	Liner	Standard	1 1/2" - 63 mm	--	6	0.046	1
06011030000	SKSLI	Square	Liner	Standard	1 1/2" - 63 mm	Yes	6	0.046	1
06011120000	SKAL	Square	Liner	Wide	1 1/2" - 63 mm	--	6.5	0.105	1
06011130000	SKALI	Square	Liner	Wide	1 1/2" - 63 mm	Yes	6.5	0.105	1



VERTICAL EXTENSION

VERTICAL EXTENSION FOR SKIMMERS

- » This element is used to adjust the height of the skimmer, so that it is flush with the pool edge.
- » For concrete, liner or fibreglass pools

Code	Model	Height mm	Ø internal mm	Ø external mm
06019000000	EXT	126	218/210	224/218

INLET, FITTINGS AND MAIN DRAINS

POOL BASIN EQUIPMENT

Made of white injected ABS

» INLET

Code	Ref.	Type of pool	Length mm	Ø connect. tube side	Ø connect. return fitting side	Weight (kg)	Vol. (m ³)	C.S.U.
060700001000	PM 51	Concrete	300	2" - 50	2"	3	0.04	12
060700001100	PM 52	Liner	300	2" - 50	2"	3	0.04	12



PM51



PM52

» RETURN FITTINGS - WALL FITTINGS

Code	Ref.	Type of pool	Flow rate l/h	Outlet (mm)/ Standard	Connection Ø	Weight (kg)	Vol. (m ³)	C.S.U.
060500206400	BOF 20	Concrete	5000	20	63 (PN10)	1.2	0.01	4 slip
060500205100	BOF 21	Concrete	5000	20	50 / 40 mm	1.2	0.01	4 slip
060500142000	BOR 14	Concrete	3000	14	2" / 50 mm	1.3	0.01	4 screw-on
060500202000	BOR 20	Concrete	5000	20	2" / 50 mm	1.3	0.01	4 screw-on
060500242000	BOR 24	Concrete	7000	24	2" / 50 mm	1.3	0.01	4 screw-on
060500302000	BOR S	Concrete	7000	EN 13451	2" / 50 mm	1.3	0.01	4 screw-on
060500312000	BOR SF	Concrete	7000	EN 13451	2" / 50 mm	1.3	0.01	4 screw-on
060501142000	BOL 14	Liner	3000	14	2" / 50 mm	1.3	0.01	4 screw-on
060501202000	BOL 20	Liner	5000	20	2" / 50 mm	1.3	0.01	4 screw-on
060501242000	BOL 24	Liner	7000	24	2" / 50 mm	1.3	0.01	4 screw-on
060501302000	BOL S	Liner	7000	EN 13451	2" / 50 mm	1.3	0.01	4 screw-on
060501312000	BOL SF	Liner	7000	EN 13451	2" / 50 mm	1.3	0.01	4 screw-on
060502142000	BOLI 14	Liner	3000	14	2" / 50 mm	1.3	0.01	4 screw-on
060502202000	*BOLI 20	Liner	5000	20	2" / 50 mm	1.3	0.01	4 screw-on
060502242000	*BOLI 24	Liner	7000	24	2" / 50 mm	1.3	0.01	4 screw-on
050502302000	*BOLI S	Liner	7000	EN 13451	2" / 50 mm	1.3	0.01	4 screw-on
060502312000	*BOLI SF	Liner	7000	EN 13451	2" / 50 mm	1.3	0.01	4 screw-on



BOF



BOR



BOR SF



BOR S



BOL



BOL SF



BOL SF

INLET, FITTINGS AND MAIN DRAINS

» SUCTION FITTINGS AT BASE OF WALL

Code	Ref.	Type of pool	Flow rate	Adjustment	Connection	Weight (kg)	Vol. (m ³)	qty/box
060510002000	BIF	Concrete	12000	0 -100%	2" / 50 mm	2.5	0.005	2
060511002000	BIFL	Liner	12000	0 -100%	2" / 50 mm	0.8	0.003	2

* Models with inserts and screws in stainless steel 304, specific to reinforced liners.



BIF



BIFL



BAH / BAL

» PRISE D'EAU DE PAROI (COUNTER-CURRENT SWIMMING)

Grating ø 162 mm. For flow rates equal to or greater than 45 m³/h, install 2 suction fittings

Code	Ref.	Type of pool	Connection	Weight (kg)	Vol. (m ³)	qty/box
062650300000	BPH	Concrete	63 mm / 2.5"	0.3	0.001	1
062650300000	BPL	Fibreglass or Liner	63 mm / 2.5"	0.3	0.001	1

» VACUUM FITTINGS

Code	Ref.	Type of pool	Vacuum connection, poolside, Ø 1 1/2"	For adapter model	Plug	Tubing connection Ø	Weight (kg)	Vol. (m ³)	C.S.U.
060600020000	BLRR	Concrete	Screw-on	RCR38	Thread 1 1/2"	2" / 50 mm	1.5	0.01	4
060610020000	BLL	Liner	Screw-on	RCR38	Thread 1 1/2"	2" / 50 mm	1.5	0.01	4
060620020000	*BLLI	Liner	Screw-on	RCR38	Thread 1 1/2"	2" / 50 mm	1.5	0.01	4
060600150000	BLRE	Concrete	Screw-on	RCR38	Thread 1 1/2"	50 / 40 mm	1.5	0.01	4
060600164000	BFRE	Concrete	Screw-on	RCR38	Thread 1 1/2"	63 (PN10)	1.2	0.01	4

* Models with inserts and screws in stainless steel 304, specific to reinforced liners.



BLRR



BLRE



BLLI (view of base detail)



BLL



BFRE

Code	Ref.	Type of pool	Vacuum connection, poolside, Ø 1 1/2"	For adapter Model	Plug	Tubing connection Ø	Weight (kg)	Vol. (m ³)	C.S.U.
060601020000	BLPR	Concrete	Pressure	RCP38	Rotating lid	2" / 50 mm	1.6	0.01	4
060601150000	BLPE	Concrete	Pressure	RCP38	Rotating lid	50 / 40 mm	1.6	0.01	4

* Models with inserts and screws in stainless steel 304, specific to reinforced liners.



BLPR



BLPE

» MAIN DRAINS FOR RESIDENTIAL POOLS

Code	Ref.	Type of pool	Flow rate l/h	Connection Ø	Weight (kg)	Vol. (m³)	C.S.U.
060201000000	SRP	Concrete	13000	2"	3.5	0.044	1
060202000000	SRPL	Liner	13000	2"	3.5	0.044	1
060203000000	*SRPLI	Liner	13000	2"	3.5	0.044	1
060230000001	ATT	for SRP / SRPL / SRPLI	--	--			1
060230000000	RCD	Grating and faceplate for concrete		--	0.3		1

* Models with inserts and screws in stainless steel 304, specific to reinforced liners.



SRP



INSERTS



RCD



SRPL



ATT

» GUTTER DRAIN AND LEVEL REGULATION

Rectangular plastic grating, fixed with stainless steel screws.

Code	Ref.	Type of pool	Flow rate l/h	Connection Ø	Grating mm	Weight (kg)	Vol. (m³)	C.S.U.
060700000000	BTS	Concrete	7000	63 mm	142*69	1.2	0.005	1



BTS

Automatically replenishes the water lost to filter washing, to evaporation, etc. Square frame and round lid, identical to skimmer elements.

Code	Ref.	Internal connection Ø	External connection Ø	Weight (kg)	Vol. (m³)	C.S.U.
061400000000	RGP	3 / 8"	50	6	0.074	1



RGP

INFINITY POOL GRATINGS

MODULAR GRATING

- » Made of polypropylene with UV-resistant treatment
- » Designed to EN 13451-1
- » 55 elements = 1 metre
- » The modular elements, connect under applied pressure without adhesive

WHITE GOODS

Code	Ref.	Height A (mm)	Width B (mm)	Elements/box	Weight (kg)	Vol. (m³)	C.S.U.
061010202000	NMR2020	20	195	378	8.2	0.053	1
061010252000	NMR2520	20	245	324	8.5	0.053	1
061010302000	NMR3020	20	295	297	8.8	0.053	1
061011202000	NMC2020	20	195	378	7.7	0.053	1
061011252000	NMC2520	20	245	324	8	0.053	1
061011302000	NMC3020	20	295	297	8.5	0.053	1
061010203400	NMR2034	34	195	351	8.3	0.053	1
061010253400	NMR2534	34	245	297	8.7	0.053	1
061010303400	NMR3034	34	295	270	9.4	0.053	1
061011203400	NMC2034	34	195	351	7.8	0.053	1
061011253400	NMC2534	34	245	297	8.2	0.053	1
061011303400	NMC3034	34	295	270	9	0.053	1

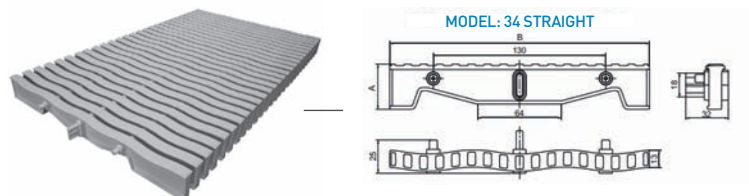
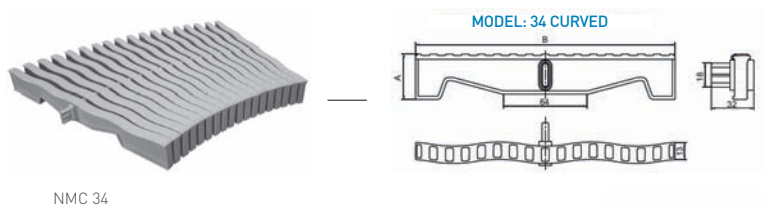
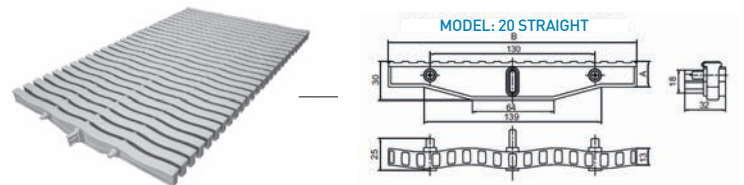
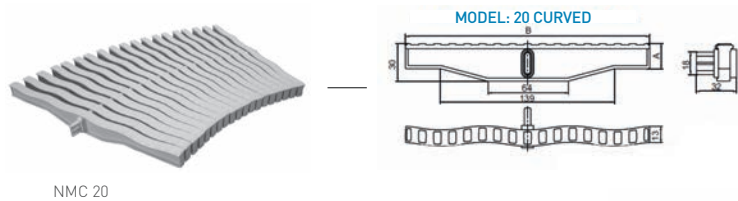

CORNER PIECE FOR INFINITY POOLS

Polyester reinforced with fibreglass, white, nonslip finish

Code	Ref.	Thickness mm (A)	Width mm (B)	Angle	Weight (kg)	Vol. (m ³)	C.S.U.
060990202000	RR200	20	195	90°	2.7	0.006	1
060990252000	RR250	20	245	90°	3.4	0.009	1
060990302000	RR300	20	295	90°	4.6	0.012	1
060990203400	RR201	34	200	90°	3.1	0.009	1
060990253400	RR251	34	250	90°	4.1	0.013	1
060990303400	RR301	34	300	90°	5.1	0.018	1
060945202000	RS200	20	200	45°	1.8	0.006	1
060945252000	RS250	20	250	45°	2.3	0.009	1
060945302000	RS300	20	300	45°	2.8	0.012	1
060945203400	RS201	34	200	45°	1.9	0.009	1
060945253400	RS251	34	250	45°	2.5	0.013	1
060945303400	RS301	34	300	45°	3.1	0.018	1

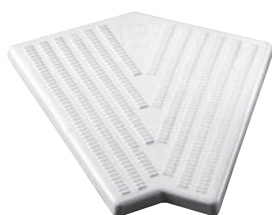

RR



RS

GRATING SUPPORT PROFILE

Code	Ref.	Length /unit	Weight (kg)	Vol. (m ³)	qty/box	C.S.U.
061220000000	MP200	2000 mm	18	0.096	35	1
061220100000	M`P201	2000 mm	18	0.096	35	1
061250000000	MP500	5000 mm	23.5	0.096	35	1

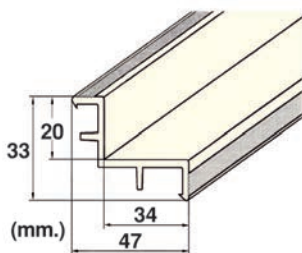

MP 200

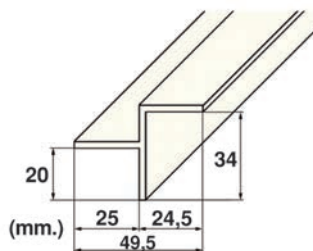

MP 201

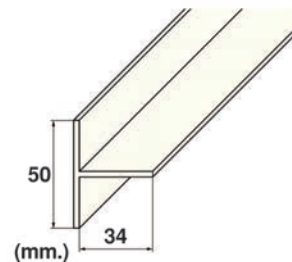

MP 500

COUNTER-CURRENT EQUIPMENT

- » Easy installation, white ABS
- » Different flow rates vary the effort required to swim against the current
- » Equipped with: Front panel (Sena or Calipso), directional return fitting \varnothing 40 mm, recess with check valve and air pipes, electropump, electropneumatic control with automatic reset, complete kit in PVC (pipes not included)
- » Can be used with concrete and liner

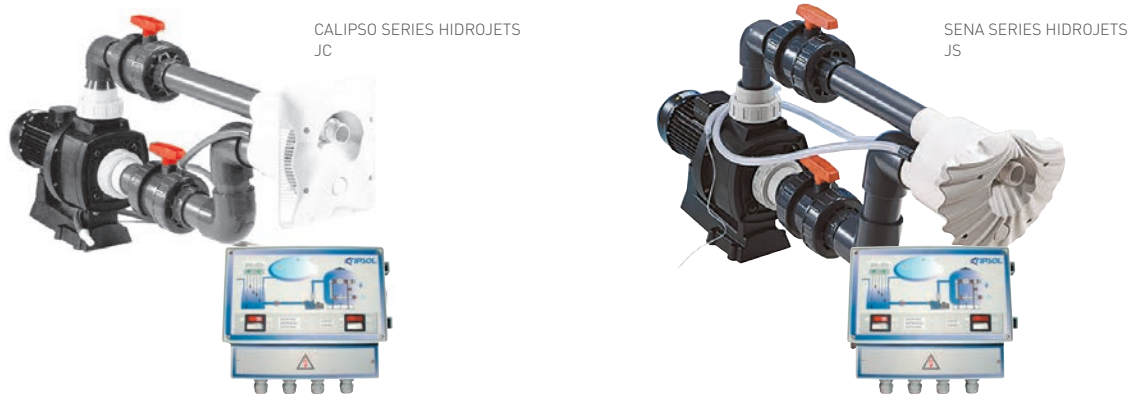

Code	Ref.	INCLUDES				P2 hp	P1 kW	INSTALLATION CLEARANCES			Weight (kg)	Vol. (m ³)	C.S.U.
		Type of faceplate	Recesses for hydro massage jets	Electronic panel	Pump model			Width mm	Length mm	Height mm			
06221150000	JC 40	JC1 062200002000	*JSL2 062100003000	CRCC 1 081006100000	KA 250M 011121120110	2.50	2.30	750	1420	1000	32.8	0.184	1
062231150000	JC 45	JC1 062200002000	*JSL2 062100003000	CRCC 1 081006100000	KA 300M 011131220110	3.00	2.76	750	1420	1000	32.8	0.184	1
062241450000	JC 46	JC1 062200002000	*JSL2 062100003000	CRCC 1 081006100000	KA 300T1 011121250110	3.00	2.76	750	1420	1000	32.8	0.184	1
062251450000	JC 70	JC1 062200002000	*JSL2 062100003000	CRCC 1 081006100000	KA 350T1 011131350110	3.50	3.26	750	1570	1000	36.8	0.184	1
062261550000	JC 78	JC1 062200002000	*JSL2 062100003000	CRCC 1 081006100000	KA 450 T1 011131450110	4.50	4.04	750	1580	1000	36.8	0.184	1
062271550000	JC 88	JC1 062200002000	*JSL2 062100003000	CRCC 1 081006100000	KA 550T1 011151129110	5.50	4.71	750	1580	1000	43.8	0.184	1
062011150000	JS 40	JS1 062000002000	*JSL2 062100003000	CRCC 1 081006100000	KA 250M 011121120110	2.50	2.30	750	1420	1000	32.8	0.184	1
062031150000	JS 45	JS1 062000002000	*JSL2 062100003000	CRCC 1 081006100000	KA 300M 011131220110	3.00	2.76	750	1420	1000	32.8	0.184	1
062041450000	JS 46	JS1 062000002000	*JSL2 062100003000	CRCC 1 081006100000	KA 300T1 011121250110	3.00	2.76	750	1420	1000	32.8	0.184	1
062051450000	JS 70	JS1 062000002000	*JSL2 062100003000	CRCC 1 081006100000	KA 350T1 011131450110	3.50	3.26	750	1570	1000	36.8	0.184	1
062061550000	JS 78	JS1 062000002000	*JSL2 062100003000	CRCC 1 081006100000	KA 450 T1 011131450110	4.50	4.04	750	1580	1000	36.8	0.184	1
062071550000	JS 88	JS1 062000002000	*JSL2 062100003000	CRCC 1 081006100000	KA 550T1 011151129110	5.50	4.71	750	1580	1000	43.8	0.184	1

* Can be used with concrete and liner. Includes joints

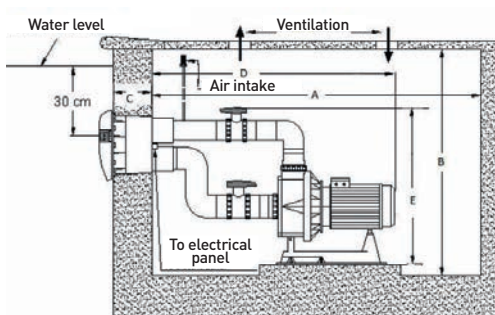

ACCESSORIES

» Piezoelectric Pushbutton Switch

Code	Reference	
980000000040	PPE Pushbutton	
980000000085	CPPE Control panel	
Material		Stainless steel AISI 316, bright polished finish. Screwless faceplate
Supply		1 - 24 V AC/DC.
Current		0.200 A
ON-Resistance		< 20 OHMS
OFF-Resistance		> 5 OHMS
Activation force		3 - 5 N
Reaction time		125 - 300 ms
Operating and storage temperatures		-40 °C to + 125 °C

COUNTER-CURRENT NOZZLES KIT



KCP/KCL/KCH

- » Counter-current nozzle kit comprising: counter-current nozzle, suction fitting, pushbutton and nozzle for air intake.
- » Made of white ABS
- » Easy installation



BAH/BAL



BPH/BPL



BTAH/BTAL

Code	Ref.	Type of pool	Connection Return fitting	Intake Connection	INCLUDES			Weight (kg)	Vol. (m ³)	C.S.U.
					Suction fitting	Pushbutton fitting	Air intake			
062610100000	KCH	Concrete	Ø 50 mm	63 mm / 2 1/2"	BAH 062630100000	BPH 062640200000	BTAH 062640100000	2.1	0.009	1
062610200000	KCP	Fibreglass	Ø 50 mm	63 mm / 2 1/2"	*BAL 062630300000	BPL 062650300000	BTAL 062640300000	2.1	0.009	1
062610300000	KCL	Liner	Ø 50 mm	63 mm / 2 1/2"	*BAL 062630300000	BPL 062650300000	BTAL 062640300000	2.1	0.009	1

* Includes joints and screws

LIGHTING

LED LIGHTS WITH RECESS

- » Recess, bulb holder and faceplate in white ABS.
Light attachment - recess with two A2 stainless steel screws. Cable gland and conduit connection in M20.
- » For halogen lights delivered outside Europe, please enquire
- » "M"-assembled models with cables and conduits, and unassembled models (cable and conduit not supplied)

Technical Specifications

Light bulbs	13 W/12 V
Light models	White light and coloured light
Remote control	Included in the colour models
LED lifespan	30,000 hours
Hours of operation	10,000 hours

IP68 waterproof

PHB/PHBM



PLB/PLBM



PHC/PHCM



PLC/PLCM



Code	Ref.	Type of pool	Type of light	Bulb	Lumens	Weight (kg)	Vol. (m ³)	qty/pallet	C.S.U.
061511213000	PHB 13	Concrete	White	13 W / 12 V	1200 +/-10%	1.5	0.022	72	1
061511113200	*PHBM 13	Concrete	White	13 W / 12 V	1200 +/-10%	2	0.022	72	1
061512213000	PHC 13	Concrete	11 Colours	13 W / 12 V	400 +/-10%	1.5	0.022	72	1
061512113200	*PHCM 13	Concrete	11 Colours	13 W / 12 V	400 +/-10%	2	0.022	72	1
061521213010	PLB 13	Fibreglass liner	White	13 W / 12 V	1200 +/-10%	1.5	0.022	72	1
061521113200	*PLBM 13	Fibreglass liner	White	13 W / 12 V	1200 +/-10%	2	0.022	72	1
061522213010	PLC 13	Fibreglass liner	11 Colours	13 W / 12 V	400 +/-10%	1.5	0.022	72	1
061522113200	*PLCM 13	Fibreglass liner	11 Colours	13 W / 12 V	400 +/-10%	2	0.022	72	1

* Assembled lights. Cable (2 x 1.5 mm) and conduit included

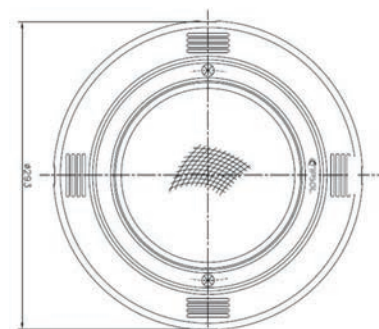
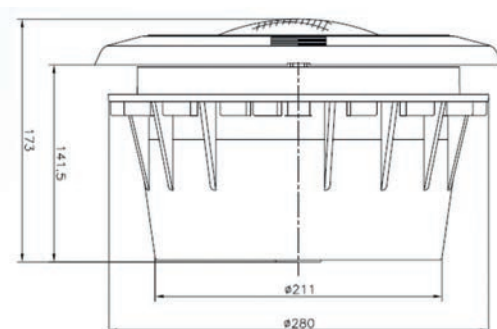

FLAT LIGHTS

SOLUTIONS FOR ALL REQUIREMENTS

- » Made of white injected ABS
- » Material unaffected by physical or chemical agents
- » Transparent polycarbonate lens
- » For halogen lights delivered outside Europe, please enquire
- » IP68 waterproof



WHITE GOODS

Code	Ref.	Type of pool	Type of light	Installation	Bulb	Lumens	Lifespan (Hours)	No. LEDs	Weight (kg)	Vol. (m³)	C.S.U.
061611100000	PEH 110	Concrete	White	Screws	25 W / 12 V	1695 +/-10%	10 000	15	1.1	0.005	1
061611101000	PEH 111	Concrete	White	Wall conduit	25 W / 12 V	1695 +/-10%	10 000	15	1.8	0.011	1
061611150000	PEH 115	Concrete	11 Colours	Screws	18 W / 12 V	402 +/-10%	10 000	72	1.1	0.005	1
061611151000	PEH 116	Concrete	11 colours	Wall conduit	18 W / 12 V	402 +/-10%	10 000	72	1.8	0.011	1
061621101000	PEP 110	Fibreglass	White	Screws	25 W / 12 V	1695 +/-10%	10 000	15	1.8	0.011	1
061621100000	PEP 111	Fibreglass	White	Screw-on	25 W / 12 V	1695 +/-10%	10 000	15	1.8	0.011	1
061631101000	PEL 110	Liner	White	Screws	25 W / 12 V	1695 +/-10%	10 000	15	1.8	0.011	1
061621151000	PEP 115	Fibreglass	11 colours	Screws	18 W / 12 V	402 +/-10%	10 000	72	1.8	0.011	1
061621150000	PEP 116	Fibreglass	11 colours	Screw-on	18 W / 12 V	402 +/-10%	10 000	72	1.8	0.011	1
061631151000	PEL 115	Liner	11 colours	Screws	18 W / 12 V	402 +/-10%	10 000	72	1.8	0.011	1

Supplied with 3 metres of 2*1.5 Ø 8 mm cable.

Screw attachment for **PEH110** and **PEH115**
Screws and raw/plugs included

Wall conduit attachment **PEH111** and **PEH116**
with special 2" element (included)

Screw attachment **PEL110** and **PEL115** for fibreglass
with joints and ring

Threaded attachment **PEP111** and **PEP116** for fibreglass
with special 2" element (included)

Screw attachment **PEL110** and **PEL115** for liner
includes washers and special 2" element

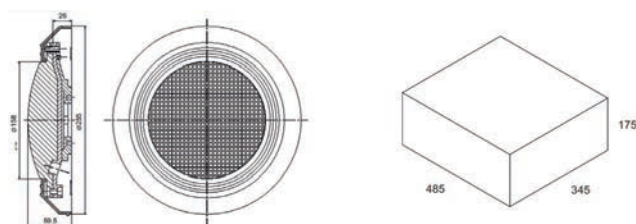

MINI LIGHTS

WITH LEDS



MIPC

MIPW

Technical Specifications	
Maximum consumption	4.5 W+/-10% (MIPW) 5.5 W+/-10% (MIPC)
Number of LEDs	30 LEDs (MIPW) 36 LED (MIPC)
Lumens	130 lumens +/-10% (MIPC) 400 lumens +/-10% (MIPW)
Protection	IP68 waterproof

No.	Model
1	MIPW.C - MIPC.C
2	APM.C
3	**PM51.C
4	SPM.C

** Refer to page 41

- » Made of polycarbonate and injected ABS, resistant to and unaffected by chemicals
- » Back-threaded 1.5" screw for assembly in wall conduits, supplied with 2 x 1.5 mm² cable
- » Single-setting white bulb, and coloured bulb with 5 automatic settings and 11 colours

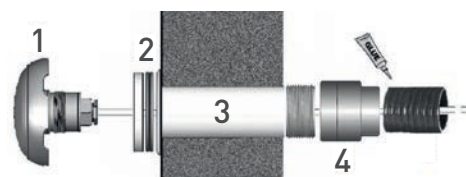

Model	Code	Light colour	Remote control supplied	Supply	Bulb lifespan (hours)	Weight (kg)	Vol. (m ³)	qty/box
MIPW.C	061300005000	White	No	12 V AC	30 000	0.550	0.003	1
MIPC.C	061300005100	Colour	No	12 V AC	30 000	0.550	0.003	1

Model	Code	Description	Weight (kg)	Vol. (m ³)	qty/box
APM.C	061300007000	Adaptor F 1 1/2" x M2" /	0.020	0.025	1
SPM.C	061300008000	Mixed connector 2" x 50 mm	0.025	0.025	1
KIPM.C	061300006000	Elements No. 2+3+4	0.165	0.065	1

BULB



LPC

LPW

Technical Specifications	
Maximum consumption	17.5 W+/-10% (LPW13) 18 W+/-10% (LPC13;LPC14)
Number of LEDs	30 LEDs (LPW13) 270 LEDs ultra bright SMD (LPC13,LPC14)
Lumens	1360 lumens +/-10% (LPW13) 510 lumens +/-10% (LPC13;LPC14)
Protection	IP68 waterproof

- » ABS casing with moulded threads for screws inserted through to the main body
- » Homogeneous diffusion of light through the water
- » Single-setting white bulb, and coloured bulb with 5 automatic settings and 11 colours

Code	Ref.	Type of light	Remote control supplied	Supply	Bulb lifespan (h)	Weight (kg)	Vol. (m ³)	C.S.U.
061852131200	LPW 13	3 000	No	12 V AC	30 000	0.4	0.0056	1
061853141200	LPC 14	5 000	No	12 V AC	30 000	0.4	0.0056	1
061853131200	LPC 13	7 000	RCO 04	12 V AC	30 000	0.45	0.0056	1

ACCESSORIES FOR LIGHTING



CX



MG100 / MG300



PCF20

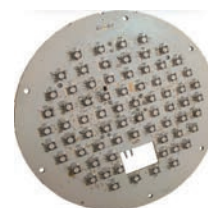

LP115

Code	Ref.	2 x 1.5 mm ² cable	Ø external mm	Voltage drop VA/km	Weight (kg)	Vol. (m ³)	C.S.U.
890120150301	*MG 100	100	8.2	--	10.7	--	1
890120600101	*MG 300	100	13.5	7.66	29	--	1
061850151210	LP 115	Light bulb with 11 colours and flat LED			0.2	0.001	1
061850351200	LP 110	Light with white LED			0.2	0.001	1
061300003200	PCF 20	Conduit M20x3/4"			0.5	0.006	1
061300002000	CX	Junction box			1.7	0.01	1

*Extra-flexible hose.

MG 300 CABLE FOR 300 W SPOTLIGHT

Resistant to: bad weather, immersion in water (AD8) and chemicals (mineral oils and hydrocarbons). Electrolytic annealed copper wire, class 5/6 complying with IEC 60228. Rubber insulation, class EL4, complying with HD22. Covered with back rubber, class M2, complying with HD22 Operating voltage 0.6/1 kV.

MG 100 CABLE FOR 100 W FLAT SPOTLIGHT

Standard UNE 21123. Resistant to: bad weather, immersion in water and grease, oils and hydrocarbons. Insulation: comprising Type II flexible P.V.C.. Conductor: copper wire certified as class 5 as per standard UNE 21022. Covering: comprising flexible P.V.C. modified with ACN-type NBR Nominal voltage 0.6/1 kV.

RADIO CONTROL BOXES FOR LEDS



RC014



RC018



SOM6 Y SCOM12

Code	Ref.	Channels	Max. no. bulbs	Control model	Power W	Amperage	Weight (kg)	Vol. (m ³)	C.S.U.
061910060000	*SCOM6	1	6	RCO 14	120	20 A max	0.28	0.0011	1
061910120000	*SCOM12	4	12	RCO 18	240	20 A max	0.72	0.0025	1
061850151210	LP 115	1-Channel control box					0.05	0.009	1
061850351200	LP 110	4-Channel control box					0.05	0.009	1

* Maximum 6 bulbs on 1 channel. Operating temperatures -40 °C/+70 °C. Humidity 10% to 90%

POOL SURROUNDING EQUIPMENT

THE HARD-WEARING SOLUTION WITH A SPECIAL TOUCH

Ladders, showers, handrails, ... add the finishing touch to your pool equipment with products that have unrivalled class, and be safe in the knowledge that they will withstand use over time. Opt for greater reassurance by installing our stainless steel products, the norm for the Kripsol brand name, which exceed the expectations of our most discerning customers. Our design philosophy is always focused on user safety: all products in our pool surround equipment range are approved for connection to an equipotential network, whether through the anchor or through the flange, and our built-in ladders can be equipped with a double safety step to avoid accidents on the rungs. Of course, all our steps have a non-slip surface.



POOL SURROUNDING EQUIPMENT

LADDERS.....	p.54
LADDER ACCESSORIES.....	p.57
SHOWERS.....	p.60
SAFETY EQUIPMENT.....	p.64
WATER FEATURES.....	p.66

LADDERS

HARD-WEARING, WITH AN EXCEPTIONAL FINISH

Technical Specifications

Materials	Stainless steel with bright polished finish, AISI 304 or AISI 316
Tubing diameter	Ø 43 mm
Includes	Non-slip steps, tubing plugs, anchors with earth connection, screws and escutcheon plates.

» STANDARD LADDERS

Code	Ref.	AISI stainless steel	No. steps	Weight (kg)	Vol. (m ³)	qty/pallet	C.S.U.	DIMENSIONS MM		
								Depth	Width	Height
070101020000	PI 2	304	2	10	0.078	14	1	650	500	1330
070101030000	PI 3	304	3	11.5	0.091	14	1	650	500	1580
070101040000	PI 4	304	4	13.5	0.104	14	1	650	500	1830
070101050000	PI 5	304	5	15	0.117	14	1	650	500	2080
070110020000	IP 2	316	2	10	0.078	14	1	650	500	1330
070110030000	IP 3	316	3	11.5	0.091	14	1	650	500	1580
070110040000	IP 4	316	4	13.5	0.104	14	1	650	500	1830
070110050000	IP 5	316	5	15	0.117	14	1	650	500	2080

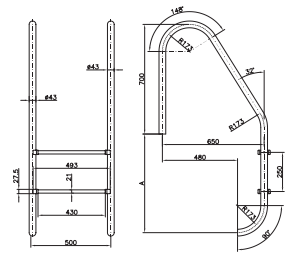

» STRAIGHT LADDERS

Code	Ref.	AISI stainless steel	No. steps	Weight (kg)	Vol. (m ³)	qty/pallet	C.S.U.	DIMENSIONS MM		
								Depth	Width	Height
070201020000	MI 2	304	2	9.5	0.051	20	1	346	500	1330
070201030000	MI 3	304	3	10.5	0.06	20	1	346	500	1580
070201040000	MI 4	304	4	12.5	0.067	20	1	346	500	1830
070201050000	MI 5	304	5	14	0.076	20	1	346	500	2080
070210020000	IM 2	316	2	9.5	0.051	20	1	346	500	1330
070210030000	IM 3	316	3	10.5	0.06	20	1	346	500	1580
070210040000	IM 4	316	4	12.5	0.067	20	1	346	500	1830
070210050000	IM 5	316	5	14	0.076	20	1	346	500	2080

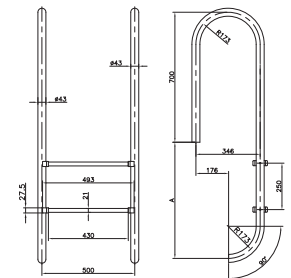

» MIXED LADDERS

Code	Ref.	Stainless steel	No. steps	Weight (kg)	Vol. (m ³)	qty/pallet	C.S.U.	DIMENSIONS MM		
								Depth	Width	Height
070301020000	MXI 2	304	2	10	0.078	14	1	346	500	1105
070301030000	MXI 3	304	3	11.5	0.091	14	1	346	500	1355
070301040000	MXI 4	304	4	13.5	0.104	14	1	346	500	1605
070301050000	MXI 5	304	5	15	0.117	14	1	346	500	1855
070310020000	IMX 2	316	2	10	0.078	14	1	346	500	1105
070310030000	IMX 3	316	3	11.5	0.091	14	1	346	500	1355
070310040000	IMX 4	316	4	13.5	0.104	14	1	346	500	1605
070310050000	IMX 5	316	5	15	0.117	14	1	346	500	1855

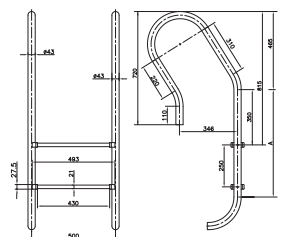

» ASYMMETRIC STANDARD LADDERS

Code	Ref.	Stainless steel	No. steps	Weight (kg)	Vol. (m ³)	qty/pallet	C.S.U.	DIMENSIONS MM		
								Depth	Width	Height
070102030000	SAI 3	304	3	12	0.104	14	1	650	500	1830
070102040000	SAI 4	304	4	14	0.117	14	1	650	500	2080
070102050000	SAI 5	304	5	--	0.267	14	1	650	500	2330

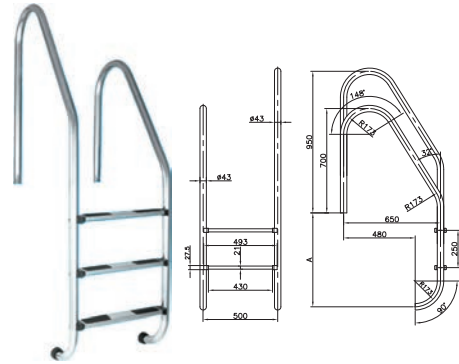

» ASYMMETRIC STRAIGHT LADDERS

Code	Ref.	Stainless steel	No. steps	Weight (kg)	Vol. (m ³)	qty/pallet	C.S.U.	DIMENSIONS MM		
								Depth	Width	Height
070202030000	MAI 3	304	3	11	0.067	20	1	346	500	1830
070202040000	MAI 4	304	4	13	0.076	20	1	346	500	2080
070202050000	MAI 5	304	5	--	0.089	20	1	346	500	2330

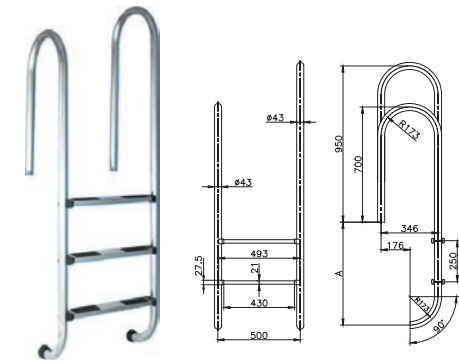

» MUNICH LADDERS

Code	Ref.	Stainless steel	No. steps	Weight (kg)	Vol. (m ³)	qty/pallet	C.S.U.	DIMENSIONS MM		
								Depth	Width	Height
070401020000	EMI 2	304	2	11	0.099	13	1	900	500	1350
070401030000	EMI 3	304	3	13	0.116	13	1	900	500	1600
070401040000	EMI 4	304	4	15	0.134	13	1	900	500	1850
070401050000	EMI 5	304	5	17.5	0.151	13	1	900	500	2100
070410020000	IEM 2	316	2	11	0.099	13	1	900	500	1350
070410030000	IEM 3	316	3	13	0.116	13	1	900	500	1600
070410040000	IEM 4	316	4	15	0.134	13	1	900	500	1850
070410050000	IEM 5	316	5	17.5	0.151	13	1	900	500	2100

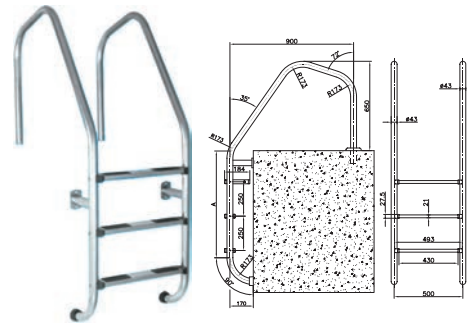

» TWO-PART LADDERS

Code	Ref.	Stainless steel	No. steps	Weight (kg)	Vol. (m ³)	qty/pallet	C.S.U.	DIMENSIONS MM		
								Depth	Width	Height
070501020000	DPI 2	304	2	9.5	0.108	10	1	480/170	500	1450
070501030000	DPI 3	304	3	11	0.108	10	1	480/170	500	1700
070501040000	DPI 4	304	4	12.5	0.108	10	1	480/170	500	1950
070501050000	DPI 5	304	5	14	0.159	10	1	480/170	500	2200
070510020000	IDP 2	316	2	9.5	0.108	10	1	480/170	500	1450
070510030000	IDP 3	316	3	11	0.108	10	1	480/170	500	1700
070510040000	IDP 4	316	4	12.5	0.108	10	1	480/170	500	1950
070510050000	IDP 5	316	5	14	0.159	10	1	480/170	500	2200

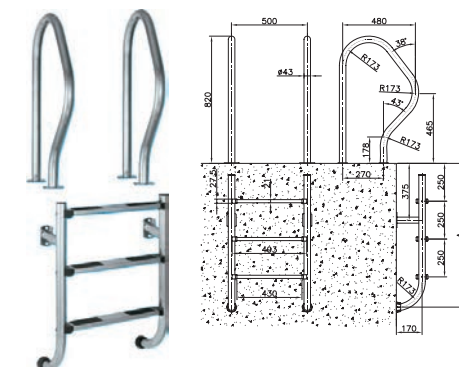

LADDERS

» EASY ACCESS LADDERS

Code	Ref.	Stainless steel	No. steps	Weight (kg)	Vol. (m ³)	qty/pallet	C.S.U.	DIMENSIONS MM		
								Depth	Width	Height
070810230000	EAJ 3	316	3	16	0.19	--	1	1000	500	1472
070810240000	EAJ 4	316	4	17	0.24	--	1	1000	500	1692



» SEMI INGROUND POOL LADDERS

Code	Ref.	Stainless steel	No. steps	Weight (kg)	Vol. (m ³)	qty/pallet	C.S.U.	DIMENSIONS MM		
								Depth	Width	Height
070601530000	ESP 3	304/ABS	3+1	17.5	0.137	--	1	820	710	1577
070601540000	ESP 4	304/ABS	4+1	18.7	0.137	--	1	920	710	1827
070601550000	ESP 5	304/ABS	5+1	19.8	0.153	--	1	1020	710	2077

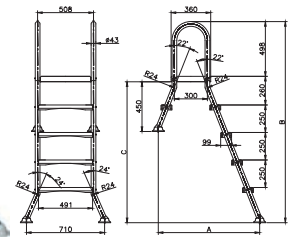

» ABOVE GROUND POOL LADDERS

Code	Ref.	Stainless steel	No. steps	Weight (kg)	Vol. (m ³)	qty/pallet	C.S.U.	DIMENSIONS MM		
								Depth	Width	Height
070701530000	EEP 3	304/ABS	3+3	20	0.137	--	1	1052	710	1577
070701540000	EEP 4	304/ABS	4+4	21.5	0.137	--	1	1250	710	1827
070701550000	EEP 5	304/ABS	5+5	24.8	0.153	--	1	1448	710	2077

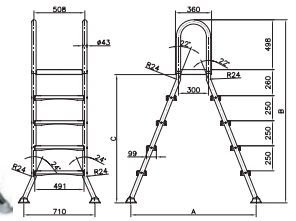
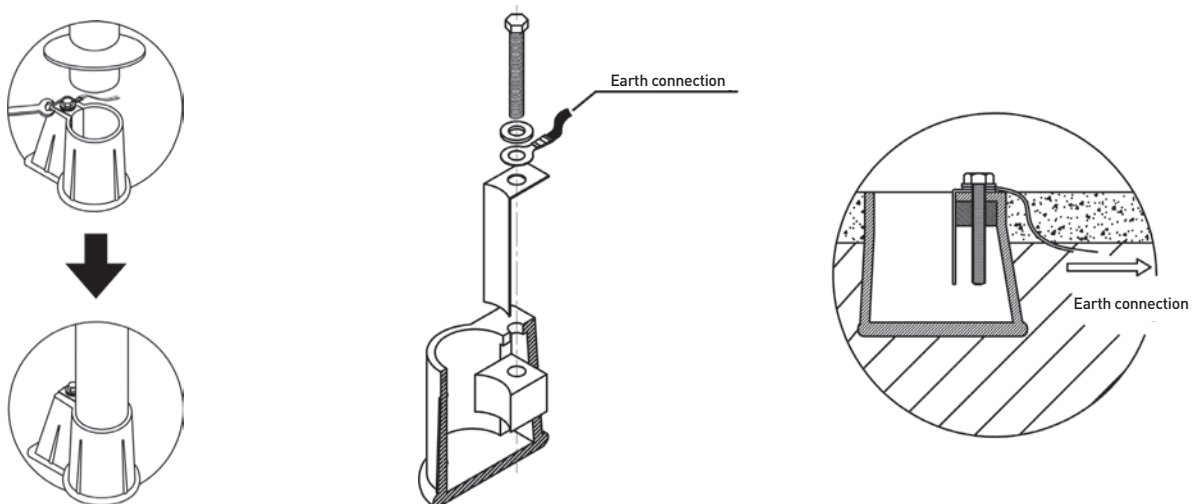

DIAGRAM SHOWING INSTALLATION OF THE LADDERS ON THE POOL EQUIPOTENTIAL NETWORK OR EARTHING SYSTEM



LADDER ACCESSORIES

» EXIT GRAB RAILS FOR TWO-PART LADDERS

Code	Ref.	Stainless steel	Units	Tubing Ø mm	Weight (kg)	Vol. (m³)	C.S.U.
070501000100	DP 1	304	2	43	7.5	0.072	1
070510000100	PD 1	316	2	43	7.5	0.072	1

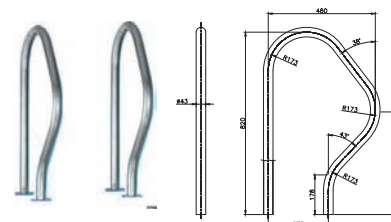

DP 1 / PD 1

» UNIVERSAL ANCHORS WITH FLANGES

Code	Ref.	Stainless steel	Type of anchor	Units	Tubing Ø mm	Height mm	Weight (kg)	Vol. (m³)	C.S.U.
071501103040	AB 1	304	Fixed	1	40	150	0.5	0.015	1
071501203160	AB 2	316	Folding	1	40	150	0.7	0.015	1

Compatible with the STANDARD, STRAIGHT, ASYMMETRIC and MIXED ranges.
Screws, washers, rawlplugs and elastic joints included.



AB 2

This allows the ladder to be pivoted upwards, without removing it completely, to free up the pool basin for all kinds of other operations.



AB 1

Allows the ladder to be removed manually without the use of tools.

» SAFETY STEP

The safety step is made up of a pair of non-slip surfaces.
All our ladder models are compatible with incorporation of this step.
It can also be added to ladders that are already installed.
Complies with the European standards EN-13451-1 and EN-13451-2

Code	Ref.	Stainless steel	Weight (kg)	Vol. (m³)	C.S.U.
071502304000	RES 014	304	9.5	--	1
071502316000	RES 021	316	9.5	--	1



RES 014 / RES 017

LADDER ACCESSORIES

STAINLESS STEEL GRAB RAILS

- » Made of bright polished AISI 304 stainless steel.
- » Attachment with flanges and screws, or built-in.
- » Models with flanges are supplied with joints, rawlplugs and screws.

Code	Ref.	Stainless steel	Length A mm	Height B mm	Tubing Ø mm	Attachment	Weight (kg)	Vol. (m³)	C.S.U.
073510050000	AS 050	304	500	120	43	Built-in	2	0.019	1
073510100000	AS 100	304	1 000	120	43	Built-in	3.8	0.039	1
073510200000	AS 200	304	2 000	120	43	Built-in	7.5	0.072	1
073510250000	AS 250	304	2 500	120	43	Built-in	9	0.089	1
073510051000	AS 051	304	500	120	43	Screws	2.9	0.023	1
073510101000	AS 101	304	1 000	120	43	Screws	4.2	0.039	1
073510201000	AS 201	304	2 000	120	43	Screws	7.9	0.088	1
073510251000	AS 251	304	2 500	120	43	Screws	9.6	0.109	1

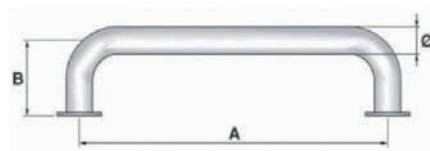

AS 050/100/200/250



AS 051/101/201/251

STAINLESS STEEL HANDRAILS

- » Made of bright polished AISI 304 stainless steel
- » Attachment with flanges and screws, or built-in
- » Models with flanges are supplied with joints, rawlplugs and screws.

Code	Ref.	Stainless steel	Length L mm	Height A mm	Tubing Ø mm	Attachment	Weight (kg)	Vol. (m ³)	C.S.U.
073601120000	BP 1200	304	1,220	800	43	Built-in	8.2	0.136	1
073601150000	BP 1500	304	1,524	800	43	Built-in	9.1	0.159	1
073601120001	BP 1201	304	1,220	800	43	Screws	8.2	0.136	1
073601150001	BP 1501	304	1,524	800	43	Screws	9.1	0.159	1
073601123500	BPFE 1200	316	1,235	772	43	Built-in	8	-	1
073601123501	BPFE 1201	316	1,235	772	43	Screws	8	-	1

Built-in handrails are supplied with an anchor featuring a connector to an equipotential network.



BP 1200/1500



BP 1201/1501

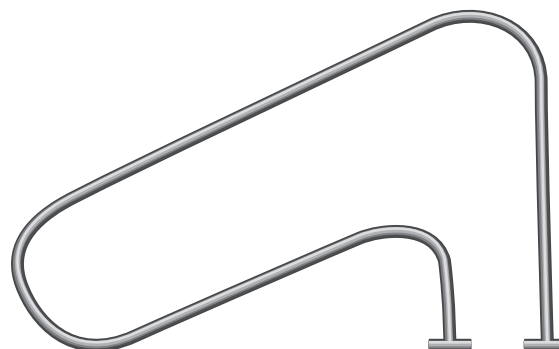

BPFE 1200/1201

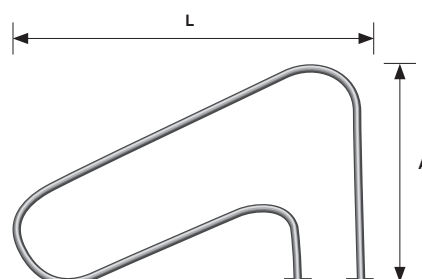
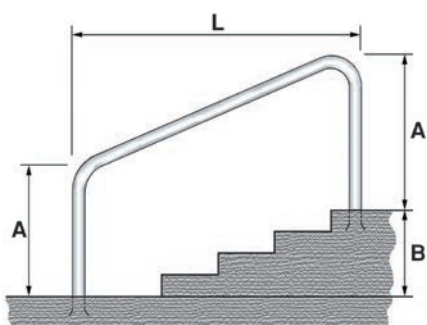

SHOWERS

BASTON SHOWERS

- » Elegant and hard-wearing
- » Made of bright polished AISI 304 and AISI 316 stainless steel
- » Anchor with integrated earthing connection



DB 100 / DB 300
without foot wash

DB 101 / DB 301
with foot wash

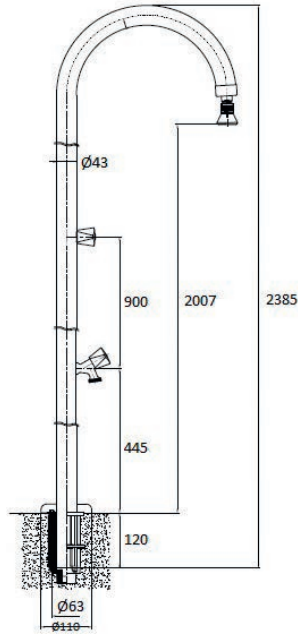

Code	Ref.	Stainless steel	Connection	Tubing Ø mm	Weight (kg)	Vol. (m³)	C.S.U.
072101010000	DB 100	AISI 304	1 1/2"	43	15.5	0.1	2
072110010000	DB 300	AISI 304	1 1/2"	43	15.5	0.1	2
072101100000	DB 101	AISI 316	1 1/2"	43	16	0.1	2
072110100000	DB 301	AISI 316	1 1/2"	43	16	0.1	2

ANCHOR ADAPTOR FOR MODIFICATION FROM A BASTON SHOWER TO A SINGLE TETRA SHOWER

Code	Ref.	Description	Ø	Height mm	Weight (kg)	Vol. (m³)	C.S.U.
072590043100	AT 43S	Anchor	1/2"	145	0.2	0.001	1



TETRA SHOWERS

- » Modern design with one or more shower heads
- » Made of bright polished AISI 304 stainless steel
- » Attached with screws (included)
- » Models with or without a foot wash
- » Manual or Automatic



Code	Ref.	Type	Foot wash	Connection	Pipe dimensions	Stainless steel	No. shower heads	Weight (kg)	Vol. (m ³)	C.S.U.
SINGLE TETRA SHOWER										
072510010000	DT 100	Manual	No	1/2"	60*60	304	1	8	0.054	1
072510030000	DT 110	Automatic	No	1/2"	60*60	304	1	8	0.054	1
072510020000	DT 101	Manual	Yes	1/2"	60*60	304	1	8	0.054	1
072510040000	DT 111	Automatic	Yes	1/2"	60*60	304	1	8.2	0.054	1
DOUBLE TETRA SHOWER										
072520010000	DT 200	Manual	No	1/2"	120*60	304	2	17	0.09	1
072520030000	DT 210	Automatic	No	1/2"	120*60	304	2	17	0.09	1
072520020000	DT 202	Manual	Yes	1/2"	120*60	304	2	17.5	0.09	1
072520040000	DT 212	Automatic	Yes	1/2"	120*60	304	2	17.5	0.09	1
QUADRUPLE TETRA SHOWER										
072540040000	DT 410	Manual	No	3/4"	120*120	304	4	20	0.18	1
TETRA FOOT WASH										
072500020000	DT 012	Automatic	Yes	1/2"	120*60	304	2	6	0.027	1
TETRA HOT WATER/COLD WATER SHOWER										
072511010000	DTC 100	Manual	No	2x1/2"	120*60	304	1	17	0.09	1
072511020000	DTC 110	Automatic	No	2x1/2"	120*60	304	1	17	0.09	1
TETRA SHOWER ARCH										
072701030000	ADT 103	Manual	No	1/2" - 3/4"	60*60	304	3	18	0.09	1
072701050000	ADT 105	Manual	No	1/2" - 3/4"	60*60	304	5	20	0.09	1
072701130000	ADT 113	Automatic	No	1/2" - 3/4"	60*60	304	3	22	0.09	1
072701150000	ADT 115	Automatic	No	1/2" - 3/4"	60*60	304	5	24	0.09	1

SHOWERS

TETRA SHOWER ACCESSORIES

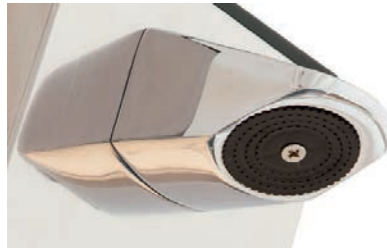

Code	Ref.	Description	Width	Height mm	Weight (kg)	Vol. (m³)	C.S.U.
072590060000	AT 60	Anchor for single Tetra shower	130*130	180	1	0.03	1
072590120000	AT 120	Anchor for double Tetra shower	250*250	180	1.3	0.113	1
500725000201	RSH00002.01R	Tetra shower head			-	-	1
500725000221	RSH00002.21R	Grille for Tetra shower head			-	-	1
500725000301	RSH00003.01R	Manual Tap Kit			-	-	1
500725000302	RSH00003.02R	Automatic Tap Kit			-	-	1
500725000401	RSH00004.01R	Manual Foot Wash Tap Kit			-	-	1
500725000402	RSH00004.02R	Automatic Foot Wash Tap Kit			-	-	1



SOLAR SHOWERS

- » Made of aluminium with anti-corrosion treatment
- » Freeze-resistant internal water circuit (down to -15 °C)
- » Features two controls (cold water and hot water)
- » Available with or without foot wash tap and in various colours

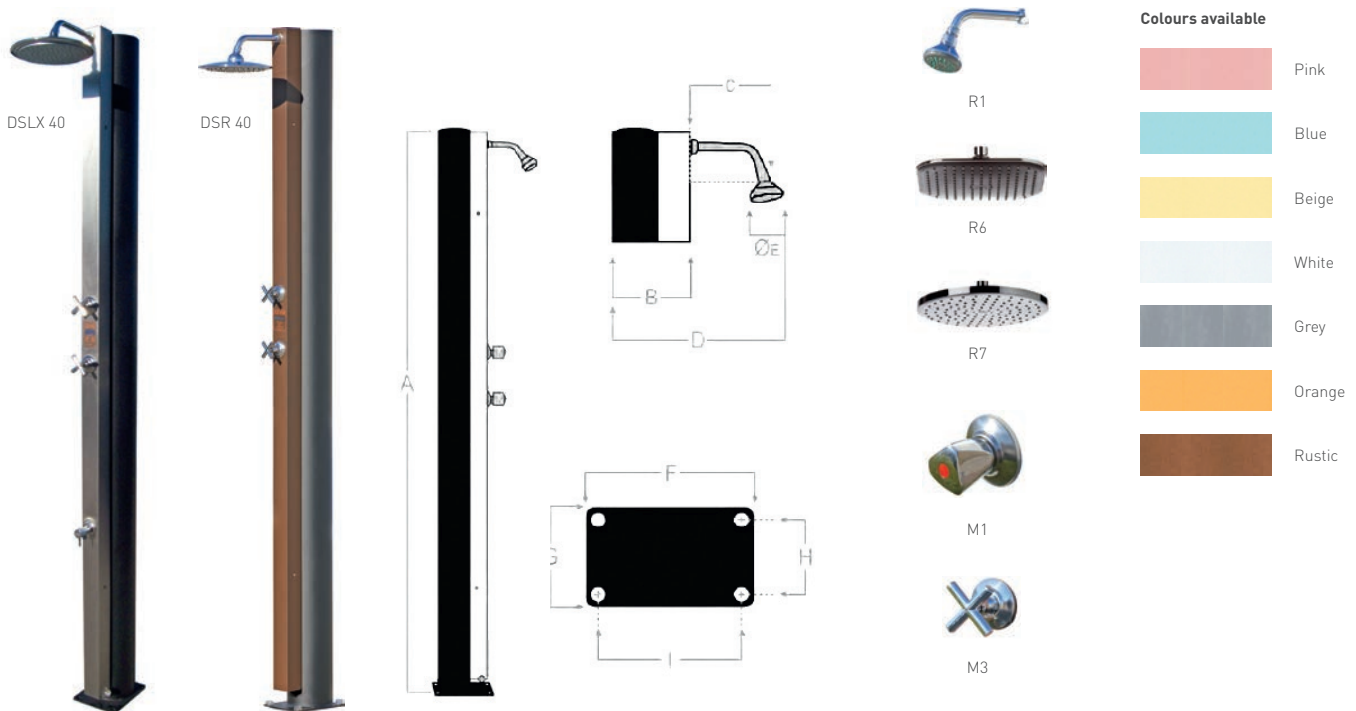

Code	Ref.	Facing element finish	Foot wash	Connection	Capacity litres	Type of shower head	Tap Ref.	DIMENSIONS MM										Weight (kg)	C.S.U.
								A	B	C	D	ØE	F	G	H	I			
073001300000	DSB 30	White zinc-coated steel	No	1/2"	30	R1	M1	2205	185	152	385	70	202	150	115	168	8.1	1	
073001400000	DSB 40	White zinc-coated steel	No	1/2"	40	R6	M3	2205	210	184	470	160	221	175	140	187	10	1	
073002300000	DSR 30	Rustic zinc-coated steel	No	1/2"	30	R1	M3	2205	185	184	450	160	202	150	115	168	8.1	1	
073002400000	DSR 40	Rustic zinc-coated steel	No	1/2"	40	R7	M3	2205	205	184	515	240	221	175	140	187	10	1	
073003300000	DSX 30	Stainless steel	No	1/2"	30	R1	M3	2205	178	184	438	160	202	150	115	168	8.1	1	
073003400000	DSX 40	Stainless steel	No	1/2"	40	R7	M3	2205	210	184	520	240	221	175	140	187	10	1	
073001300100	*DSLX 30	White zinc-coated steel	Yes	1/2"	30	R1	M1	2205	185	152	385	70	202	150	115	168	8.1	1	
073001400100	*DSLX 40	White zinc-coated steel	Yes	1/2"	40	R6	M3	2205	210	184	470	160	221	175	140	187	10	1	
073002300100	*DSLX 30	Rustic zinc-coated steel	Yes	1/2"	30	R1	M3	2205	185	184	450	160	202	150	115	168	8.1	1	
073002400100	*DSLX 40	Rustic zinc-coated steel	Yes	1/2"	40	R7	M3	2205	205	184	515	240	221	175	140	187	10	1	
073003300100	*DSLX 30	Stainless steel	Yes	1/2"	30	R1	M3	2205	178	184	438	160	202	150	115	168	8.1	1	
073003400100	*DSLX 40	Stainless steel	Yes	1/2"	40	R7	M3	2205	210	184	520	240	221	175	140	187	10	1	

* Foot wash tap included

SAFETY EQUIPMENT

LIFE RING AND SUPPORTS

Code	Ref.	Description	Weight (kg)	Vol. (m ³)	C.S.U.
073700000000	SVP	Life ring Ø 73	3	0.055	1
073710000000	SVS	Stainless steel bracket screwed to the wall	1.2	0.009	1
073711000000	SW	Ø 43 x 1000 mm stand with footing	3.1	0.02	1



SVS



SVP



SW



WATER FEATURES

- » A touch of excellence for your pool
- » Made of AISI 316 stainless steel
- » All water features must be connected to an equipotential network



DSLX 40

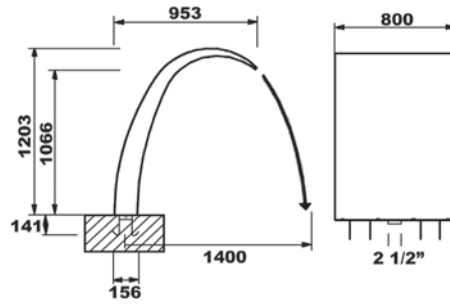

Code	Ref.	Description	Stainless steel	Anchor	Connection	Flow rate m ³ /h	Width mm	Height mm	Weight (kg)	Vol. (m ³)	C.S.U.
074020080010	CVIC 800	Victoria waterfall	316	Supplied	2-1/2"	50	800	1203	130	1.145	1
074030030010	CMAU 300	Mau Mini waterfall	316	Not required	1"	10	300	250	3	0.0018	1
074030050010	CMAU 500	Mau Mini waterfall	316	Not required	1"	20	500	250	4	0.0036	1
074030100010	CMAU 1000	Mau Mini waterfall	316	Not required	-	35	1000	250	6.5	0.0068	1
074010035101	CBAM 351	Bali Mini waterfall	304	Not required	1-1/25"	20	350	480	14	0.086	1
074010050010	CBA 500	Bali waterfall	316 bright polished finish	Not included (CBAAN)	-	30	500	688	24.8	0.28	1
074010050110	CBA 501	Bali waterfall	316 matt finish	Not included (CBAAN)	-	30	500	688	24.8	0.28	1
074011105000	CBAAN	Anchor for Bali waterfall	316	-	2"	-	300	200	4.25	0.018	1
074012105000	CBAE00	Decorative feature CBA500	316 bright polished finish	-	-	-	-	-	2	0.0006	1
074012105001	CBAE01	Decorative feature CBA501	316 matt finish	-	-	-	-	-	2	0.0006	1

CMAU 300 / 500 / 1000

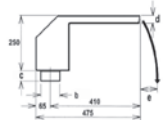
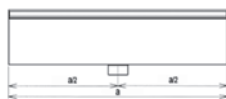

CBAM 351

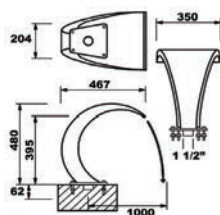

CBA 500/501

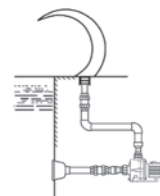

CBAAN

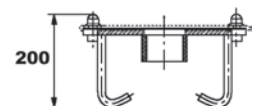
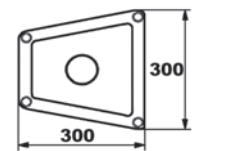



Code	Ref.	Description	Stainless steel	Anchor	Connection	Flow rate m ³ /h	Width mm	Height mm	Weight (kg)	Vol. (m ³)	C.S.U.
07410101000	CCC	Capri cannon with circular nozzle	316	Not required	2-1/2"	20	513	1189	18.3	0.27	1
074101010200	CCP	Capri cannon with flat nozzle	316	Not required	2-1/2"	22	672	1179	20	0.45	1
074101021000	CFBC	Fiji cannon with circular nozzle	316 bright	Not included (CFA)	-	8	906	823	7	0.15	1
074101021100	CFMC	Fiji cannon with circular nozzle	316 matt	Not included (CFA)	-	8	906	823	7	0.15	1
074101022000	CFBP	Fiji cannon with flat nozzle	316 bright	Not included (CFA)	-	8	1043	823	8	0.15	1
074101022100	CFMP	Fiji cannon with flat nozzle	316 matt	Not included (CFA)	-	8	1043	823	8	0.15	1
074103020000	CFA	Anchor for Fiji cannon	316	-	-	-	300	200	3.25	0.018	1
074103010000	CTA	Tahiti cannon	316	Not required	1-1/2" Ø 43	6	482	1100	4.6	0.06	1
074102010100	JABC	Nozzle for Tahiti	316	-	-	-	-	-	0.42	0.003	1
074102010200	JABP1	Nozzle for Tahiti	316	-	-	-	-	-	0.39	0.003	1
074102010400	JABP4	Nozzle for Tahiti	316	-	-	-	-	-	0.5	0.003	1
074102010600	JABC6	Nozzle for Tahiti	316	-	-	-	-	-	0.58	0.003	1

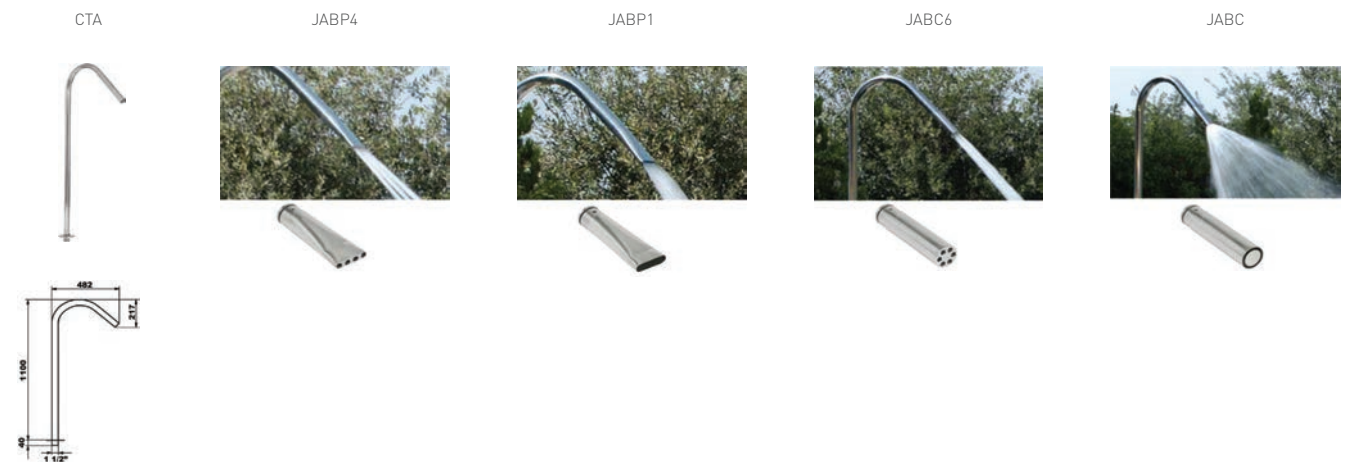

CLEANERS

SIMPLICITY AND EFFICIENCY

We have focused our range of products on simple solutions with proven efficiency: a hydraulic suction cleaner, with a V-Flex® impeller and adjustable vanes to pick up large debris, and for maximum suction whatever the flow rate. In the world of cleaners, Atlantis Evo answers to the most demanding needs, with its selection of functions for cleaning the bottom of the pool, the walls and waterline, using reliable, tried-and-tested technology, free of complications.

CLEANERS

ATLANTIS EVO.....	p.70
ATLANTIS 2X.....	p.71

ATLANTIS EVO

PRO
LINE

YEAR OF
GUARANTEES 2+1[@]

2-IN-1 HIGH PERFORMANCE

- » Cleans only the bottom of your pool, bottom and walls, or the waterline
- » **Simple maintenance. No bag, no hose!**
- » **Fast and simple** cleaning
- » Suitable for concrete, reinforced liner, fibreglass, tiled lining



Code	Ref.	Intake flow rate	Cable	Weight (kg)	C.S.U.
113501030000	ATLANTIS-Evo	17 m ³ /h	17	12.35	1



Technical Specifications

Operation cycles	90 min/4 hours
Economy setting	Quick clean
Motor unit	24 V
Filter surface area	7420 cm ²
Weight	12.35 kg
Speed of movement	16.76 m/min

Technical Specifications

Intake flow rate	17 m ³ /h
Cable	17 m
Autonomous adjustment control	Yes
Electricity supply	220 V - 50-60 Hz
Trolley	Yes
For in-ground pools up to	6 x 12 m

ATLANTIS 2X

PRO
LINE

YEAR OF
GUARANTEES | 4

RELIABLE AND EFFECTIVE

- » Overcomes obstacles thanks to the highly manoeuvrable wheels
- » Anti-blocking system on self-adjusting V-Flex® impeller, capable of picking up very large debris
- » Maximum suction, independent of the flow rate (3 interchangeable throats).
- » Sufficient for a 3/4 hp pump
- » **Optimal** pool cleaning



Code	Ref.	Hose	Weight (kg)	C.S.U.
110910200000	ATLANTIS-2X	10	2.4	1

Technical Specifications

Length of hose	10 m (included)
Pool size	Up to 10 x 5 m
Pool surface area	Concrete, liner, fibreglass and tiled
Pump power (min)	0.5 hp



HEATING

WHY SHOULD YOU INSTALL A HEAT PUMP?

Having a heat pump to heat your pool water means you can enjoy your pool and the moments of relaxation it gives you, for longer, and without worrying about unreliable weather.

Kripsol® heat pumps guarantee a progressive temperature increase and optimal heat conservation: energy consumption is reduced to a strict minimum.

Kripsol Komfort makes your life easier thanks to connectivity: at any time, you can consult the temperature of your pool and modify it if you wish. Even when you are not at home, you can do all this from your smartphone, because now all our heat pumps are equipped with a WiFi module as standard.



HEATING

KOMFORT	p.74
ELECTRIC HEATERS	p.76
HEAT EXCHANGERS	p.77

KOMFORT RC

PRO
LINE

YEAR OF
GUARANTEES | 2

HEAT PUMP FOR SWIMMING POOLS



- » Robust, silent and efficient
- » Reversible heat pump (Heat/Cool/Auto)
- » System defrost by cycle inversion
- » Heating operation given priority
- » Operates at temperatures down to -2 °C
- » Winter cover included
- » Anti-vibration supports (4) and drainage tube (1) included
- » WiFi module included: manage your Komfort RC pump from your smartphone

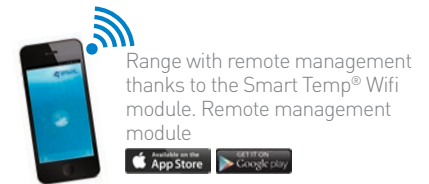

Reference	Komfort RC600	Komfort RC900	Komfort RC1200	Komfort RC1900
Item no.	140606000231	140609000231	140612000231	140619000231
Heat Capacity (kW) Air: 27 °C / Water: 26 °C	5.7	9.2	12.1	18.9
COP Air: 27 °C / Water: 26 °C	5.1	5.9	5.6	5.7
Heat Capacity (kW) Air: 15 °C / Water: 26 °C	4.13	6.3	8.3	12.95
COP Air: 15 °C / Water: 26 °C	4.13	4.31	4.33	4.31
Power consumption (kW)	1	1.47	1.91	3.06
Current consumption (A)	4.6	6.61	8.65	13.06
Water flow (m³/h)	1.8	2.8	3.6	5.3
Power supply	230 V/1/50 Hz	230 V/1/50 Hz	230 V/1/50 Hz	230 V/1/50 Hz
Noise level [dB(A)]	66.9	68.8	69.1	68.8
Sound pressure at 10 m [dB(A)]	35.8	37.6	37.9	37.5
Connection hose [mm]	50	50	50	50
Pool water volume (m³)	30 or less	20 to 40	30 to 60	85 or less
WiFi connection module	•	•	•	•
Number of fans	1	1	1	1
WiFi included, black box	Yes	Yes	Yes	Yes
Smartphone App	Yes	Yes	Yes	Yes
Cabinet colour RAL 7005				



ELECTRIC HEATERS

- » Made of AISI 316 stainless steel
- » Equipped with a pressure switch to detect lack of water
- » Complies with European Directives 92/31/CEE and 93/68/CEE

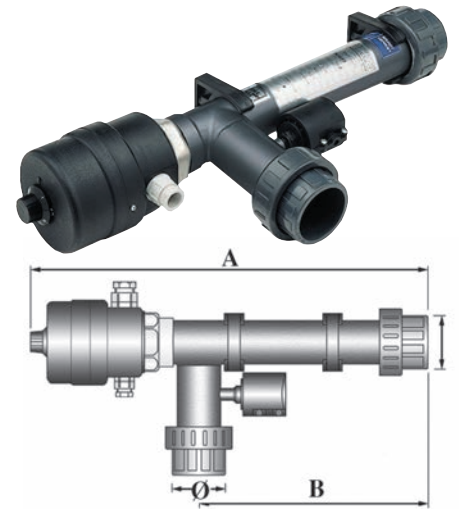

Technical Specifications

Thermostat	Adjustable from 0 °C to 40 °C
Connection	PVC Ø 50 mm
Voltage	3 x 400 V III

Code	Ref.	Power kW	Voltage V	Dimensions (mm)			Weight kg	Vol. (m ³)	qty/box
				A	B	Ø			
141010503300	IM 503	3	230 x 400	490	290	50	2.20	0.014	1
141010506300	IM 506	6	230 X 400	560	360	50	2.20	0.014	1
141010509300	IM 509	9	3 X 400	560	360	50	2.90	0.019	1
141010512300	IM 512	12	3 X 400	650	450	50	2.90	0.019	1
141010518300	IM 518	18	3 X 400	850	650	50	3.80	0.025	1

HEATER COMPONENTS

ELECTRICAL RESISTORS	Code	Ref.	Voltage V	For Heater kW	Weight kg	Vol. (m ³)	qty/box
	141090503300	RIM 3	230 x 400	3	-	-	1
141090506300	RIM 6	230 x 400	6	-	-	1	
141090509300	RIM 9	3 x 400	9	-	-	1	
141090512300	RIM 12	3 x 400	12	-	-	1	
141090518300	RIM 18	3 X 400	18	-	-	1	



PRESSURE SWITCH	Code	Ref.	Connection	For Heater kW	Weight kg	Vol. (m ³)	qty/box
	141091000000	RIM 10	1 / 8"	All	-	-	1



THERMOSTAT	Code	Ref.	Temp. range °C	For Heater kW	Weight kg	Vol. (m ³)	qty/box
	141092000000	RIM 11	0 °C - 40 °C	All	-	-	1

UNION FITTINGS	Code	Ref.	For Heater kW	Weight kg	Vol. (m ³)	qty/box
	141099000003	RIM 20	All	-	-	
	141099000004	RIM 21	All	-	-	
	141099000001	RIM 22	All	-	-	
	141099000002	RIM 23	All	-	-	



HEAT EXCHANGERS

- » Made of AISI 316 stainless steel
- » For higher flow rates, the exchanger will need to be installed on a bypass



Code	Ref.	Power kcal	Power kW	Weight kg	Vol. (m ³)	qty/box
141110048180	IC48 - 18	17 200	20	2.20	0.010	1
141110063380	IC63 - 38	34 400	40	3.40	0.010	1
141110085600	IC85 - 60	60 200	70	7.00	0.032	1
141110117900	IC117 - 90	89 440	104	8.50	0.032	1

Code	Ref.	Capacity kW		Minimum pump performance				Dimensions				
				Primary		Secondary		A	B	C	D	E
		90 / 70 °C	60 / 40 °C	m ³ /h	mWC	m ³ /h	mWC	mm	mm	mm	∅	∅
141110048180	IC48 - 18	20	13	2.00	0.8	10	0.08	275	125	90	3/4"	1 1/2"
141110063380	IC63 - 38	40	28	2.00	1.8	10	0.11	385	125	205	3/4"	1 1/2"
141110085600	IC85 - 60	70	31	3.00	1.5	12	0.15	520	190	290	1"	1 1/2"
141110117900	IC117 - 90	104	55	5.00	2.0	15	0.20	660	190	430	1"	2"

Technical Specifications

Stainless steel	AISI 316
Operating pressure of the primary side	10 bar
Operating pressure of the secondary side	3 bar

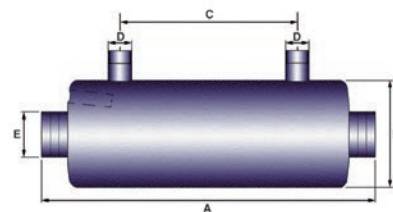

SANITIZATION

PUTTING SWIMMING POOL MANAGEMENT INTO THE PALM OF YOUR HAND

At Kripsol we are taking a big step towards connectivity: KLX Control System.

Accessible and useful information in real time about water parameters that can be managed remotely, programming and control of filters and lighting. And all of this from any smartphone, tablet or computer with an Internet connection. Let's put swimming pool management into the palm of your hand.

SANITIZATION

KLX SYSTEM	p.80
ACCESSORIES	p.82
FLOWMETERS	p.84
METERS.....	p.84

KLX SYSTEM

PRO
LINE

5000
hours
warranty

YEAR OF
GUARANTEES 2+1@

SALT CHLORINATION AND CONTROL FOR RESIDENTIAL POOLS



- » Compact device, IP65, suitable for use in underground technical equipment boxes
- » Graphics display, displays production of Cl^2 and other parameters
- » Wide range of outputs: 8, 16, 22, 33, 50 g/h
- » Salt concentration from 3 g/l up to 100 g/l
- » Timer switch for filtering and lighting (possible for lights up to 50W)
- » Salt level alert
- » Adaptable configuration: extension kits for pH, Rx, Temperature, WiFi
- » Swimming pool management App (requires WiFi module)
- » Controls the speed of KSX Pro VS or KS Evo VS pumps



Graphic display



pH kit including dosing pump



Rx kit



WiFi module

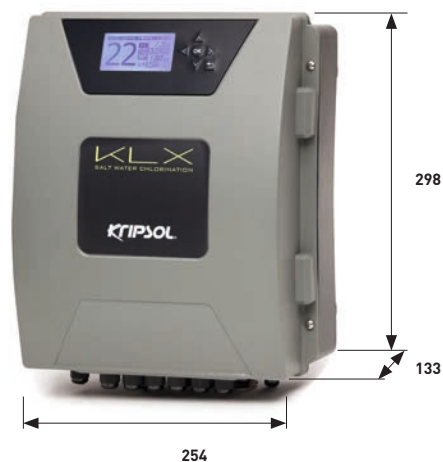

Technical Specifications

	KLX 8	KLX 16	KLX 22	KLX 33	KLX 50
Production in g/h	8	16	22	33	50
Pool size up to m ³	20	50	90	150	200
Salt concentration	3 to 100 g/l				
Display	Graphics display shows present production, cover, pH*, mV*, temp*				
Protection	IP65				
Language selection	●	●	●	●	●
Superchlorination mode	●	●	●	●	●
Manual adjustment of Cl ₂	●	●	●	●	●
Auto-adjustment of Cl ₂ *	●	●	●	●	●
pH* management	●	●	●	●	●
Lighting management (supply up to 50 W)	●	●	●	●	●
Filter pump management	●	●	●	●	●
KSX Pro VS/KS Evo VS** management	●	●	●	●	●
Function cover/adapted production of Cl ₂	●	●	●	●	●
Smart mode: adjustment of Cl ₂	●	●	●	●	●
Gas detector	●	●	●	●	●
Self-cleaning	Programmable up to 999 min				
Alarms	Low salt / no flow / pH				
	Extension kits				
pH (with pump)	●	●	●	●	●
Rx	●	●	●	●	●
WiFi	●	●	●	●	●
Smartphone management App	●	●	●	●	●
Flow switch	●	●	●	●	●
	Control box dimensions				
	254 x 298 x 133				

* When the extension kit is connected

** When acquired in conjunction with KSX Pro / KS Evo VSD
Flow switch included in KLX 50 in place of a gas detector

Code	Ref.	Production	Connection	Pool size up to m ³	Includes	Weight (kg)	Vol. (m ³)	C.S.U.
091010080000	KLX 8	8	63 mm	20	Control unit + cell	-	-	1
091010160000	KLX 16	16	63 mm	50	Control unit + cell	-	-	1
091010220000	KLX 22	22	63 mm	90	Control unit + cell	-	-	1
091010330000	KLX 33	33	63 mm	150	Control unit + cell	-	-	1
091010500000	KLX 50	50	63 mm	200	Control unit + cell	-	-	1
091019000002	pH kit	-	50/63 mm	-	Chip + Probe + probe holder + pump + cable gland	-	-	1
091019000001	Rx kit	-	50/63 mm	-	Chip + Probe + probe holder	-	-	1
091019000003	WiFi module	-	RS485-Modbus	-	Transmitter + App	-	-	1
091019000004	Temp. sensor	-	-	-	Sensor + housing + cable gland	-	-	1
091019000005	Flow switch	-	-	-	Flow switch + housing + cable gland	-	-	1

DOSAGE



RAL

RAL

- » Constant dosing pump
- » Double ball valve in PVDF
- » Valves integrated into the dosing head
- » PVDF dosing head
- » Box in plastic material (PVDF)
- » Protection class IP65
- » Adjustment of the flow rate (0 - 100%) and double adjustment (0 - 20%)
- » Protection cover for controls
- » Injection fitting with double ball valve and spring
- » Includes pulse adjuster
- » Includes level probe

COMPACT EQUIPMENT FOR MEASUREMENTS AND AUTOMATIC DOSING

RPR, for pH or Redox (ORP)

Pump with proportional flow rate for measurement and adjustment of pH (range 0 - 14) or Redox (range 0 - 1.000mV.), with monitoring of levels and start/stop function by remote management. LEVEL PROBES INCLUDED.

Readings indicated on an LCD screen

Valves integrated into the dosing head. Dosing head in PVDF. Casing made of plastic (PVDF).



RPR

PBEK for pH

Pump with proportional flow rate for measurement and adjustment of pH (range 0 - 14) with monitoring of levels and start/stop function by remote management

Readings indicated on an LCD screen

Casing made of plastic(PVDF) including:

- » pH electrode
- » Electrode holder with 1/2" thread for piping
- » Calibration solutions
- » Level probe (pump stops due to lack of input)
- » Includes collar



PBEK

Code	Reference	Flow rate (l/h)	Pressure (bar)	Weight (kg)	Vol. (m ³)	Qty/box
090110260300	RAL 603	6	8	2	0.0139	1
090110280000	RAL 800	10	10	2	0.0139	1
090110280300	RAL 803	20	5	2	0.0139	1
090110360300	RPR 603	5	10	2	0.0139	1
090230010000	PBEK	1.5	1.5	2.5	0.0139	

KITS FOR RPR PUMPS

pH kit includes:

- » pH electrode with 6 m cable
- » pH7 and pH4 calibration solutions

ORP kit includes:

- » Redox electrode with 6m cable
- » 465 mV calibration solution

Code	Description
090199000003	pH Kit
090199000002	Redox Kit (ORP)

ACCESSORIES

DOSING STORAGE CONTAINERS

Code	Ref.	Capacity l.	Weight (kg)	Vol. (m ³)	C.S.U.
099500500000	DD 50	50	3	0.055	1
099501000000	DD 100	100	5	0.1	1
099502500000	DD 250	230	10	0.2	1
099503500000	DD 350	335	-	-	1



PH, REDOX AND REFERENCE ELECTRODES

090402000002	EL-PH BLUE PHA ELECTRODE
090403000002	EL-RX YELLOW REDOX ELECTRODE
090406000002	EL-E REFERENCE ELECTRODE KIT



EL-E.A



EL-PH

FLOWMETERS

- » Simple installation
- » A single piece of transparent methacrylate
- » AISI 316 float level sensor
- » Scale engraved onto the material
- » Precision +/-8%
- » Temperature 80 °C
- » Pressure 10 bar
- » Two options possible: horizontal models (CH) and vertical models (CV)



Code	Ref.	Pitot tube Ø mm	Piping Ø	Flow rate m³/h		Weight (kg)	Vol. (m³)	qty/box	€/unit
				MIN	MAX				
214001015000	CH 15	15	50	50	350	0,3	0,0002	1	-
214001020000	CH 20	15	63	100	475	0,3	0,0002	1	-
214001025000	CH 25	15	75	150	700	0,3	0,0002	1	-
214001030000	CH 30	15	90	200	850	0,3	0,0002	1	-
214001040000	CH 40	15	110	600	1800	0,4	0,0003	1	-
214001060000	CH 60	20	160	900	3200	0,4	0,0003	1	-
214001080000	CH 80	20	200	1500	5100	0,5	0,0003	1	-
214002015000	CV 15	15	50	100	450	0,3	0,0002	1	-
214002020000	CV 20	15	63	175	675	0,3	0,0002	1	-

METERS

MULTI-JET WATER METERS

- » Nominal flow rates from 1.5 to 10 m³/h
- » Measurement class B. Magnetic transmission
- » CE certified
- » Cold water 40 °C and hot water 90 °C
- » Maximum pressure 16 bar
- » Horizontal installation
- » Includes connectors
- » Possible to integrate a reed switch pulse emitter, compatible with any remote reading system



Code	Ref.	Connection Ø	Nominal flow rate m³/h	Flow rate m³/h		Weight (kg)	Vol. (m³)	qty/box	€/unit
				MIN	MAX				
214101020000	CA 20	3/4"	-	-	-	-	-	1	-
214101025000	CA 25	1"	3.5	0.07	7	1.5	0.0022	1	-
214101030000	CA 30	1 1/4"	6	0.10	12	2	0.0035	1	-
214101040000	CA 40	1 1/2"	10	0.20	20	2.1	0.0035	1	-
214101020001	EIA	Reed switch pulse emitter						1	-

TANGENTIAL IMPELLER WATER METERS

Protected by epoxy coating The totaliser is a dry dial protected by a casing and a sealable brass lid. Possible to integrate a reed switch pulse emitter, compatible with any remote reading system

- » Nominal flow rates from 15 to 400 m³/h
- » Diameters from 50 to 300 mm
- » Horizontal or vertical installation
- » For cold water up to 50 °C
- » Maximum pressure 16 bar
- » Measurement class A



Code	Ref.	Connection Ø	Length mm	Flow rate m ³ /h		Weight (kg)	Vol. (m ³)	qty/box	€/unit
				MIN	MAX				
214102020000	CP 20	50 / 2"	200	1.2	30	11	0.0013	1	-
214102025000	CP 25	65 / 2 1/2"	200	2	50	13	0.0031	1	-
214102030000	CP 30	80 / 3"	225	3.2	80	15	0.0045	1	-
214102040000	CP 40	100 / 4"	250	4.8	120	19	0.0065	1	-
214102050000	CP 50	125 / 5"	250	8	200	24	0.0085	1	-
214102060000	CP 60	150 / 6"	300	12	300	30	0.013	1	-
214102080000	CP 80	200 / 8"	350	20	500	48	0.022	1	-
214102020001	EIP	Reed switch pulse emitter						1	-

WOLTMANN METERS

- » Nominal flow rates from 50 to 1000 m³/h
- » Diameters from 50 to 300 mm
- » Installed horizontally or vertically or at an angle
- » CE certified
- » Measurement class B
- » For cold water up to 50 °C
- » Maximum pressure 16 bar
- » Possible to integrate a reed switch pulse emitter, compatible with any remote reading system
- » Direct totalising on numbered counters



Code	Ref.	Connection Ø	Length mm	Flow rate m ³ /h		Weight (kg)	Vol. (m ³)	qty/box	€/unit
				MIN	MAX				
214103020000	CW 20	50 / 2"	200	0.45	30	10.2	0.0073	1	-
214103025000	CW 25	65 / 2 1/2"	200	0.75	50	11.2	0.0084	1	-
214103030000	CW 30	80 / 3"	225	1.2	80	14.1	0.0099	1	-
214103040000	CW 40	100 / 4"	250	1.8	120	19.4	0.0147	1	-
214103050000	CW 50	125 / 5"	250	3	200	20.5	0.017	1	-
214103060000	CW 60	150 / 6"	300	4.5	300	32.5	0.0287	1	-
214103080000	CW 80	200 / 8"	350	7.5	500	45	0.0461	1	-
214103020001	EIW	Reed switch pulse emitter						1	-

PVC ACCESSORIES

ADD THE FINISHING TOUCH TO YOUR POOL INSTALLATION

In this chapter you will find valves, elbows, reducers, 'tee' connections and everything you need to complete the assembly of your Kripsol pool.

PVC ACCESSORIES

PVC ACCESSORIES..... p.88

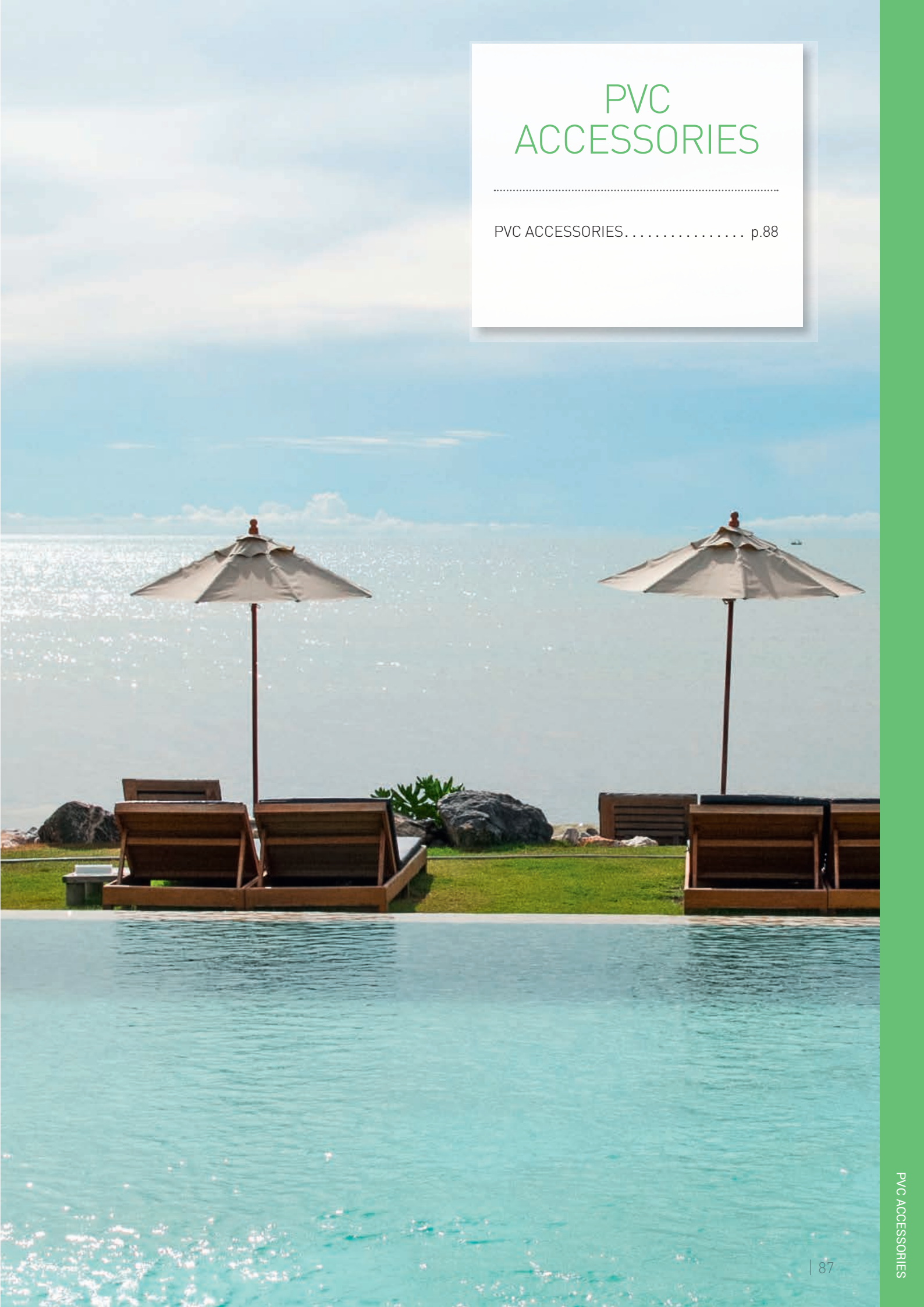

PVC ACCESSORIES

SLIP RANGE

Code	Ref.	Description	Connection Ø	Angle	Weight kg	Vol. (m3)	Qty Box	
100171010400	CD901040	CD901040 ELBOW 90° 40 mm	40	90°	9.2	0.031	100	
100171010500	CD901050	CD901050 ELBOW 90° 50 mm	50	90°	10.1	0.031	60	
100171010630	CD901063	CD901063 ELBOW 90° 63 mm	63	90°	7.0	0.031	30	
100171020400	CD451040	CD451040 ELBOW 45° 40 mm	40	45°	9.0	0.031	120	
100171020500	CD451050	CD451050 ELBOW 45° 50 mm	50	45°	9.9	0.031	70	
100171020630	CD451063	CD451063 ELBOW 45° 63 MM	63	45°	8.0	0.031	40	
100171015500	CD911550	CD911550 ELBOW 90° SWEEP M/F 50 mm	50	90°	15.3	0.048	100	
100171015630	CD911563	CD911563 ELBOW 90° SWEEP M/F 63 MM	63	90°	16.7	0.048	60	
100171025500	CD461550	CD461550 ELBOW 45° SWEEP M/F 50 mm	50	45°	16.2	0.048	120	
100171025630	CD461563	CD461563 ELBOW 45° SWEEP M/F 63 MM	63	45°	14.9	0.048	60	
100171030400	TE901040	TE901040 TEE 90° 40 mm	40	90°	9.2	0.031	70	
100171030500	TE901050	TE901050 TEE 90° 50 MM	50	90°	9.8	0.031	40	
100171030630	TE901063	TE901063 TEE 90° 63 mm	63	90°	6.8	0.031	20	
100171090500	CZ1050	CZ1050 CROSS 50 MM	50	90°	7.4	0.031	30	
100171090630	CZ1063	CZ1063 CROSS 63 mm	63	90°	6.7	0.031	15	
100171050400	MU1040	MU1040C COUPLING 40 MM	40	-	9.8	0.031	180	
100171050500	MU1050	MU1050 COUPLING 50 mm	50	-	8.8	0.031	100	
100171050630	MU1063	MU1063 COUPLING 63 MM	63	-	8.7	0.031	60	
100171060420	CR1042	CR1042 REDUCER 40/32 mm	40 X 32	-	10.1	0.031	500	
100171060510	CR1051	CR1051 REDUCER 50/25 MM	50 X 25	-	15.7	0.031	--	
100171060530	CR1053	CR1053 REDUCER 50/40 mm	50 X 40	-	16.3	0.031	300	
100171060650	CR1065	CR1065 REDUCER 63/50 MM	63 X 50	-	13.8	0.031	160	
100171070400	TP1040	TP1040 CAPS 40 mm	40	-	-	0.031	-	
100171070500	TP1050	TP1050 CAPS 50 MM	50	-	14.9	0.031	200	
100171070630	TP1063	TP1063 CAPS 63 mm	63	-	10.5	0.031	100	
100474140400	EH1040	EH1040 UNION F/F SLIP 40 MM	40	-	16.1	0.048	100	
100474140500	EH1050	EH1050 UNION 50 mm	50	-	30.3	0.048	100	
100474140630	EH1063	EH1063 UNION 63 MM	63	-	27.6	0.048	72	
100474090500	EHS1050	EHS1050 UNION. F/M Slip 50 mm	50	-	19.1	0.048	75	
100474090630	EHS1063	EHS1063 UNION. F/M SLIP 63 MM	63	-	19.4	0.048	50	

These products are supplied in full boxes, refer to quantities.

PVC ACCESSORIES

MIXED RANGE (SLIP/THREADED)

Code	Ref.	Description	Connection Ø	Angle	Weight kg	Vol. (m3)	Qty Box	
100173010400	CD903040	CD903040 ELBOW 90° 40-1.1/4"	40 x 1 1/4"	90°	9.8	0.031	100	
100173010500	CD903050	CD903050 ELBOW 90° 50-1.1/2"	50 X 1 1/2"	90°	11.3	0.031	60	
100173010630	CD903063	CD903063 ELBOW 90° 63-2"	63 X 2"	90°	12.7	0.031	40	
100173015500	CD913550	CD913550 ELBOW 90° M/F 50 - 1 1/2"	50 X 1 1/2"	90°	19.1	0.031	100	
100173050400	MU3040	MU3040 MIXED COUPLING 40-1.1/4"	40 X 1 1/4"	-	10	0.015	150	
100173050500	MU3050	MU3050 MIXED COUPLING 50 -1.1/2"	50 X 1 1/2"	-	12.8	0.03	110	
100173050630	MU3063	MU3063 MIXED COUPLING 63/2"	63 X 2"	-	11.1	0.03	60	
100173070320	MR3040	MR3040 COUPLING M/THREAD.32/40-1.1/4M"	32 - 40 X 1 1/4"	-	5.5	0.031	96	
100173070400	MR3050	MR3050 COUPLING M/Thread.40/50-1.1/2"	40 - 50 X 1 1/2"	-	13.5	0.031	130	
100173070500	MR3063	MR3063 COUPLING M/THREAD. 50/63-2"	50 - 63 X 2"	-	11.5	0.031	72	
100173030400	TE903040	TE903040 TEE 90° MIXED 40-1.1/4"	40 X 1 1/4" X 40	90°	9.2	0.031	70	
100173030500	TE903050	TE903050 TEE 90° MIXED 50-1.1/2"	50 X 1 1/2" X 50	90°	11.1	0.031	50	
100173030630	TE903063	TE903063 TEE 90° MIXED 63-2"	63 X 2" X 63	90°	10.3	0.031	25	
100173080400	TRM3040	TRM3040 MALE THREADED ADAPTER 40/50-1.1/4"	40 - 50 X 1 1/4"	-	11.3	0.031	70	
100173080500	TRM3050	TRM3050 MALE THREADED ADAPTER 50 63-1.1/2"	50 - 63 X 1 1/2"	-	9.1	0.031	60	
100173080630	TRM3063	TRM3063 MALE THREADED ADAPTER 63/75-2"	63 - 75 X 2"	-	11.9	0.031	72	
100474030500	EH3050	EH3050 UNION F/F 50-1.1/2"	50 X 1 1/2"	-	20.5	0.048	72	
100474030630	EH3063	EH3063 UNION F/F 63-2"	63 X 2"	-	24.8	0.048	60	
100474070500	EHR3050	EHR3050 UNION F/Slip-M/Thread. RD.50-2"	50 X 2"	-	17.7	0.048	60	
100474040500	EHM3050	EHM3050 UNION. 50-1.1/2M"	50 X 1 1/2"	-	15.5	0.03	75	
100474040630	EHM3063	EHM3063 UNION. 63-2M"	63 X 2"	-	15.2	0.048	50	
100474050500	EHM2050	EHM2050 UNION W/O-RING.50-1.1/2"	50 X 1 1/2"	-	6.6	0.03	50	
100474050630	EHM2063	EHM2063 UNION w/o-ring. 63-2"	63 X 2"	-	15.9	0.048	72	

These products are supplied in full boxes, refer to quantities.

PVC ACCESSORIES

Code	Ref.	Description	Connection Ø	Weight kg	Vol. (m3)	Qty Box
SLIP						
101011100200	VET20	VET20 BALL VALVE 20 mm TEFLON	20	-	-	-
101011100250	VET25	VET25 BALL VALVE 25 mm TEFLON	25	9.4	0.034	48
101011100320	VET32	VET32 BALL VALVE 32 mm TEFLON	32	9.5	0.061	30
101011100400	VET40	VET40 BALL VALVE 40 mm TEFLON	40	16.4	0.061	36
101011100500	VET50	VET50 BALL VALVE 50 mm TEFLON	50	18.6	0.061	24
101011100630	VET63	VET63 BALL VALVE 63 MM TEFLON	63	17.9	0.061	16
101011100750	VET75	VET75 BALL VALVE 75 mm TEFLON	75	15.4	0.061	6
101011100900	VET90	VET90 BALL VALVE 90 MM TEFLON	90	15.4	0.061	3
101011110250	VEP25	VEP25 BALL VALVE 25 mm	25	7.9	0.031	40
101011110320	VEP32	VEP32 BALL VALVE 32 MM	32	12.7	0.031	40
101011110400	VEP40	VEP40 BALL VALVE 40 mm	40	7.3	0.031	16
101011110500	VEP50	VEP50 BALL VALVE 50 MM	50	12.4	0.031	16
101011110630	VEP63	VEP63 BALL VALVE 63 mm	63	11.2	0.031	10
101011110750	VEP75	VEP75 BALL VALVE 75 MM	75	8.8	0.031	3
101011110900	VEP90	VEP90 BALL VALVE 90 mm	90	8.8	0.031	3
THREADED						
101012110250	VRP25	VRP25 BALL VALVE 3/4"	3/4"	7.9	0.031	40
101012110320	VRP32	VRP32 BALL VALVE 1"	1"	12.7	0.031	40
101012110400	VRP40	VRP40 BALL VALVE 1.1/4"	1 1/4"	7.3	0.031	16
101012110500	VRP50	VRP50 BALL VALVE 1.1/2"	1 1/2"	12.4	0.031	16
101012110630	VRP63	VRP63 BALL VALVE 2"	2"	11.2	0.031	10
101012110750	VRP75	VRP75 BALL VALVE 2.1/2"	2 1/2"	8.8	0.031	3
101012110900	VRP90	VRP90 BALL VALVE 3"	3"	8.8	0.031	3



PVC ACCESSORIES

Code	Ref.	Description	Connection Ø	Attachment	Weight kg	Vol. (m3)	Qty Box	
101013500500	VAR1050	VAR1050 CHECK VALVE ø 50	50	Slip	11.80	0.061	24	
101013500630	VAR1063	VAR1063 CHECK VALV. 63 mm EPDM	63	Slip	11.30	0.061	16	
101013500750	VAR1075	VAR1075 CHECK VALV. 75 mm EPDM	75	Slip	8.00	0.048	6	
101013600500	VAR2050	VAR2050 CHECK VALV. 1.1/2 EPDM"	1 1/2"	Threaded	11.70	0.061	24	
101013600630	VAR2063	VAR2063 CHECK VALVE 2 EPDM"	2"	Threaded	11.30	0.061	16	
101014600500	VP2050	VP2050 FOOT VALVE 1.1/2 EPDM"	1 1/2"	Threaded	6.00	0.048	12	
101014600630	VP2063	VP2063 FOOT VALVE 2 EPDM"	2"	Threaded	8.60	0.048	12	
900281250000	CTV50	CTV50 BLIND CAP FOR INTAKE COLLECTOR	50	-	0.65	0.001	1	
100172040500	MDR2050	MDR2050 DOUBLE THREADED NIPPLE 1.1/2"	1 1/2"	-	4.70	0.031	70	
100172040630	MDR2063	MDR2063 DOUBLE THREADED NIPPLE 2"	2"	-	5.70	0.031	96	

Code	Ref.	Description	Width	Length	Weight kg	Vol. (m3)	Qty Box	
108812000000	CTF12	CTF12 TEFLON ROLL 12 mm x 12 m	12	12	2.60	0.016	200	

Code	Ref.	Description	Quantity cc	Weight kg	Vol. (m3)	Qty Box	
100500000001	LA100	LA1000 PVC ADHESIVE CONTAINER 1000 cc	1000	13.3	0.02	12	
100500000003	LD100	LD1000 SOLVENT CONTAINER 1000 CC	1000	13.3	0.02	12	

Code	Ref.	Description	Piping Ø mm	Quantity	Weight kg	Vol. (m3)	Qty Box	
310205000000	TPF50	TPF50 FLEXIBLE PVC HOSE 50 mm (50 m roll)	50	50 m	36.00	-	1	
310206300000	TPF63	TPF63 FLEXIBLE PVC HOSE 63 MM (50 M ROLL)	63	50 M	60.00	-	1	

These products are supplied in complete boxes, refer to quantities.

GENERAL CONDITIONS OF SALE

ART. 1/ SCOPE OF APPLICATION

Unless agreed otherwise, these conditions apply to all products sold by HAYWARD Iberica S.L.U. to its customers, whether or not those conditions are included in the catalogue.

ART. 2/ ORDERS

In order to avoid errors and provide a better service, orders must be made in writing using the descriptions and references that appear in our catalogue or price list. The seller's prior confirmation is required before orders are considered to be accepted.

ART. 3/ PRICE AND PAYMENT METHOD

The agreed prices are always understood to be for items (including packaging) located in our warehouses "EX WORKS as per INCOTERMS 2010", with all taxes, charges and expenses to be paid by the buyer. The prices included in the price list are recommended retail prices, which the company reserves the right to modify without prior notice.

Payment shall be made in cash. If another payment method is agreed, the promissory notes and other bills of exchange issued for acceptance must be returned to us with the corresponding acceptance within a period of 15 days from the invoice issue date. Any delay in payment or in accepting the bills shall give rise to late payment interest of 2% per month from the due date without the need for further demands for payment. Any amendment to the payment date or method must be authorised in writing by the seller. If another payment method is agreed, any failure to pay amounts due by the due date shall entitle the seller to bring forward the due date of the entire outstanding debt, thus rendering the full amount payable, to halt the delivery of any items yet to be delivered and to allocate any amount received from the customer towards the debt and towards any interest and compensation for harm caused. The customer shall repay the seller any bank charges and legal expenses arising from the rejection of bills of exchange by way of damages.

ART. 4/ DELIVERY AND TRANSPORTATION

The date and place of delivery are systematically the date and place when and where our goods are made available at our warehouses [Ex Works]. The delivery dates communicated are for guidance only and the buyer expressly agrees that it will not take any action to which it may be entitled as a result of any delay, unless it has entered into a prior express written agreement to the contrary which specifies both the delivery date and the consequences of non-performance in this respect. Goods shall always be carried on behalf of the buyer and at the buyer's risk, including prepaid freight. If, during the maximum period of one week following notification of product availability, the customer fails to reply in order to arrange delivery, the handover obligation shall be considered fulfilled, at which point any risk associated with the goods shall be transferred to the buyer. Time periods for bringing actions for protection against hidden defects or actions under warranty shall commence from the date the goods are made available.

ART. 5/ RETENTION OF TITLE

The seller shall retain title in the goods until the price of the goods has been fully paid within the agreed time period and may take back such goods until payment has been made without the need for any prior court order. The risks associated with the goods shall pass to the buyer once the goods have been made available to it, its agents or carriers and, as such, the buyer shall be liable for any impairment or damage. The seller reserves the right to cancel any transaction in the event of non-payment or late payment, or if the goods are not collected within a period of 15 days after they have been made available, or if the buyer is subject to any enforcement or insolvency proceedings, regardless of any claims for damages or expenses incurred in the collection of the goods.

ART. 6/ WARRANTY

Our products are under warranty for two years starting from the invoice date, with the exception of fire-fighting equipment, pressure boosters and electric pumps, which are under warranty for one year starting from the time they are commissioned and with a maximum validity of 18 months from the date the customer is invoiced for the equipment, unless otherwise agreed in the corresponding sale or specific warranty document. We undertake to respond to warranty claims from our own customers, but not from third parties. The warranty covers only repairs or the replacement of defective parts at our facilities or at an authorised Technical Assistance Centre and does not include the cost of transporting the item at issue to our repair workshop or any costs associated with travel or with replacement of the item. Replaced parts are subject to their own warranty, which does not impact on the original product warranty. The warranty shall not be effective if the buyer fails to communicate the warranty issue in due form and time, enclosing with the product the invoice, a delivery note specifying the date of delivery if the serial number, where applicable, is illegible and a description of the defect observed.

The product may be exempt from the warranty if it has been incorrectly stored, installed, commissioned or maintained, or if it has been repaired or handled by an unauthorised individual or fitted with non-original parts. Similarly, the warranty does not cover any damage or impairment caused by use or affecting expendable or consumable materials or due to electrical disturbances or force majeure.

ART. 7/ CLAIMS, CANCELATIONS AND RETURNS

Orders that have been fully or partially accepted may not be terminated or cancelled without the seller's approval. If they are terminated or cancelled without the seller's approval the buyer must pay compensation amounting to 50% of the goods affected, regardless of any damage caused.

If a product is alleged to be defective, returns or claims for visible defects shall only be accepted within three days of receiving the goods. In order to improve the service, if the defect is clearly visible or if the packaging has been damaged in some way, in order for the return or claim to be accepted the addressee must make a note of the damage observed on the carrier's delivery note and send us a copy of it, along with a copy of the written communication sent to the carrier indicating the defects observed.

Only defective products can be returned. Any such items returned must be sent by prepaid freight in the original packaging, with the return noted on a delivery note and a document indicating the reasons for return, serial number (if there is one), invoice number and the order and the initial delivery dates.

ART. 8/ JURISDICTION AND APPLICABLE LAW

Any dispute between the parties shall be submitted to the exclusive jurisdiction of the Courts where the seller has its head office.

The company is not liable for any inaccuracies in this price list due to printing or transcription errors and reserves the right to amend the products or this document as it deems necessary without giving prior notice. The pictures, images and text included in our leaflets and advertising material are for guidance only. They are not considered to be contractually binding and may be modified without prior notice.

THE FILTRATION SPECIALIST EXTENDS ITS OFFER

www.kripsol.com



FILTERS



HEATING



SANITIZATION



PUMPS

KRIPSOL®



2018 - Image: KRIPSOL® / Fotolia / Javier de Agustín - ipe - ADCATKR2018EN



P.I.Villa de Yuncos - C/ Felipe II, Nave 136
45210 Yuncos, Toledo - SPAIN
Tel. +34 925 533 025 - Fax +34 925 533 275 - www.kripsol.com